

REFERENCES WHEELS

| | | | |
|--------|--------------------------------|--------|-----------------------------|
| 128082 | DEEMAX ULTIMATE 012 PR9/12x135 | 129521 | DEEMAX ULTIMATE 012 FRT20mm |
| 129523 | DEEMAX ULTIMATE 012 PR12x150 | | |

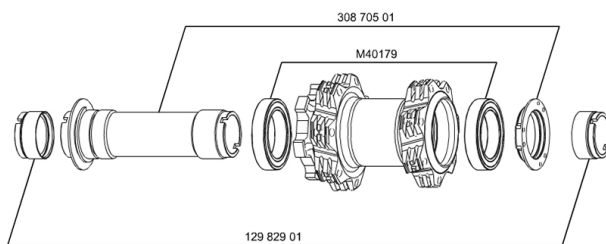

RIMS



&NBSP;:

99691910 KIT FRONT RIM DEEMAX ULTIMATE YELLOW

SPOKES

30863801 KIT 14 FT M7/7 DEEMAX ULTIMATE 12 SPK 271mm

HUB SHELLS

30870501 FRONT AXLE 20mm CROSSMAX + DEEMAX ULTI 2012
M40179 FRONT BEARING 25x37x7 20mm AXLE

ADAPTERS

12982901 ADAPTER Ft 20x110mm

MAVIC Deemax Ultimate

DELIVERED WITH

| | |
|---------------------------------|--|
| UST valve and accessories | |
| UST valve and accessories | |
| Rear QR adapters | |
| Rear QR adapters | |
| Multifonction adjustment wrench | |
| Multifonction adjustment wrench | |
| User guide | |
| User guide | |

Specifications

RIMS

- **Material** : Mxstal
- **Material** : Mxstal
- **Color** : yellow
- **Joint** : SUP
- **Joint** : SUP
- **Drilling** : Fore
- **Drilling** : Fore

Disc brake specific profile

- **Weight reduction** : ISM with central spine
- **Valve hole diameter** : 6.5 mm

Disc brake specific profile

- **Weight reduction** : ISM with central spine
- **Tyre** : UST Tubeless and tubetype
- **Valve hole diameter** : 6.5 mm
- **Internal width** : 21 mm
- **Graphisms** : hot stamped
- **ETRTO size** : 559x21C
- **Tyre** : UST Tubeless and tubetype
- **Internal width** : 21 mm
- **ETRTO size** : 559x21C
- **Recommended tyre sizes** : 2.0 to 2.5
- **Recommended tyre sizes** : 2.0 to 2.5

SPOKES

- **Material** : steel
- **Material** : steel
- **Shape** : straight pull, bladed
- **Shape** : straight pull, bladed
- **Color** : black
- **Nipples** : integrated M7 aluminum with brake rings
- **Nipples** : integrated M7 aluminum with brake rings
- **Count** : front 28, rear 32
- **Lacing** : front and rear crossed 3
- **Count** : front 28, rear 32
- **Lacing** : front and rear crossed 3

WHEEL HUB

- **Front and rear bodies** : aluminum
- **Front and rear bodies** : aluminum with Spoke Retention System (SRS special machining to avoid spoke ejection)
- **Front and rear axle material** : aluminum
- **Color** : yellow
- QRM+
- **Front and rear axle material** : aluminum
- ITS-4 alloy
- QRM+
- ITS-4 alloy

WHEEL WEIGHTS

Wheel weight 910