

REFERENCES WHEELS

325653 COSMIC CARB SLE 013 FRT WTS

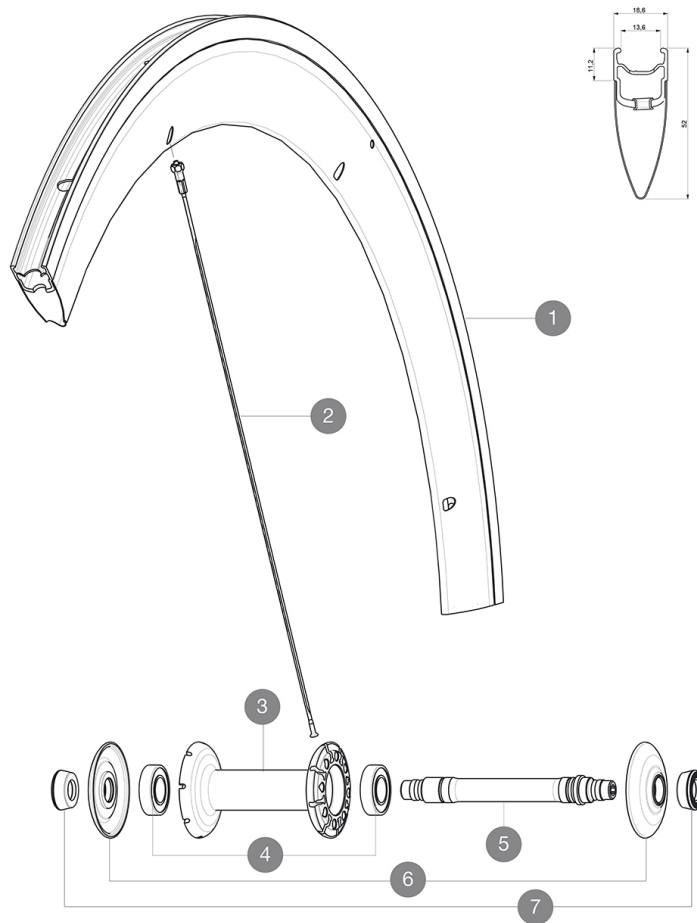

RIMS



&NBSP;:

1 30972410 KIT FRONT COSMIC CARBONE SLE 2013 RIM

SPOKES

2 36644501 KIT 10 FT/NDS COSMIC CARBON SLS BLK SPK 289mm

HUB SHELLS

4 M40078 FRONT HUB BEARINGS 6901 x 2
5 30870001 FRONT AXLE ROAD RIM BRAKING QRM +
6 32985701 HUB CAP & ADJUSTING NUT CXR 80

ADAPTERS

7 35117301 FT/RR FORK REST R-SYS/CC ULTIMATE > 2013/KSY PRO CARB T

MAVIC Cosmic Carbone SLE

DELIVERED WITH

BR601 quick releases	
BR601 quick releases	
Wheelbags	
Wheelbags	
Exalith brake pads	
Exalith brake pads	
Valve extender	
Multifunction adjustment wrench	
Multifunction adjustment wrench	
User guide	
User guide	

Specifications

RIMS

- **Material** : Maxtal and 12K carbon fiber
- **Material** : Maxtal and 12K carbon fiber
- **Height** : 52 mm
- **Color** : carbon
- **Height** : 52 mm
- **Joint** : SUP
- **Drilling** : traditional
- **Joint** : SUP
- **Drilling** : traditional
- **Brake track** : Exalith 2
- **Weight reduction** : ISM
- **Eyelet** : single
- **Valve hole diameter** : 6.5 mm
- **Brake track** : Exalith 2
- **Weight reduction** : ISM
- **Tyre** : clincher
- **Valve hole diameter** : 6.5 mm
- **Tyre** : clincher
- **ETRTO size** : 622x13C
- **ETRTO size** : 622x13C
- **Recommended tyre sizes** : 19 to 28 mm
- **Recommended tyre sizes** : 19 to 28 mm

SPOKES

- **Material** : steel
- **Material** : steel
- **Shape** : straight pull, bladed, double butted
- **Shape** : straight pull, bladed, double butted
- **Color** : black
- **Nipples** : APC front aluminum, rear brass

WHEEL HUB

- **Front and rear bodies** : aluminum
- **Front and rear bodies** : aluminum
- **Color** : black
- **Front and rear axle material** : aluminum QRM+
- **Front and rear axle material** : aluminum FTS-L steel
- **Front and rear axle material** : aluminum QRM+
- **Front and rear axle material** : aluminum FTS-L steel

WHEEL WEIGHTS

Wheel weight 730