

MAVIC *E-XA Elite 29*

ASTM CATEGORY 3 : CROSS COUNTRY AND TRAIL RIDING

For a longer longevity of the wheel, Mavic recommends that the total weight supported by the wheels don't exceed 120kg, bike included

Recommended tyre sizes: 46mm to 64mm (1.8" to 2.5")

REFERENCES WHEELS

F80341 E-Xa Elite 29 Ft Bst

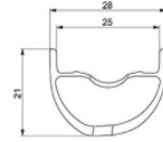
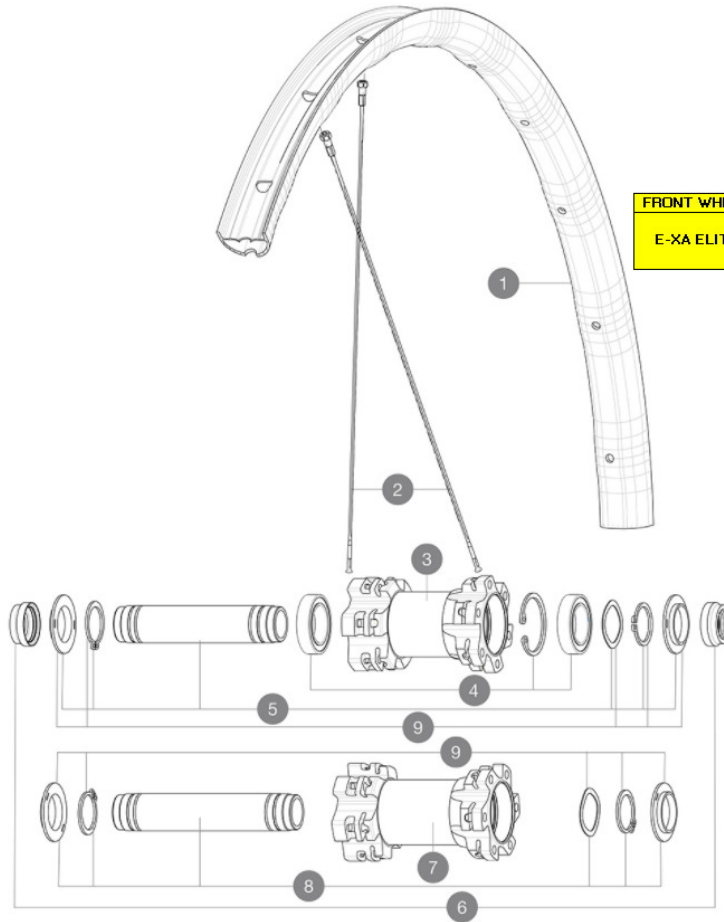

| FRONT WHEEL | N° | PARTS | REFERENCE | REFERENCE BOOST |
|-------------|-------------|----------|-----------|-----------------|
| E-XA ELITE | 3BIS / 7BIS | HUB BODY | N/A | N/A |
| | 5BIS / 8BIS | AXLE | V2372301 | V2372401 |
| | 6 BIS | ADAPTORS | | V2372501 |

RIMS

&nbsp;:

| | | |
|---|----------------------|---|
| 1 | V2990115 V2700101 | KIT FT/RR RIM XA ELITE 29" 25mm BLACK TSS UST Tape 28mm for 25 to 27mm wide rims |
|---|----------------------|---|

SPOKES

| | | |
|---|----------|--|
| 2 | V2381401 | KIT 12 FT/RR BUTTED SPOKES 296mm MTB 29" |
|---|----------|--|

HUB SHELLS

| | | |
|---|----------|---|
| 3 | N/A | HUB BODY |
| | N/A | HUB BODY |
| 4 | 99688501 | BEARING KIT 9/12/15 D6T HUB 20x32x7 6804 |
| 5 | V2371901 | KIT FRONT AXLE MTB L1 QRM AUTO 15x100mm |
| | V2372301 | KIT 100mm AXLE QRM AUTO MTB > 2019 |
| 7 | N/A | HUB BODY |
| | N/A | HUB BODY |
| 8 | V2372001 | KIT FRONT AXLE MTB L1 QRM AUTO BOOST 15x110mm |
| | V2372401 | KIT 110mm AXLE QRM AUTO MTB > 2019 |
| 9 | V2372701 | QRM AUTO FRONT AXLE ASSEMBLY KIT > 2018 |

OPTIONS

| | |
|----------|-------------------------------|
| V2650301 | TorqueCapsAdaptMTB QRMAuto Ft |
|----------|-------------------------------|

ADAPTORS

| | | |
|---|----------|--|
| 6 | V2390801 | KIT 2 FORK RESTS FRONT AXLE MTB QRM AUTO |
| | V2372501 | 15mm MTB Axle Cap QRM Auto From 2019 |
| | 99694101 | ADAPTER Ft 15 to 9mm QR |

MAVIC *E-XA Elite 29***DELIVERED WITH**

| | |
|---|--|
| UST valve and accessories (129 838 01) | |
| Tubeless rim tape | |
| User guide | |

COMPATIBILITY

| | |
|-------------------------------|--|
| Freewheel: Shimano/Sram or XD | |
|-------------------------------|--|

Specifications**RIMS**

- **Material** : Mactal
- **Joint** : SUP
- **Drilling** : traditional
- **Weight reduction** : ISM 4D
- **Valve hole diameter** : 6.5 mm
- **Tyre** : UST Tubeless and tubetype
- **Internal width** : 25 mm
- **ETRTO size 27.5"** : 584x25TSS
- **ETRTO size 29"** : 622x25TSS

Hookless profile

Use with Mavic Tubeless Tape

SPOKES

- **Material** : steel
- **Shape** : straight pull, flat, double butted
- **Count** : 24 front and rear
- **Lacing** : front and rear crossed 2

WHEEL HUB

- **Front and rear bodies** : aluminum
 - **Axle material** : aluminum
- Auto adjust sealed cartridge bearings (QRM Auto)
- **Freewheel** : ITS-4 QRM Auto alloy

VERSIONS

- **Color** : Black only
- **Disc standard** : 6 Bolts only
- **Hub width** : Boost only (front 110, rear 148)

WHEEL WEIGHTS