

REFERENCES WHEELS

R25001 Aksium Elite Rr

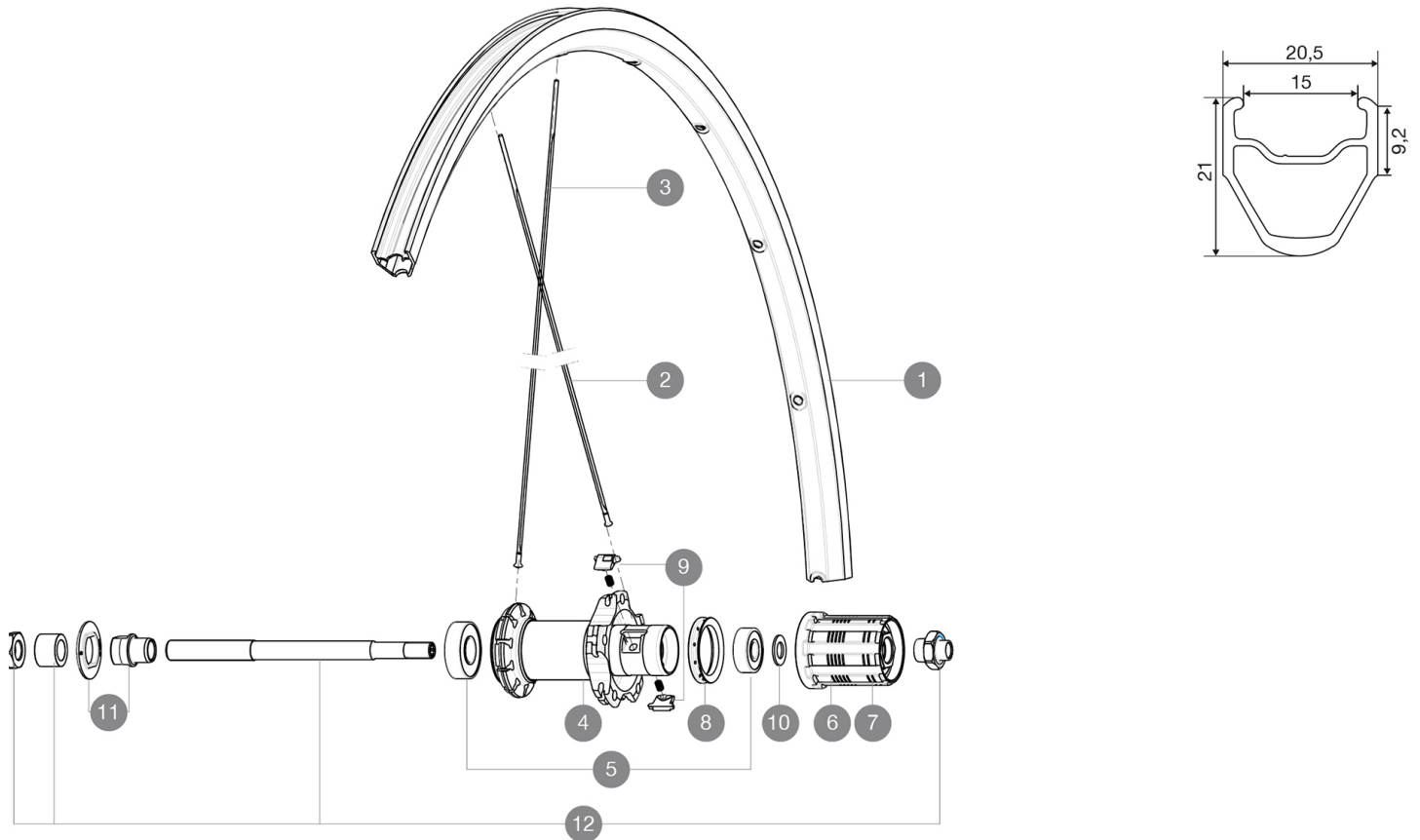

RIMS



VALVE HOLE ? (MM): 6.5 :

| | | |
|---|----------|---------------------------------|
| 1 | V2290715 | KIT FRONT/REAR RIM AKSIUM ELITE |
|---|----------|---------------------------------|

SPOKES

| | | |
|---|----------|--|
| 2 | 10845001 | KIT 10 DS AKSIUM STEEL AERO SPOKES 299mm |
| 3 | 10844901 | KIT 10 FT KSYRIUM EQ S/FT+NDS AKSIUM SPK 285mm - while stock |
| 3 | V4160101 | Kit 10 stainless spokes 285 Ft Ksyrium Equipe S/Ft & NDS Aks |

HUB SHELLS

| | | |
|----|----------|---|
| 4 | N/A | HUB BODY |
| 5 | M40660 | REAR HUB 608+6001 BEARINGS |
| 6 | 30871101 | FTS-L ROAD FREEWHEEL BODY HG11 8/9 compatible |
| 7 | 30871201 | FTS-L ROAD FREEWHEEL BODY ED11 8/9 compatible |
| 8 | 99500001 | FTSL/FTSX FREEHUB BODY SEAL |
| 9 | M40578 | FTSL PAWLS KIT (ROAD WHEELS) |
| 10 | M40067 | INTERNAL FREEWHEEL SPACER FTSL/FTSX |
| 11 | 99603801 | SHORT EXPENSIBLE BEARING SUPPORTS > 2008 |
| 12 | 99603901 | REAR AXLE QRM ROAD 2008 |

MAVIC *Aksium Elite***DELIVERED WITH**

| | |
|----------------------|--|
| BR101 quick releases | |
| Rim tape | |
| User guide | |

Specifications**RIMS**

- **Material** : S6000 Aluminum
- **Height** : 24 mm
- **Joint** : sleeved
- **Drilling** : traditional with H2 reinforcement
- **Brake track** : UB Control
- **Valve hole diameter** : 6.5 mm
- **Tyre** : clincher
- **ETRTO size** : 622x15C
- **Recommended tyre sizes** : 19 to 32 mm

SPOKES

- **Material** : steel
- **Shape** : straight pull, bladed
- **Nipples** : brass, ABS
- **Count** : 20 front and rear
- **Lacing** : radial front and rear non-drive side, crossed 2 rear drive side

WHEEL HUB

- **Front and rear bodies** : aluminum
- **Axle material** : steel
- Sealed cartridge bearings
- **Freewheel** : FTS-L steel

WHEEL WEIGHTS

Wheel weight 935