

REFERENCES WHEELS

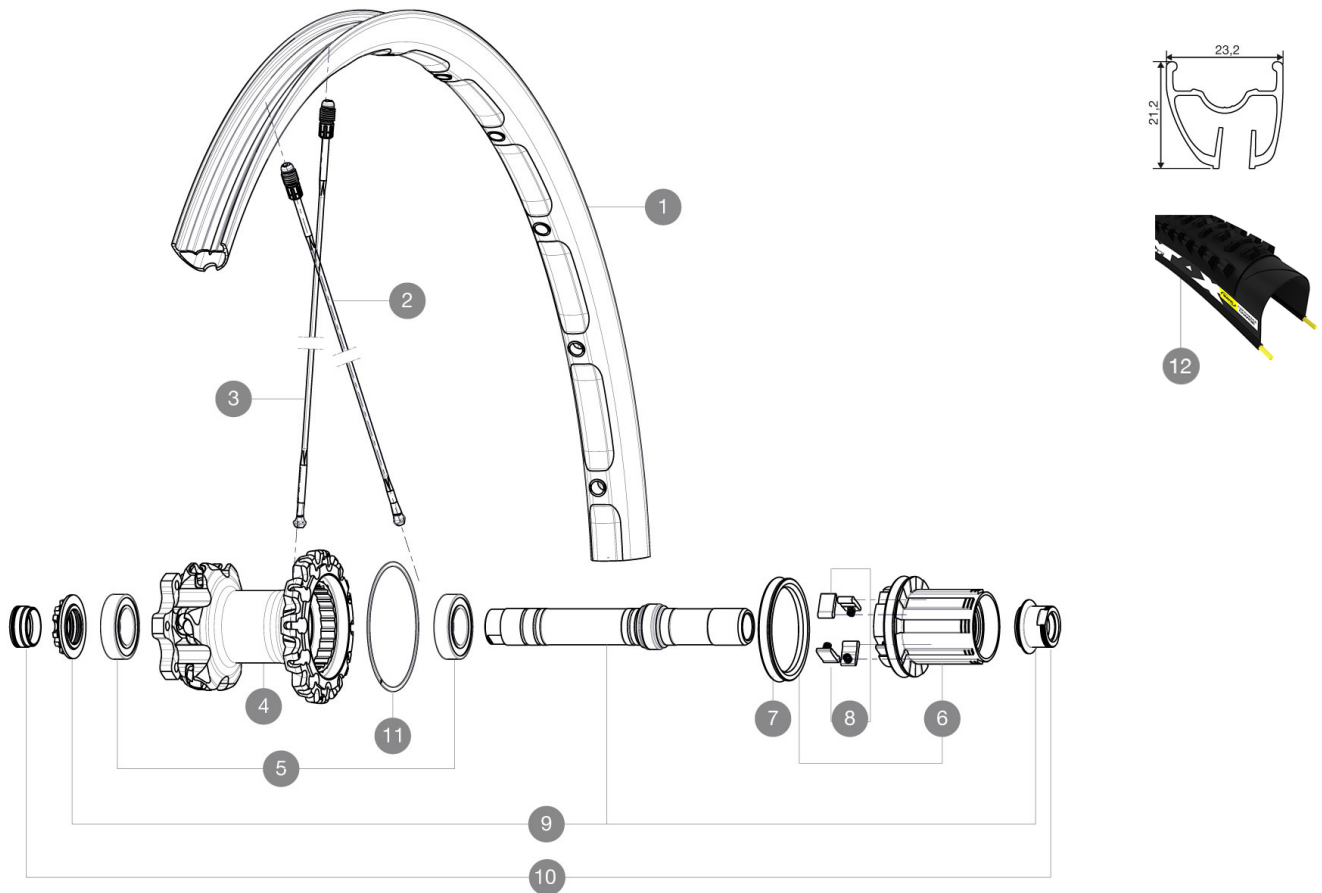

RIMS



&NBSP;:

| | | |
|---|----------|---------------------------------------|
| 1 | 36692413 | "KIT REAR CROSSMAX ENDURO 27,5"" RIM" |
|---|----------|---------------------------------------|

SPOKES

| | | |
|---|----------|--|
| 2 | 36675101 | "KIT 10 DS XMAX SLR/END/PRO/DEEMAX PRO 27,5"" SPK 251,5mm" |
| 3 | 36675001 | "KIT 10 NDS XMAX SLR/ENDURO 27,5"" ALU SPK 281,5mm" |

HUB SHELLS

| | | |
|----|----------|---|
| 4 | N/A | HUB BODY |
| 5 | M40076 | HUB BEARINGS 17x30x7 6903 x 2 |
| 6 | 35126001 | ITS-4 FREEWHEEL BODY + SEAL 2013 (NO PAWLS) |
| 7 | 99610701 | ITS-4 FREEWHEEL SEAL |
| 8 | 99610601 | PAWLS KIT FOR ITS-4 (OR TS-2) |
| 9 | 30870401 | REAR QRM + AXLE KIT ITS4 135mm from 2012 |
| 11 | 30871801 | ELASTIC RING 56mm diam. ITS-4 20 SPOKES |

TYRES

| | | |
|----|----------|-----------------------|
| 12 | 35636522 | Crossmax Roam XL 650b |
|----|----------|-----------------------|

ADAPTERS

| | | |
|----|----------|--|
| 10 | 30872201 | FRAME SUPPORT ITS-4 135mm REAR AXLE > 2012 |
|----|----------|--|

MAVIC *Crossmax Enduro 27.5 WTS***DELIVERED WITH**

| | |
|---------------------------------|--|
| BX601 rear quick release | |
| UST valve and accessories | |
| Front 15 mm adapters | |
| Front 20 mm adapters | |
| Rear QR adapters | |
| Rear 12x142mm adapters | |
| Specific disc bolts | |
| Multifonction adjustment wrench | |
| User guide | |

Specifications**RIMS**

- **Material** : Maxtal
 - **Joint** : SUP
 - **Drilling** : Fore
- Disc brake specific profile
- **Weight reduction** : ISM
 - **Valve hole diameter** : 6.5 mm
 - **Tyre** : UST Tubeless and tubetype
 - **Internal width** : 21 mm front and 19mm rear
 - **ETRTO size 26"** : 559x21C front & 559x19C rear
 - **ETRTO size 650b/27.5"** : 584x21C front & 584x19C rear
 - **Recommended tyre sizes** : 2.0 to 2.5

SPOKES

- **Material** : Zicral
- **Shape** : straight pull, bladed
- **Nipples** : Fore integrated aluminum
- **Count** : 24 front and 20 rear
- **Lacing** : front crossed 2, rear Isopulse

WHEEL HUB

- **Front and rear bodies** : aluminum
 - **Axle material** : aluminum
- Adjustable sealed cartridge bearings
- **Freewheel** : ITS-4 alloy
- Shimano 11 speeds compatible
XD Compatible (XX1-X01) with optionnal kit

WHEEL WEIGHTS

Weight Rear 26": 835
Weight Rear 27.5": 860