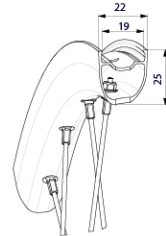
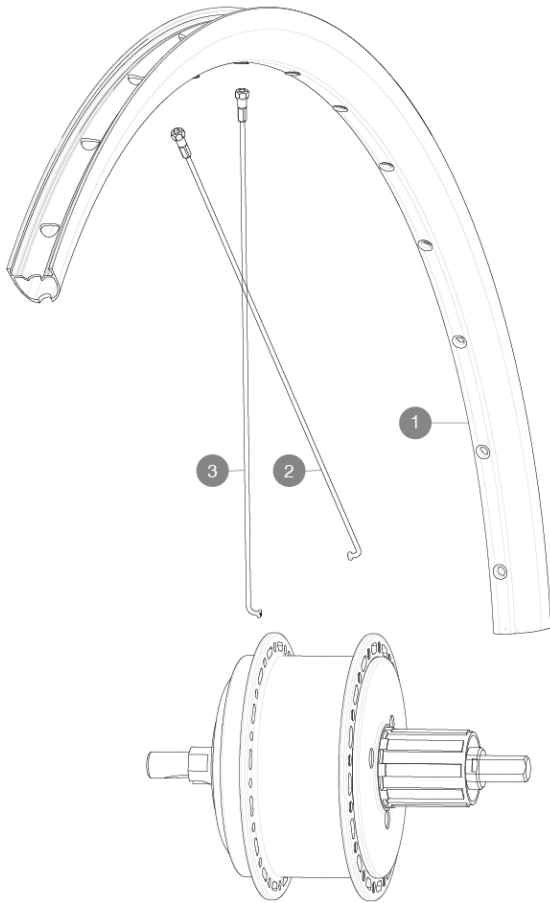

**MAVIC KSYRIUM S 25 DISC MAHLE**

Maximum tyre pressure: 4.4bar/64PSI with a 28mm tyre - 2.6bar/38PSI with a 64mm tyre  
 ASTM CATEGORY 2 : road and offroad with jumps less than 15cm  
 For a longer longevity of the wheel, Mavic recommends that the total weight supported by the wheels doesn't exceed 120kg, bike included  
 Maximum tyre size: width 62mm - pressure max. 3.8Bar/55PSI

**REFERENCES WHEELS****RIMS**

&amp;NBSP;:

|          |          |  |
|----------|----------|--|
| <b>1</b> | V4094213 | Kit Rear rim Ksyrium S Disc EBM          |
|          | V2620101 | UST RIM TAPE 25mm (for 21-24mm wide rim) |

**SPOKES**

|          |          |  |
|----------|----------|--|
| <b>2</b> | V4164601 | Kit 16 Rear Drive Side round Jbent spoke 249 Ksyrium S Disc  |
| <b>3</b> | V4164501 | Kit 16 Rear Non Drive Side round Jbent spoke 251 Ksyrium S D |

**MAVIC** **KSYRIUM S 25 DISC MAHLE****DELIVERED WITH**

|   |  |
|---|--|
| Mavic tyre sealant (rear wheel)<br>(355 466 01)                             |  |
| User guide  |  |
| Front QR adapters   |  |
| UST valve and accessories<br>(129 838 01)                                   |  |
| Pre-installed tubeless rim tape   |  |
| Multifunction adjustment wrench (delivered with rear wheel)<br>(325 423 01) |  |
| User guide  |  |
| Pre-installed tubeless rim tape   |  |
| UST valve and accessories<br>(129 838 01)                                   |  |
| Front QR adapters   |  |
| Multifunction adjustment wrench (delivered with rear wheel)<br>(325 423 01) |  |

**COMPATIBILITY**

|   |  |
|---|--|
| Instant Drive 360 freewheel technology<br>The new Instant Drive 360 freewheel system is super light and fast to engage with only 9Å°. A large contactless rubber seal provides low friction, while a wide array of end caps makes it super versatile. |  |
| FTS-L Shimano / Sram freewheel body<br>([30871101] - Delivered on the wheel)  |  |

**Specifications****RIMS**

- **Material** : Mxxtal
- **Material** : Mxxtal
- **Height** : 22 mm
- **Height** : 22 mm
- **Joint** : SUP welding technology
- **Joint** : SUP welding technology
- **Drilling** : traditional (front 24 holes and rear 32 holes)
- **Drilling** : traditional (front 24 holes and rear 32 holes)

Disc brake specific profile

Disc brake specific profile

- **ETRTO size** : 622x19TC
- **ETRTO size** : 622x19TC
- **Tire** : clincher
- **Tire** : clincher

**SPOKES**

- **Material** : steel
- **Material** : steel
- **Shape** : straight pull, round
- **Shape** : straight pull, round
- **Count** : 28 front and rear
- **Count** : 28 front and rear

Instant Drive 360 freewheel technology

**WHEEL HUB**

- **Body** : aluminum
  - **Body** : aluminum
  - **Disc standard** : 6 Bolts only
  - **Disc standard** : 6 Bolts only
  - **Axle material** : aluminum
  - **Axle material** : aluminum
- Hub available with 6-bolt brake rotors  
Hub available with 6-bolt brake rotors

**WHEEL WEIGHTS**