

参照ホイール

ASTM CATEGORY 2 : road and offroad with jumps less than 15cm
 For a longer longevity of the wheel, Mavic recommends that the total weight supported by the wheels doesn't exceed 120kg, bike included
 Recommended tire sizes: 25 to 32 mm
 Max. Pressure: see indication on wheel and tire. If they differ, use the lowest of the 2

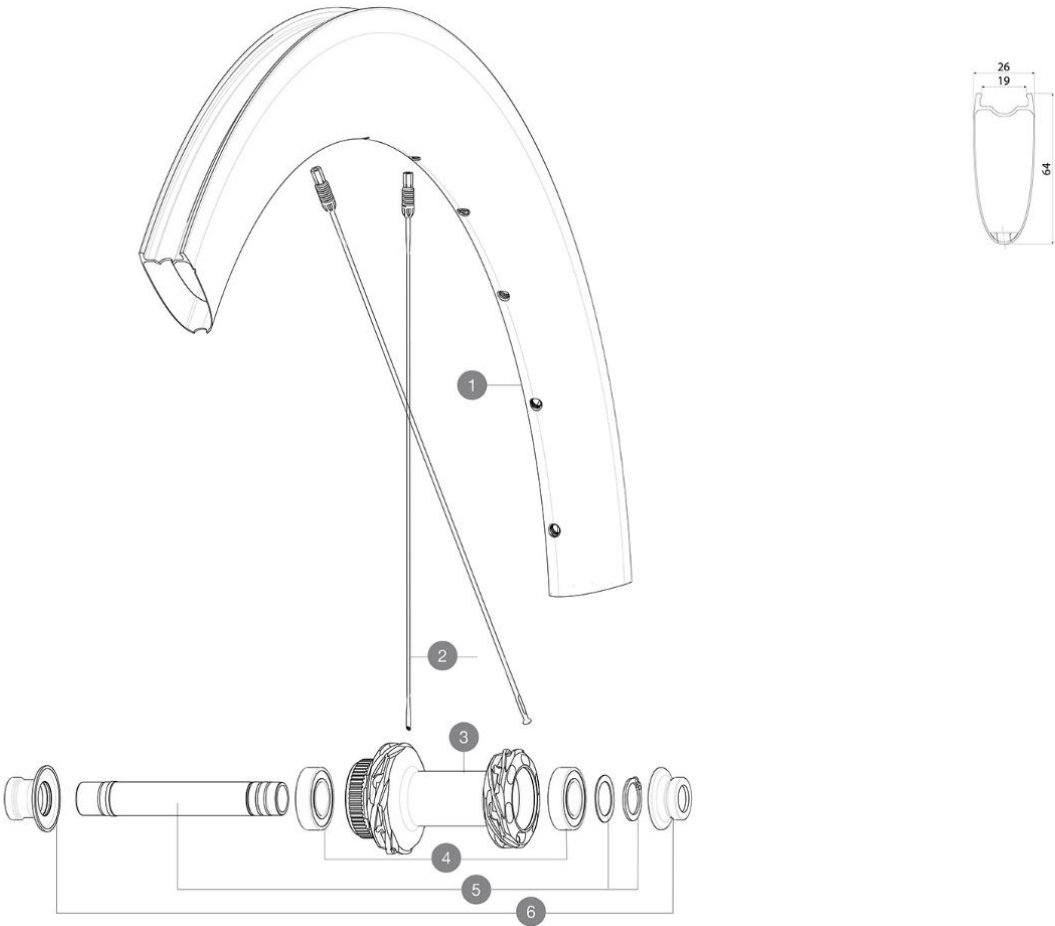

RIMS



&NBSP;:

1	V00062631	Kit Front/Rear rim Cosmic SLR65 Ltd
---	-----------	-------------------------------------

SPOKES

2	V4164901	Kit 12 CosmicSLR65 Disc aero ssbk M6 259
---	----------	--

HUB SHELLS

3	N/A	HUB BODY
3	N/A	HUB BODY
4	M40129	KIT 2 BEARINGS 6902 15x28x7
5	V2373301	KIT QRM AUTO FRONT AXLE 12mm > 2019

ADAPTERS

6	V2374701	KIT FRONT ROAD FORK REST 12mm FOR J BENT DISC HUB
	V2680301	"Kit Ft Road Adapter 12 >> 9mm"



COSMIC SLR 65 LTD

付属品

UST valve and accessories (129 838 01)	
User guide	

COMPATIBILITY

Freewheel: Shimano/Sram, convertible to Campagnolo ED11, N3W and XD-R with optional driver bodies	
Rear axle: 12mm thru axle, convertible to Quick Release with optional adapters and axle replacement	
Front axle: 12x100 thru axle, easily convertible to quick release with optional adapters. Not compatible with 15mm through axles	

Specifications

リム

- Material : 100% carbon fiber with UD^{Å²} external layer
- Material : 100% carbon fiber
- Height : 64mm
- Disc brake specific profile
- Tire : UST Tubeless and tubetype
- Internal width : 19 mm
- ETRTO size : 622x19TC
- Fore Carbon tapeless tubeless technology
- UST tubeless technology

スポーク

- Material : steel
- Shape : straight pull, elliptical aero, double butted (patented)
- Nipples : Fore integrated aluminum
- Count : 24 front and rear
- Lacing : front and rear crossed 2, contactless

ホイールハブ

- Front and rear bodies : aluminum
- Axle material : aluminum
- Front : Quick release and 12x100 through axle compatible
- Rear : Quick Release, 12x142 and 12x135 compatible
- Infinity hubs
- ã□□ã□□ã□`ã□»ã□²ã□¿ã□¼ã□ã□ã□`ã□¿ã□²ã□□ã□@ã□□ã□~ã□¼ã□ã□-ã□¼ã□¿ã□¼ã□@ã□¿ã□«ã`¼ã¿□
- Instant Drive 360 freewheel technology
- QRM Auto bearing preload technology

VERSIONS

- Disc standard : Center Lock^Å only
- Freewheel : Shimano/Sram

ホイールの重み

705