

## REFERENCES WHEELS

ASTM CATEGORY 2 : road and offroad with jumps less than 15cm  
For a longer longevity of the wheel, Mavic recommends that the total weight supported by the wheels doesn't exceed 120kg, bike included  
Recommended tire sizes: 25 to 32 mm  
Max. Pressure: see indication on wheel and tire. If they differ, use the lowest of the 2

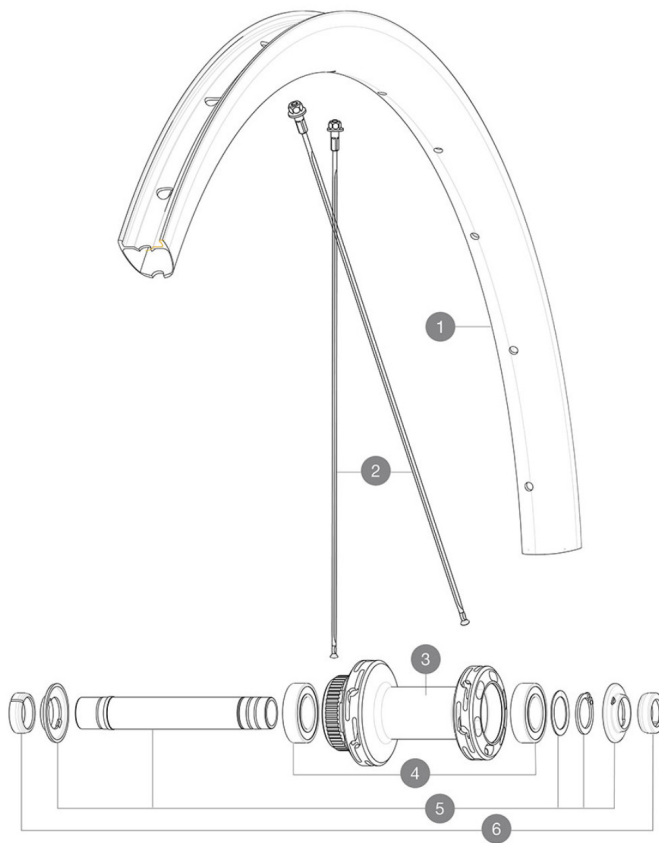

## RIMS



&amp;NBSP;:

|   |           |  |
|---|-----------|--|
| 1 | V00063531 | Kit Front/Rear rim Cosmic SL32 Ltd       |
|   | V2620101  | UST RIM TAPE 25mm (for 21-24mm wide rim) |

## SPOKES

|   |          |  |
|---|----------|--|
| 2 | V4163401 | Kit 12 Front/Rear Cosmic SL 32 Disc butted stainless spoke 2 |
|---|----------|--|

## HUB SHELLS

|   |          |                                     |
|---|----------|-------------------------------------|
| 3 | N/A      | HUB BODY                            |
| 4 | M40129   | KIT 2 BEARINGS 6902 15x28x7         |
| 5 | V2373301 | KIT QRM AUTO FRONT AXLE 12mm > 2019 |

## ADAPTERS

|   |          |                                 |
|---|----------|---------------------------------|
| 6 | V2680501 | 12mm Road Axle Cap QRM Auto     |
|   | V2680301 | "Kit Ft Road Adapter 12 >> 9mm" |



# COSMIC SL 32 LTD

### DELIVERED WITH

|   |  |
|---|--|
| Front QR adapters                                   |  |
| Rear QR adapters for Instant Drive 360 (B49 894 01) |  |
| UST valve and accessories (129 838 01)              |  |
| Pre-installed tubeless rim tape                     |  |
| User guide  |  |

### COMPATIBILITY

|   |  |
|---|--|
| Freewheel: Shimano/Sram, convertible to Campagnolo ED11, N3W and XD-R with optional driver bodies                                 |  |
| Front axle: 12x100 thru axle, easily convertible to quick release with included adapters. Not compatible with 15mm through axles. |  |
| Rear axle: 12mm thru axle, convertible to Quick Release with included adapters  |  |

### Specifications

#### RIMS

- **Material** : 100% carbon fiber
  - **Height** : 32mm
  - **Drilling** : traditional
- Disc brake specific profile
- **Tire** : UST Tubeless and tubetype
  - **Internal width** : 21 mm
  - **ETRTO size** : 622x21TC
- UST tubeless technology

#### SPOKES

- **Material** : steel
- **Shape** : straight pull, flat, double butted
- **Nipples** : brass, ABS
- **Count** : 24 front and rear
- **Lacing** : front and rear crossed 2, contactless

#### WHEEL HUB

- Infinity hubs
- **Front and rear bodies** : aluminum
  - **Axle material** : aluminum
- Instant Drive 360 freewheel technology  
QRM Auto bearing preload technology
- **Front** : Quick release and 12x100 through axle compatible
  - **Rear** : Quick Release, 12x142 and 12x135 compatible
- Hub available for Center Lock brake rotors only

#### VERSIONS

- **Disc standard** : Center Lock® only
- **Freewheel** : Shimano/Sram

#### WHEEL WEIGHTS

692