

REFERENCES WHEELS

ASTM CATEGORY 5 : GRAVITY RIDING FOCUSED ON THE DESCENT
 Minimum tyre size: width 52mm - pressure max. 2.95Bar/43PSI
 For a longer longevity of the wheel, Mavic recommends that the total weight supported by the wheels doesn't exceed 180kg, E-bike included

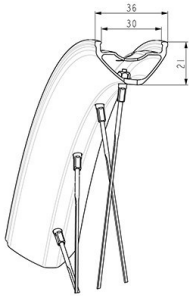
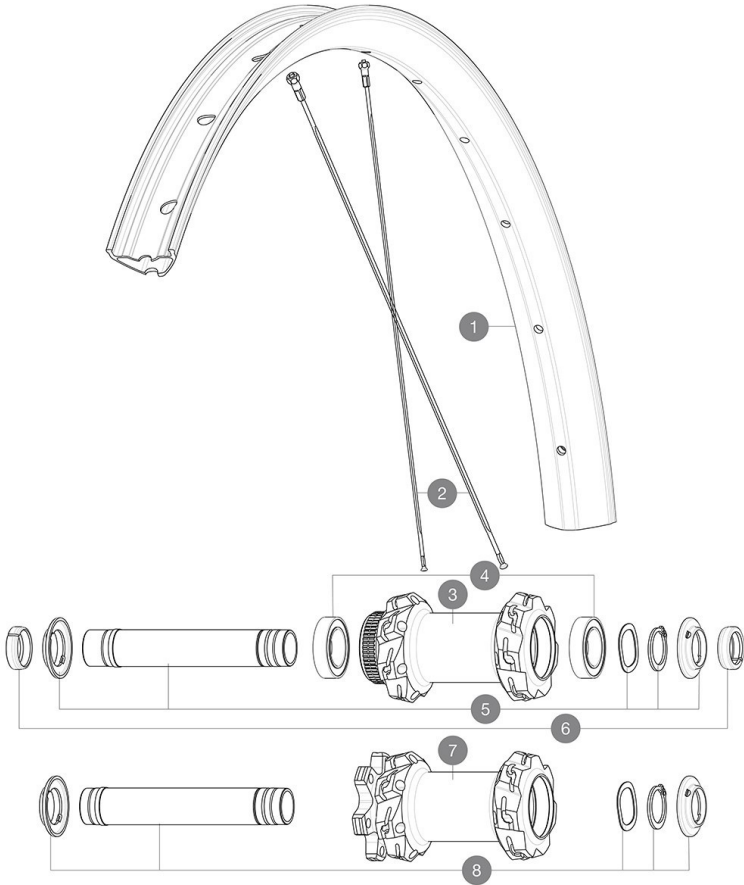

Specifications	Maxi target
Frontal run out	0,5mm
Lateral run out	0,5mm
Centring	1,0mm (2x0,5)
Tension daN	83 > 126
Disc side	

RIMS



&NBSP;:

1	V00096331	Kit Front/Rear rim eDeemax 24 29"
	V3750101	35mm UST Green Tape for 30mm wide rims

SPOKES

2	V00096831	Kit 14 steel spokes 302mm eDeemax 24 29"
---	-----------	--

HUB SHELLS

3	N/A	HUB BODY
4	V2500901	KIT BEARINGS 18x30x7 + WAVED WASHER + CLIP
5	V2375601	Kit 110mm axle QRM auto MTB from 2019 DCL
7	N/A	HUB BODY
8	V2372401	KIT 110mm AXLE QRM AUTO MTB > 2019

ADAPTERS

6	V2372501	15mm MTB Axle Cap QRM Auto From 2019
---	----------	--------------------------------------



E-DEEMAX 29

DELIVERED WITH

UST valve and accessories (129 838 01)	
Pre-installed tubeless rim tape	
User guide	
2 replacement spokes with each wheel	

COMPATIBILITY

Freewheel body: convertible SHIMANO HG MTB aluminium (kit V3780101 sold separately)	
Freewheel body: convertible SHIMANO HG MTB steel (kit V3790101 sold separately)	
Rear axle adapters: 12x148 convertible to 9x141 (kit V2510801 sold separately)	
Instant Drive 360 freewheel technology The new Instant Drive 360 freewheel system is super light and fast to engage with only 9°. A large contactless rubber seal provides low friction, while a wide array of end caps makes it super versatile.	
Front axle: for fixing nuts only (included), M9x1 thread	

Specifications

RIMS

- **Material** : Mactal
 - **Height** : 22 mm
 - **Joint** : SUP welding technology
 - **Internal width** : 30 mm
 - **Drilling** : traditional (front/rear 28 holes)
- Disc brake specific profile
Asymmetrical rim design
- **ETRTO size 29"** : 622x30TC
 - **Tire** : clincher

SPOKES

- **Material** : steel
- **Lacing** : front and rear crossed 2, contactless

WHEEL HUB

- **Body** : aluminum
- **Body design** : INFINITY
- **Disc standard** : 6 Bolts or Center Lock®
- **Axle material** : aluminum
- **Rear body** : aluminum
- **Axles** : Front 15X110 (Boost) or 15x100 ; Rear 12X148 (Boost) or 12x142
- **Rear** : Quick Release, 12x142 and 12x135 compatible
- **Freewheel** : FTS-L steel

WHEEL WEIGHTS

1066