

**MAVIC** **COSMIC SLR 32 BG****REFERENCES WHEELS**

ASTM CATEGORY 2 : road and offroad with jumps less than 15cm

For a longer longevity of the wheel, Mavic recommends that the total weight supported by the wheels doesn't exceed 120kg, bike included

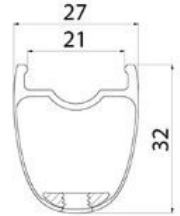
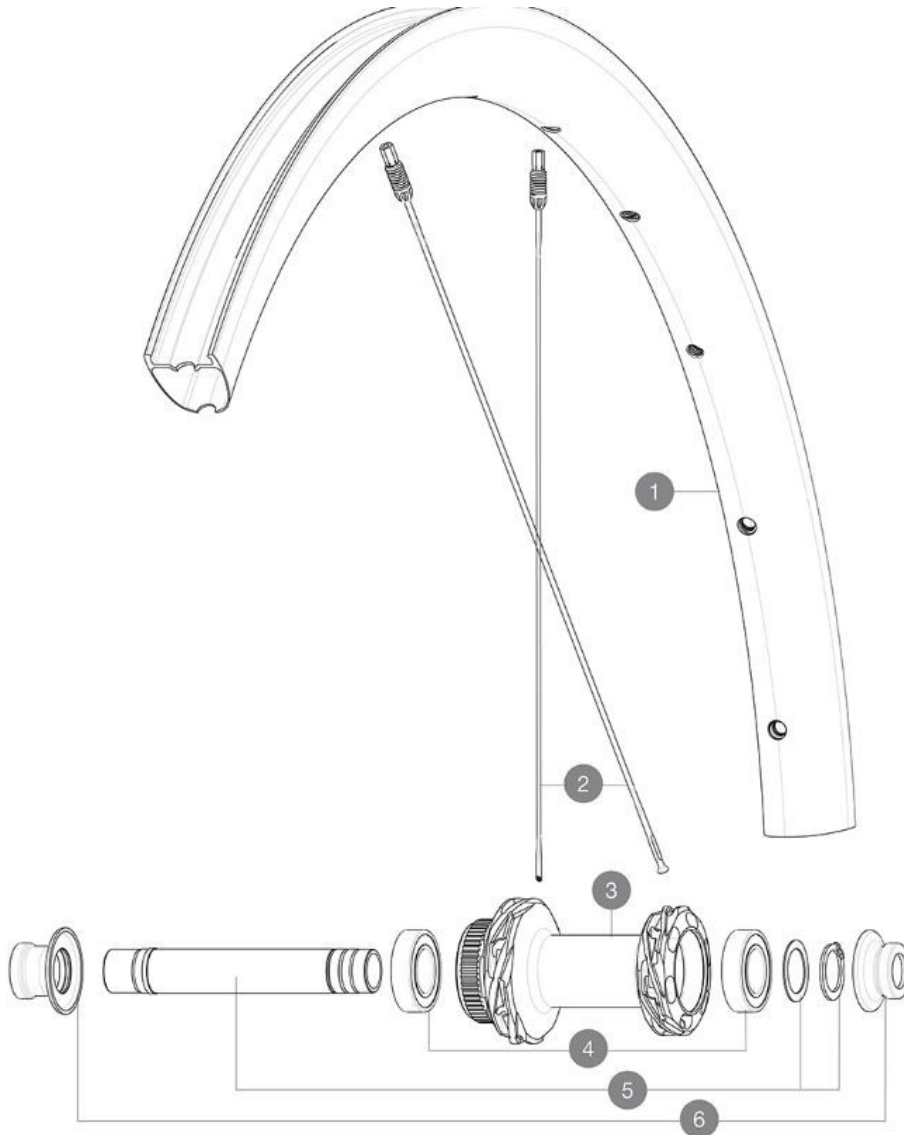

Specifications	Maxi target
Frontal run out	0,4mm
Lateral run out	0,5mm
Centring	1,0mm (2x0,5)
Tension daN Disc side	87 > 105

**RIMS**

&NBSP;:

**1** V4094615 Kit Front/Rear rim Cosmic SLR 32 Disc

**SPOKES**

**2** V4164801 Kit 12 CosmicSLR32 Disc aero sspk M6 291

**HUB SHELLS**

**3** N/A HUB BODY  
**3** N/A HUB BODY  
**4** M40129 KIT 2 BEARINGS 6902 15x28x7  
**5** V2373301 KIT QRM AUTO FRONT AXLE 12mm > 2019

**OPTIONS**

V2680301 "Kit Ft Road Adapter 12 >> 9mm"

**ADAPTERS**

**6** V2374701 KIT FRONT ROAD FORK REST 12mm FOR J BENT DISC HUB

**DELIVERED WITH**

UST valve and accessories (129 838 01)	
User guide	

**COMPATIBILITY**

Freewheel body: convertible SRAM XD road (kit V2580101 sold separately)	
Freewheel body: convertible SHIMANO HG light road (kit V3850101 sold separately)	
Freewheel body: convertible SHIMANO MS (kit V3990101 sold separately)	
Freewheel body: convertible CAMPAGNOLO ED (kit V3440101 sold separately)	
Freewheel body: convertible CAMPAGNOLO N3W (kit V4270101 sold separately)	
FTS-L Shimano / Sram freewheel body ([30871101] - Delivered on the wheel)	
ID360 Shimano steel freewheel body (V3790101)	
ID360 Sram XD freewheel body (V3740101)	
Rear axle: for fixing nuts only (included), M9x1 thread	
ID360 Shimano Micro Spline alloy freewheel body (V3990101)	
ID360 N3W freewheel body (V4270101)	
Front axle: convertible from 15mm thru axle to Quick Release with adapters (delivered with non-boost wheel)	
ID360 Campagnolo freewheel body (V3440101)	

**Specifications****RIMS**

- **Material** : 100% carbon fiber with UD<sup>2</sup> external layer
  - **Height** : 32mm
  - **Internal width** : 21 mm
- Fore Carbon tapeless tubeless technology  
Disc brake specific profile
- **ETRTO size** : 622x21TC
  - **Tire** : UST Tubeless and tubetype

**SPOKES**

- **Material** : steel
  - **Shape** : straight pull, elliptical aero, double butted (patented)
  - **Screw** : M6
- R2R carbon spoke technology

**WHEEL HUB**

- **Body** : aluminum
- **Body design** : INFINITY
- **Disc standard** : Center Lock<sup>®</sup> only
- **Axle material** : aluminum
- **Axle size** : front 12x100 / rear 12x142 - Convertible to quick release with included adapters
- **Axles** : Front 15X110 (Boost) or 15x100 ; Rear 12X148 (Boost) or 12x142
- **Freewheel** : Shimano HG road
- **Freewheel** : FTS-L steel

**WHEEL WEIGHTS**