

MAVIC **COSMIC SLR 32 BG****REFERENCES WHEELS**

ASTM CATEGORY 2 : road and offroad with jumps less than 15cm

For a longer longevity of the wheel, Mavic recommends that the total weight supported by the wheels doesn't exceed 120kg, bike included

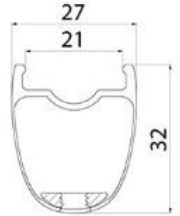
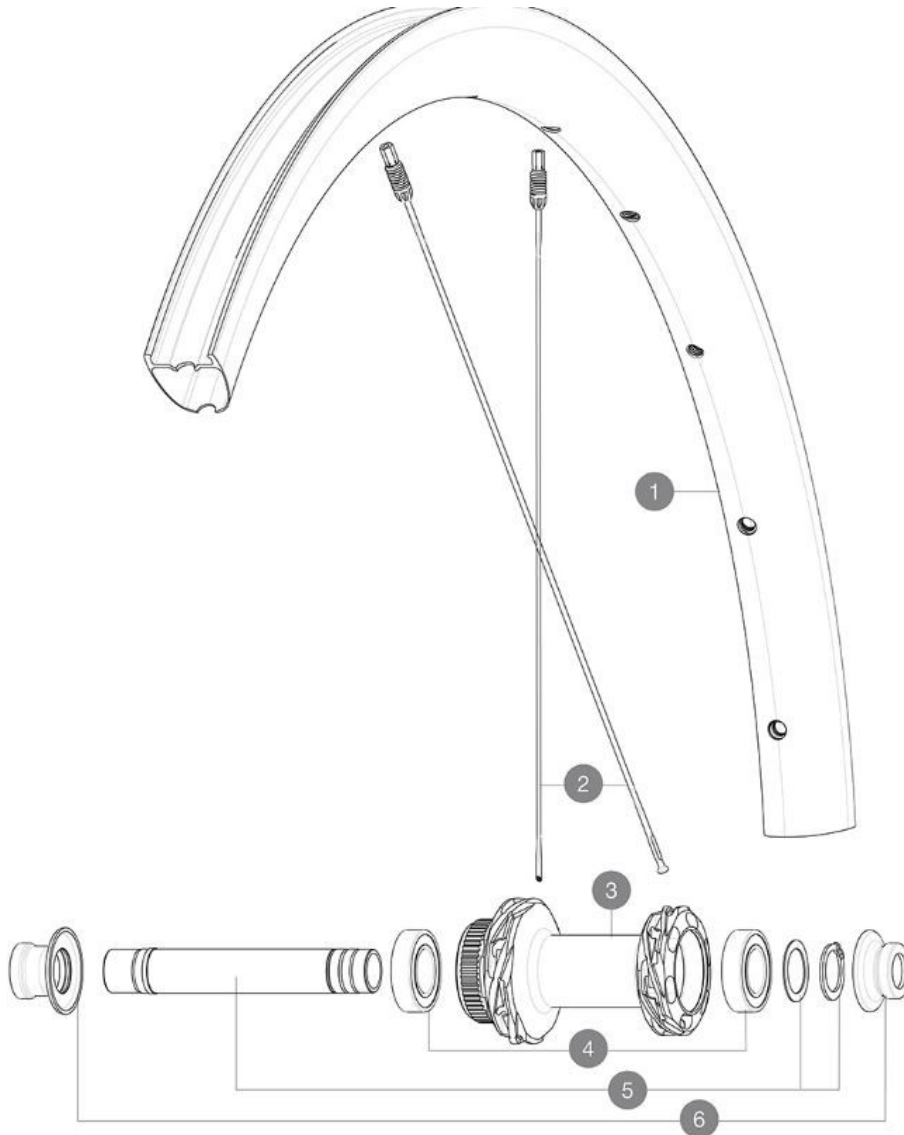

| Specifications | Maxi target |
|--------------------------|---------------|
| Frontal run out | 0,4mm |
| Lateral run out | 0,5mm |
| Centring | 1,0mm (2x0,5) |
| Tension daN Disc side | 87 > 105 |

RIMS

&NBSP;:

1 V4094615 Kit Front/Rear rim Cosmic SLR 32 Disc

SPOKES

2 V4164801 Kit 12 CosmicSLR32 Disc aero sspk M6 291

HUB SHELLS

3 N/A HUB BODY
3 N/A HUB BODY
4 M40129 KIT 2 BEARINGS 6902 15x28x7
5 V2373301 KIT QRM AUTO FRONT AXLE 12mm > 2019

OPTIONS

V2680301 "Kit Ft Road Adapter 12 >> 9mm"

ADAPTERS

6 V2374701 KIT FRONT ROAD FORK REST 12mm FOR J BENT DISC HUB

DELIVERED WITH

| | |
|---|--|
| UST valve and accessories (129 838 01) | |
| User guide | |

COMPATIBILITY

| | |
|---|--|
| Freewheel body: convertible SRAM XD road (kit V2580101 sold separately) | |
| Freewheel body: convertible SHIMANO HG light road (kit V3850101 sold separately) | |
| Freewheel body: convertible SHIMANO MS (kit V3990101 sold separately) | |
| Freewheel body: convertible CAMPAGNOLO ED (kit V3440101 sold separately) | |
| Freewheel body: convertible CAMPAGNOLO N3W (kit V4270101 sold separately) | |
| ID360 Campagnolo freewheel body ([V3440101]) | |
| FTS-L Shimano / Sram freewheel body ([30871101] - Delivered on the wheel) | |
| ID360 Shimano steel freewheel body ([V3790101]) | |
| ID360 Sram XD freewheel body ([V3740101]) | |
| Rear axle: for fixing nuts only (included), M9x1 thread | |
| ID360 Shimano Micro Spline alloy freewheel body ([V3990101]) | |
| ID360 N3W freewheel body ([V4270101]) | |
| Front axle: convertible from 15mm thru axle to Quick Release with adapters (delivered with non-boost wheel) | |

Specifications

RIMS

- **Material** : 100% carbon fiber with UDÂ² external layer
 - **Height** : 32mm
 - **Internal width** : 21 mm
- Fore Carbon tapeless tubeless technology
Disc brake specific profile
- **ETRTO size** : 622x21TC
 - **Tire** : UST Tubeless and tubetype

SPOKES

- **Material** : steel
 - **Shape** : straight pull, elliptical aero, double butted (patented)
 - **Screw** : M6
- R2R carbon spoke technology

WHEEL HUB

- **Body** : aluminum
- **Body design** : INFINITY
- **Disc standard** : Center LockÂ© only
- **Axle material** : aluminum
- **Axle size** : front 12x100 / rear 12x142 - Convertible to quick release with included adapters
- **Axles** : Front 15X110 (Boost) or 15x100 ; Rear 12X148 (Boost) or 12x142
- **Freewheel** : Shimano HG road
- **Freewheel** : FTS-L steel

WHEEL WEIGHTS