

## 参照ホイール

|        |                         |        |                                |
|--------|-------------------------|--------|--------------------------------|
| 111369 | KSYRIUM SLR FRT WTS     | 120514 | KSYRIUM SLR ED11PR WTS         |
| 111378 | KSYRIUM SLR TUBULAR FRT | 120515 | KSYRIUM SLR M10TUBULAR PR      |
| 120513 | KSYRIUM SLR M10PR WTS   | 120516 | KSYRIUM SLR ED11TUBULAR PR WTS |

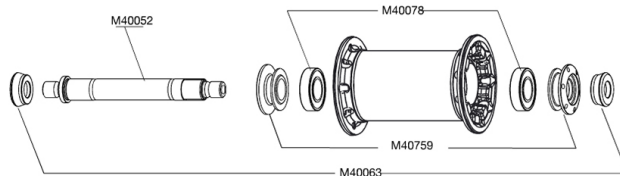

## RIMS



&NBSP;:

12020810 FRONT KSYRIUM SLR CLINCHER RIM

## SPOKES

12029501 10 BLK OPP.DRIVE SIDE SPK R-SYS SLR CLINCH.284mm  
12030201 12 BLK FRONT SPOKES KSYRIUM SLR/SR/SL 11 285mm

## HUB SHELLS

M40052 FRONT HUB AXLE  
M40759 ADJUST.NUT+CAP XMAX SL CERA FR  
M40078 FRONT HUB 6901 BEARINGS  
M40063 2 FRONT AXLE FORK SUPPORT

## MAINTENAN

### CE

11104001 Chambres à air 48mm

## TYRES

11941201 Yksion GripLink Tubular 23 (boyau)  
11849801 Yksion GripLink 23



# Ksyrium SLR

## Specifications

ホイールの重み