

## REFERENCES WHEELS

112016 ELLIPSE 11 PR

112014 ELLIPSE 11 FRT

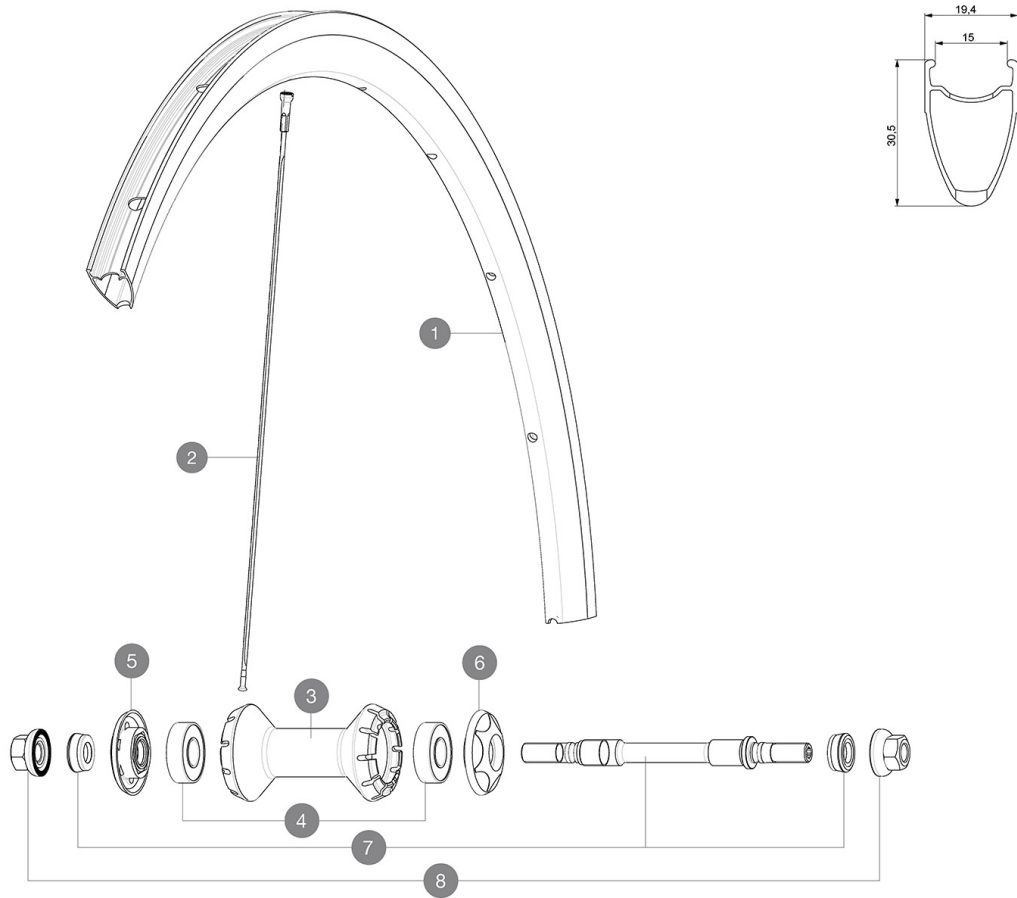

### RIMS



&NBSP;:

1 12033415 KIT FRONT/REAR ELLIPSE 11 RIM

### SPOKES

2 12033701 KIT 10 FRONT ELLIPSE 11 BLACK SPOKE 279mm

### HUB SHELLS

|   |          |   |
|---|----------|---|
| 3 | N/A      | HUB BODY                                      |
| 4 | M40318   | KIT 2 HUB BEARINGS 6001                       |
| 5 | M40242   | AXLE CAP + ADJUSTING NUT                      |
| 6 | M40243   | AXLE CAP                                      |
| 7 | 32386101 | ELLIPSE FRONT AXLE + FORK SUPPORTS            |
| 8 | 32388601 | 2 AXLE BOLTS RR COMETE TRACK/ELLIPSE FT-RR M9 |

# MAVIC *Ellipse*

## DELIVERED WITH

|                                 |  |
|---------------------------------|--|
| Fixing nuts                     |  |
| Fixing nuts                     |  |
| Rim tape                        |  |
| Rim tape                        |  |
| Valve extender                  |  |
| Valve extender                  |  |
| Cog lock nut                    |  |
| Cog lock nut                    |  |
| Multifunction adjustment wrench |  |
| Multifunction adjustment wrench |  |
| User guide                      |  |
| User guide                      |  |

## Specifications

### RIMS

- **Material** : 6106 Aluminum
- **Material** : 6106 Aluminum
- **Color** : black anodized
- **Height** : 30 mm
- **Height** : 30 mm
- **Joint** : SUP
- **Eyelet** : not eyeleted
- **Joint** : SUP
- **Drilling** : traditional
- **Eyelet** : not eyeleted
- **Valve hole diameter** : 6.5 mm
- **Tyre** : clincher
- **Valve hole diameter** : 6.5 mm
- **Tyre** : clincher
- **ETRTO size** : 622x15C
- **ETRTO size** : 622x15C
- **Recommended tyre sizes** : 18 to 22 mm
- **Recommended tyre sizes** : 19 to 28 mm

### SPOKES

- **Material** : steel
- **Material** : steel
- **Shape** : straight pull, bladed
- **Shape** : straight pull, bladed
- **Color** : black

### WHEEL HUB

- **Front and rear bodies** : aluminum
- **Front and rear bodies** : aluminum
- **Front and rear axle material** : steel
- **Color** : black
- **Front and rear axle material** : steel
- Fixed cog
- QRM+
- Fixed cog

### WHEEL WEIGHTS

905