

REFERENCES WHEELS

112016 ELLIPSE 11 PR

112015 ELLIPSE 11 REAR

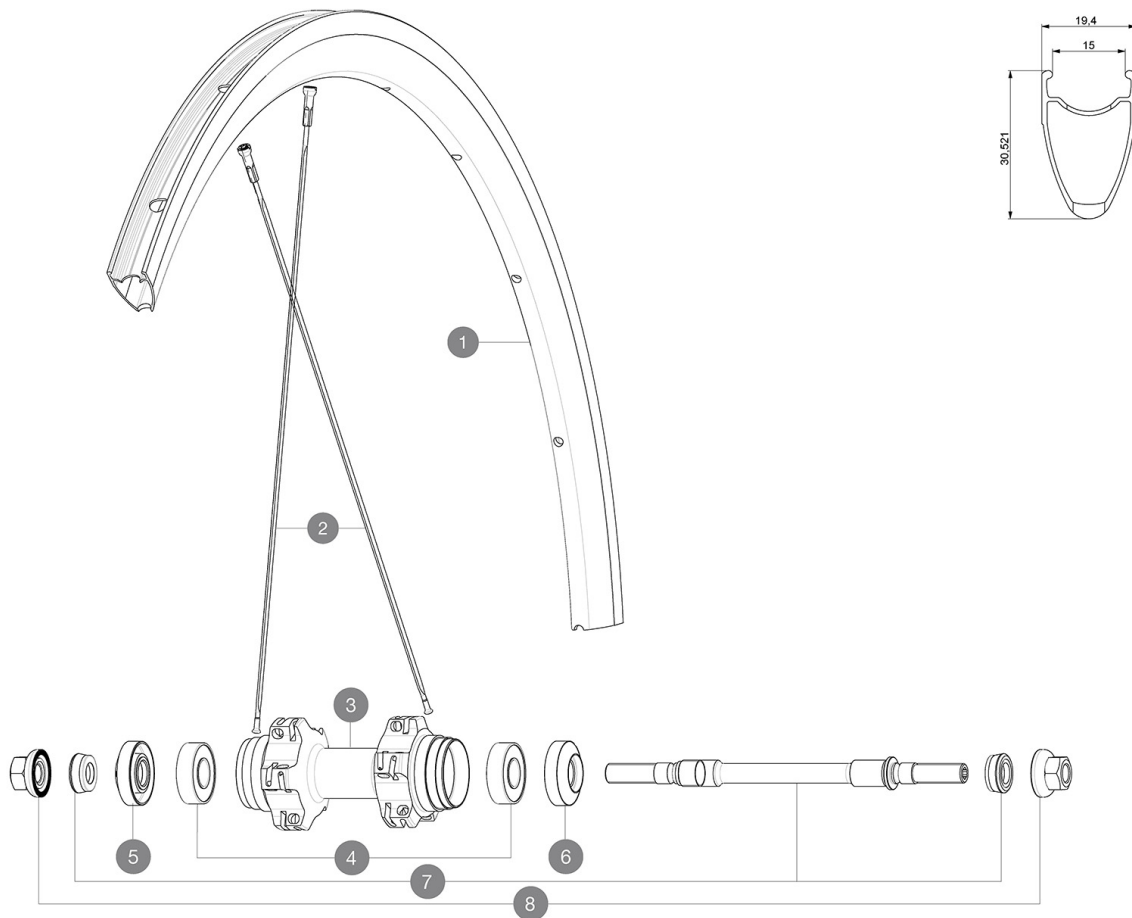

RIMS



&NBSP;:

1 12033415 KIT FRONT/REAR ELLIPSE 11 RIM

SPOKES

2 12033801 KIT 10 REAR ELLIPSE 11 BLACK SPOKE 296mm

HUB SHELLS

3	N/A	HUB BODY
4	M40318	KIT 2 HUB BEARINGS 6001
5	M40447	ADJUSTING CAP BLACK FOR ELLIPSE
6	M40448	BLACK REAR HUB CAP ELLIPSE
7	32386201	ELLIPSE REAR AXLE + FORK SUPPORTS
8	32388601	2 AXLE BOLTS RR COMETE TRACK/ELLIPSE FT-RR M9

MAVIC *Ellipse*

DELIVERED WITH

Fixing nuts	
Fixing nuts	
Rim tape	
Rim tape	
Valve extender	
Valve extender	
Cog lock nut	
Cog lock nut	
Multifunction adjustment wrench	
Multifunction adjustment wrench	
User guide	
User guide	

Specifications

RIMS

- **Material** : 6106 Aluminum
- **Material** : 6106 Aluminum
- **Height** : 30 mm
- **Color** : black anodized
- **Height** : 30 mm
- **Joint** : SUP
- **Joint** : SUP
- **Eyelet** : not eyeleted
- **Drilling** : traditional
- **Eyelet** : not eyeleted
- **Valve hole diameter** : 6.5 mm
- **Tyre** : clincher
- **Valve hole diameter** : 6.5 mm
- **Tyre** : clincher
- **ETRTO size** : 622x15C
- **ETRTO size** : 622x15C
- **Recommended tyre sizes** : 18 to 22 mm
- **Recommended tyre sizes** : 19 to 28 mm

SPOKES

- **Material** : steel
- **Material** : steel
- **Shape** : straight pull, bladed
- **Shape** : straight pull, bladed
- **Color** : black

WHEEL HUB

- **Front and rear bodies** : aluminum
- **Front and rear bodies** : aluminum
- **Color** : black
- **Front and rear axle material** : steel
- QRM+
- **Front and rear axle material** : steel
- Fixed cog
- QRM+
- Fixed cog

WHEEL WEIGHTS

990