

参照ホイール

112161 KSYRIUM SL 011 FRT

112165 KSYRIUM SL 011 /ED11 PR

112164 KSYRIUM SL 011 /M10 PR

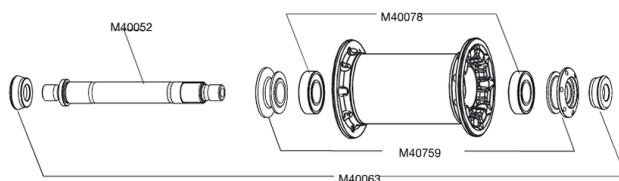

RIMS



&NBSP;:

12021010 FRONT KSYRIUM SL 11 RIM

SPOKES

12030201 12 BLK FRONT SPOKES KSYRIUM SLR/SR/SL 11 285mm

HUB SHELLS

- M40052 FRONT HUB AXLE
- M40759 ADJUST.NUT+CAP XMAX SL CERA FR
- M40078 FRONT HUB 6901 BEARINGS
- M40063 2 FRONT AXLE FORK SUPPORT



Ksyrium SL

Specifications

ホイールの重み