

REFERENCES WHEELS

| | | | |
|--------|---------------------|--------|-------------------------|
| 112162 | KSYRIUM SL 011 M10 | 112164 | KSYRIUM SL 011 /M10 PR |
| 112163 | KSYRIUM SL 011 ED11 | 112165 | KSYRIUM SL 011 /ED11 PR |

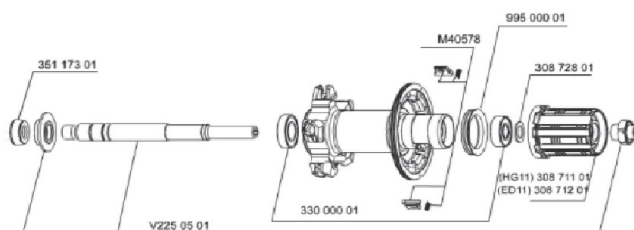

RIMS



| | |
|----------|------------------------|
| 12021013 | REAR KSYRIUM SL 11 RIM |
|----------|------------------------|

SPOKES

| | |
|----------|---|
| 12030301 | KIT 10 DS KSYRIUM SL11 BLACK SPOKE 275mm |
| 12030401 | KIT 10 NDS KSYRIUM SL11 BLACK SPOKE 298mm |

MAVIC *Ksyrium SL*

Specifications

WHEEL WEIGHTS