

参照ホイール

118094	COSMIC CARBONE SL011 M10	118096	COSMIC CARBONE SL011 M10 PR
118095	COSMIC CARBONE SL011 ED11	118097	COSMIC CARBONE SL011 ED11PR

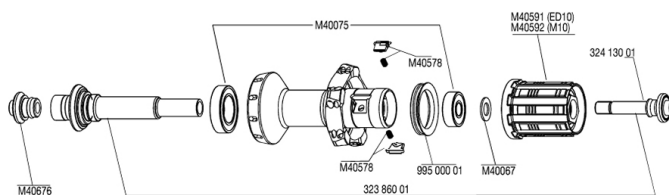

RIMS

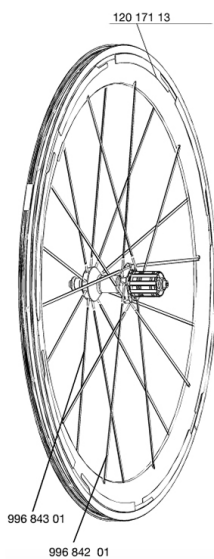

&NBSP;:

12017113	KIT REAR COSMIC CARBONE SL 11 RIM - while stock last
----------	--

SPOKES

99684301	10 SPOKES CARBONE SL 09 OFW 288mm
99684201	10 SPOKES CARBONE SL 09 FW 306mm

HUB SHELLS

32386001	COSMIC CARBONE SL REAR AXLE
32413001	REAR AXLE BOLT M10/ED10
M40591	FTSL FREEWHEEL BODY ED10
M40676	CLIP-ON R.FORK SUPP.KSY.SSC SL
99500001	FTSL/FTSX FREEHUB BODY SEAL
M40578	FTSL PAWLS KIT (ROAD WHEELS)
M40075	REAR HUB 608+6903 BEARINGS
M40592	FTSL FREEWHEEL BODY M10
M40067	10 SPACERS FRW/HUB BODY

MAVIC Cosmic Carbone SL

付属品

BR301 Â¿Â¿Â¿Â¿Â¿Â¿Â¿Â¿Â¿Â¿Â¿Â¿Â¿	
Â¿Â¿Â¿Â¿Â¿Â¿Â¿	
Â¿Â¿Â¿Â¿Â¿Â¿Â¿Â¿Â¿	
Â¿Â¿Â¿Â¿Â¿Â¿Â¿	
Â¿Â¿Â¿Â¿Â¿Â¿Â¿	

Specifications

リム

Â¿Â¿Â¿ MactalÂ¿Â¿Â¿Â¿Â¿Â¿
 Â¿Â¿Â¿
 Â¿Â¿Â¿Â¿Â¿Â¿Â¿12KAÂ¿Â¿Â¿Â¿Â¿Â¿
 Â¿Â¿Â¿Â¿Â¿Â¿Â¿
 Â¿Â¿Â¿Â¿ 52 mm
 Â¿Â¿Â¿Â¿Â¿Â¿Â¿ SUP
 Â¿Â¿Â¿Â¿Â¿Â¿Â¿Â¿Â¿Â¿Â¿
 Â¿Â¿Â¿Â¿Â¿Â¿Â¿ Â¿Â¿Â¿
 Â¿Â¿Â¿Â¿Â¿Â¿Â¿ UBÂ¿Â¿Â¿Â¿
 Â¿Â¿Â¿Â¿ ISM
 Â¿Â¿Â¿Â¿Â¿ 6.5 mm
 Â¿Â¿Â¿Â¿Â¿ Â¿Â¿Â¿Â¿
 ETRTO Â¿Â¿Â¿Â¿ 622x13C
 Â¿Â¿Â¿Â¿Â¿Â¿ 19Â¿28 mm

スポーク

Â¿Â¿Â¿Â¿Â¿
 Â¿Â¿Â¿Â¿ Â¿Â¿Â¿Â¿Â¿Â¿
 Â¿Â¿Â¿Â¿Â¿
 Â¿Â¿Â¿Â¿Â¿ ABS
 Â¿Â¿Â¿Â¿ 16Â¿ 20Â¿
 Â¿Â¿Â¿Â¿Â¿Â¿Â¿ Â¿Â¿Â¿Â¿
 Â¿Â¿Â¿/Â¿Â¿Â¿Â¿Â¿Â¿/2Â¿Â¿

ホイールハブ

Â¿Â¿Â¿/Â¿Â¿Â¿Â¿Â¿
 Â¿Â¿Â¿
 Â¿Â¿Â¿/Â¿Â¿Â¿Â¿
 Â¿
 QRM+
 FTS-LÂ¿Â¿Â¿

ホイールの重み

ホイール重量 (クイックリリー
 スおよびクリンチャー/チュー
 ブラーを除く) (g) : 960