

**REFERENCES WHEELS**

325653 COSMIC CARB SLE 013 FRT WTS

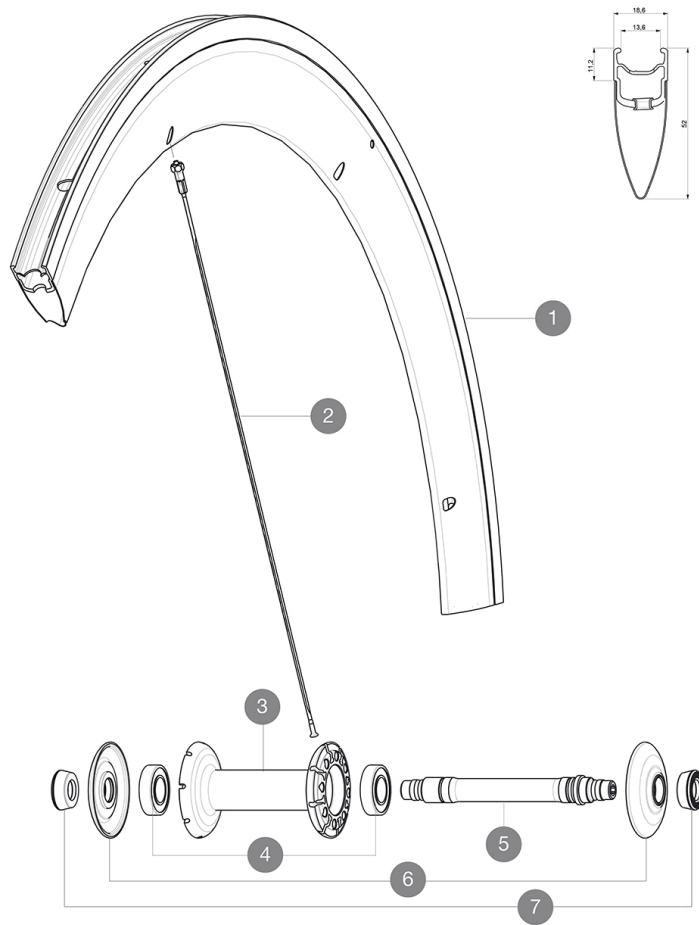

**RIMS**



&NBSP;:

<b>1</b>	30972410	KIT FRONT COSMIC CARBONE SLE 2013 RIM
----------	----------	---------------------------------------

**SPOKES**

<b>2</b>	36644501	KIT 10 FT/NDS COSMIC CARBON SLS BLK SPK 289mm
----------	----------	---

**HUB SHELLS**

<b>4</b>	M40078	FRONT HUB BEARINGS 6901 x 2
<b>5</b>	30870001	FRONT AXLE ROAD RIM BRAKING QRم +
<b>6</b>	32985701	HUB CAP & ADJUSTING NUT CXR 80

**ADAPTERS**

<b>7</b>	35117301	FT/RR FORK REST R-SYS/CC ULTIMATE > 2013/KSY PRO CARB T
----------	----------	---

# MAVIC Cosmic Carbone SLE

## DELIVERED WITH

BR601 quick releases	
BR601 quick releases	
Wheelbags	
Wheelbags	
Exalith brake pads	
Exalith brake pads	
Valve extender	
Multifunction adjustment wrench	
Multifunction adjustment wrench	
User guide	
User guide	

## Specifications

### RIMS

- **Material** : Maxtal and 12K carbon fiber
- **Material** : Maxtal and 12K carbon fiber
- **Height** : 52 mm
- **Color** : carbon
- **Joint** : SUP
- **Height** : 52 mm
- **Joint** : SUP
- **Drilling** : traditional
- **Brake track** : Exalith 2
- **Drilling** : traditional
- **Weight reduction** : ISM
- **Eyelet** : single
- **Valve hole diameter** : 6.5 mm
- **Brake track** : Exalith 2
- **Weight reduction** : ISM
- **Tyre** : clincher
- **Valve hole diameter** : 6.5 mm
- **Tyre** : clincher
- **ETRTO size** : 622x13C
- **ETRTO size** : 622x13C
- **Recommended tyre sizes** : 19 to 28 mm
- **Recommended tyre sizes** : 19 to 28 mm

### SPOKES

- **Material** : steel
- **Material** : steel
- **Shape** : straight pull, bladed, double butted
- **Shape** : straight pull, bladed, double butted
- **Nipples** : ABS, front aluminum, rear brass
- **Color** : black

### WHEEL HUB

- **Front and rear bodies** : aluminum
- **Front and rear bodies** : aluminum
- **Color** : black
- **Front and rear axle material** : aluminum QRM+
- **Front and rear axle material** : aluminum QRM+
- **Front and rear axle material** : aluminum QRM+
- **Front and rear axle material** : aluminum QRM+
- **Front and rear axle material** : aluminum QRM+
- **Front and rear axle material** : aluminum QRM+

### WHEEL WEIGHTS

Wheel weight 730