

REFERENCES WHEELS

325655 COSMIC CARB SLE 013 ED11 WTS

325654 COSMIC CARB SLE 013 M11 WTS

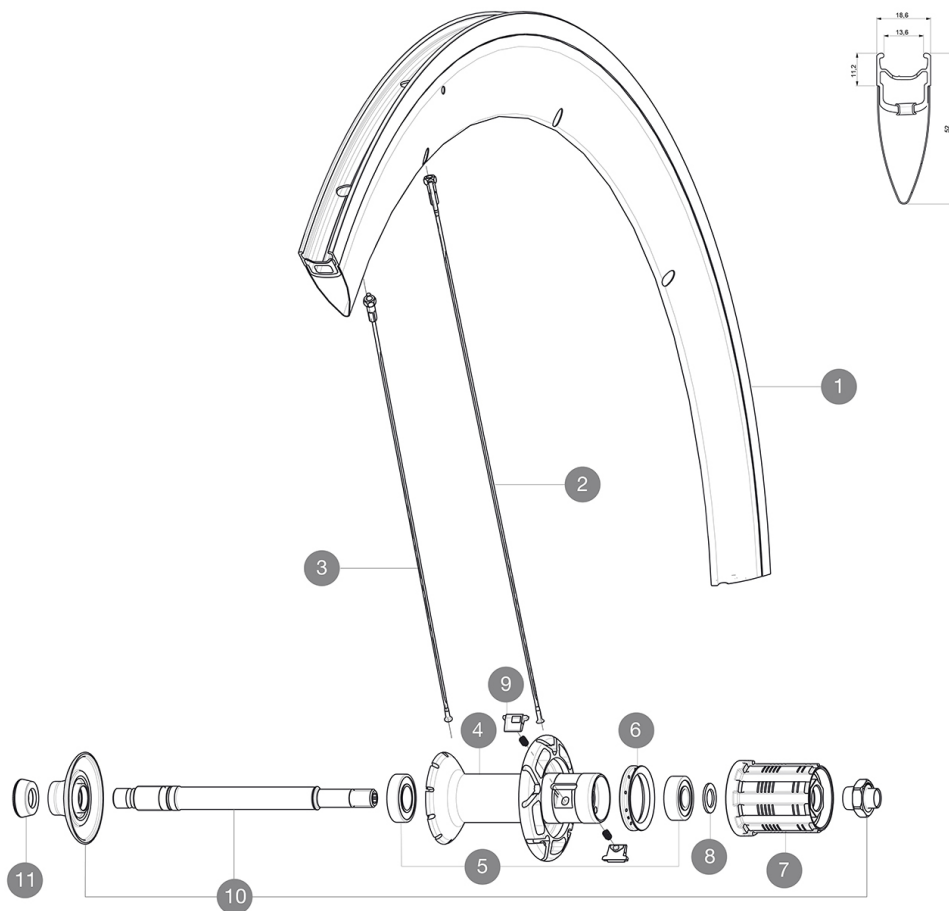

RIMS



&NBSP;:

1 30972413 KIT REAR COSMIC CARBONE SLE 2013 RIM - while stock last

SPOKES

2 36644401 KIT 10 DS COSMIC CARBON SLS BLK SPK 287mm

3 36644501 KIT 10 FT/NDS COSMIC CARBON SLS BLK SPK 289mm

HUB SHELLS

5 33000001 REAR HUB B9+6901 BEARINGS 2013

6 99500001 FTSL/FTSX FREEHUB BODY SEAL

7 30871101 FTS-L ROAD FREEWHEEL BODY HG11 8/9 compatible

7 30871201 FTS-L ROAD FREEWHEEL BODY ED11 8/9 compatible

8 30872801 SET OF 3 INTERNAL SILVER SPACERS 9mm FTS-L

9 M40578 FTSL PAWLS KIT (ROAD WHEELS)

10 V2250301 KIT REAR AXLE AERO HUB CXR/CC40/CC SLS/CC SLE/COSMIC PRO CAR

12 V2373101 KIT NUT FOR ROAD ALLOY THROUGH AXLE 9mm

ADAPTERS

11 35117301 FT/RR FORK REST R-SYS/CC ULTIMATE > 2013/KSY PRO CARB T

MAVIC Cosmic Carbone SLE

DELIVERED WITH

BR601 quick releases	
BR601 quick releases	
Wheelbags	
Wheelbags	
Exalith brake pads	
Exalith brake pads	
Valve extender	
Multifunction adjustment wrench	
Multifunction adjustment wrench	
User guide	
User guide	

Specifications

RIMS

- **Material** : Maxtal and 12K carbon fiber
- **Material** : Maxtal and 12K carbon fiber
- **Color** : carbon
- **Height** : 52 mm
- **Joint** : SUP
- **Height** : 52 mm
- **Drilling** : traditional
- **Joint** : SUP
- **Brake track** : Exalith 2
- **Drilling** : traditional
- **Weight reduction** : ISM
- **Eyelet** : single
- **Valve hole diameter** : 6.5 mm
- **Brake track** : Exalith 2
- **Weight reduction** : ISM
- **Tyre** : clincher
- **Valve hole diameter** : 6.5 mm
- **Tyre** : clincher
- **ETRTO size** : 622x13C
- **ETRTO size** : 622x13C
- **Recommended tyre sizes** : 19 to 28 mm
- **Recommended tyre sizes** : 19 to 28 mm

SPOKES

- **Material** : steel
- **Material** : steel
- **Shape** : straight pull, bladed, double butted
- **Shape** : straight pull, bladed, double butted
- **Nipples** : ABS, front aluminum, rear brass
- **Color** : black

WHEEL HUB

- **Front and rear bodies** : aluminum
- **Front and rear bodies** : aluminum
- **Color** : black
- **Front and rear axle material** : aluminum QRM+
- **Front and rear axle material** : aluminum FTS-L steel QRM+
- **Front and rear axle material** : aluminum FTS-L steel QRM+

WHEEL WEIGHTS

Wheel weight 890