

## REFERENCES WHEELS

326546 KSYRIUM SLR 013 FRT WTS

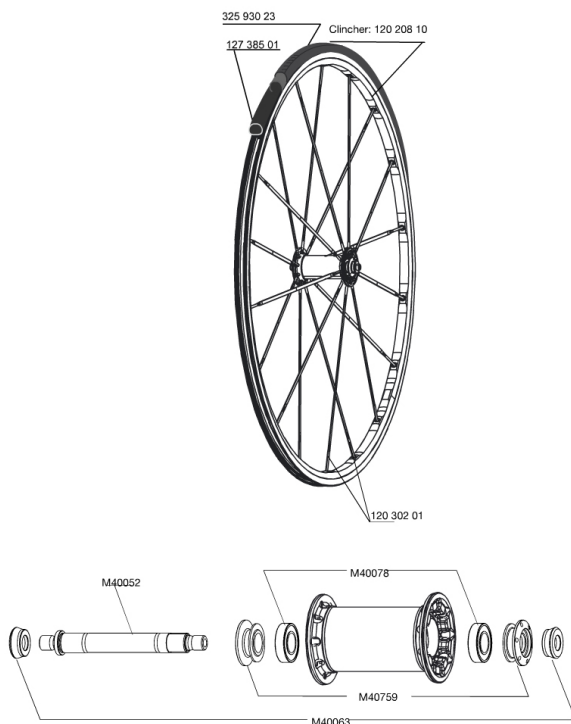

### RIMS



&nbsp;:

12020810 KIT FRONT KSYRIUM SLR CLINCHER RIM

### SPOKES

12030201 KIT 12 FT KSYRIUM SLR/SR/SL 11 BLK SPK 285mm

### HUB SHELLS

M40052 FRONT HUB AXLE  
M40759 ADJUSTING BEARING NUT + FRONT CAP  
M40078 FRONT HUB BEARINGS 6901 x 2  
M40063 2 FRONT AXLE FORK SUPPORT

### MAINTENANCE

12738501 Road Innertube Presta 48mm

### TYRES

32593023 YksionProSSCGripLink 23

# MAVIC Ksyrium SLR

## DELIVERED WITH

|                                 |  |
|---------------------------------|--|
| BR601 quick releases            |  |
| BR601 quick releases            |  |
| Wheelbags                       |  |
| Wheelbags                       |  |
| Exalith brake pads              |  |
| Exalith brake pads              |  |
| Computer magnet (front wheel)   |  |
| Computer magnet (front wheel)   |  |
| Multifonction adjustment wrench |  |
| Multifonction adjustment wrench |  |
| Tracomp ring tool               |  |
| Tracomp ring tool               |  |
| User guide                      |  |
| User guide                      |  |

## Specifications

### RIMS

- **Material** : Mxstal
- **Material** : Mxstal
- **Height** : front 22 mm, rear 25 mm asymmetrical
- **Color** : Exalith
- **Height** : front 22 mm, rear 25 mm asymmetrical
- **Joint** : SUP
- **Drilling** : Fore
- **Joint** : SUP
- **Drilling** : Fore
- **Brake track** : Exalith 2
- **Weight reduction** : ISM
- **Brake track** : Exalith 2
- **Valve hole diameter** : 6,5 mm
- **Weight reduction** : ISM
- **Type** : clincher

### WHEEL HUB

- **Front and rear bodies** : aluminum
- **Front and rear bodies** : aluminum
- **Front and rear axle material** : aluminum
- **Color** : front carbon center tube with black flanges, rear black
- **Front and rear axle material** : aluminum
- QRM+
- FTS-L steel
- QRM+
- FTS-L steel

### WHEEL WEIGHTS

Wheel weight 630