

参照ホイール

326548 KSYRIUM SLR 013 ED11 WTS

326547 KSYRIUM SLR 013 M11 WTS

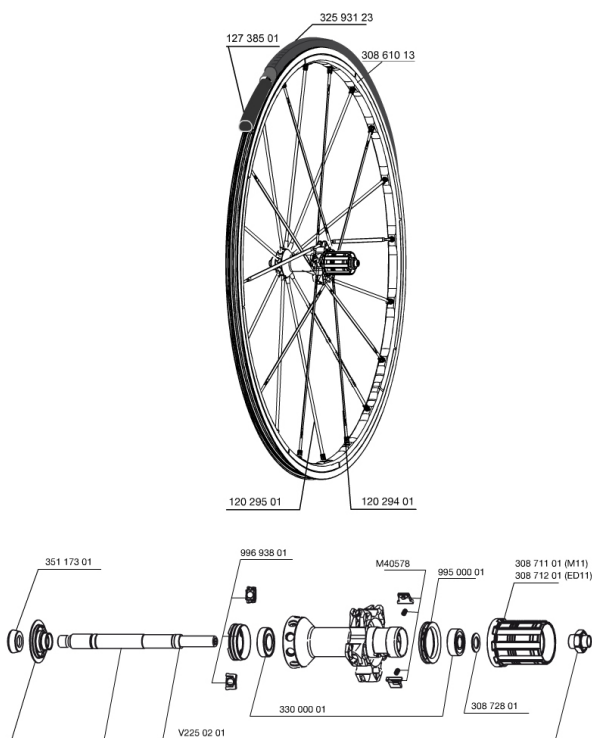

RIMS



&NBSP;:

30861013	REAR KSYRIUM SLR CLINCHER RIM
----------	-------------------------------

SPOKES

99693801	2 SILVER TRACOMP RINGS + CLIPS
12029501	10 BLK OPP.DRIVE SIDE SPK R-SYS SLR CLINCH.284mm
12029401	10 BLK DRIVE SIDE SPOKES R-SYS SLR CLINCH.294mm

HUB SHELLS

30871201	FTS-L FREEWHEEL BODY ED11 2013 (8 or 9mm axle compatible)
V2250201	Axle Kit Rsys
33000001	REAR HUB B9+6901 BEARINGS 2013
30871101	FTS-L FREEWHEEL BODY HG11 2013 (8 or 9mm axle compatible)
99500001	FTSL/FTSX FREEHUB BODY SEAL
30872801	SET OF 3 INTERNAL SILVER SPACERS 9mm FTS-L 2013
M40578	FTSL PAWLS KIT (ROAD WHEELS)

MAINTENAN

CE

12738501	Road Innertube Presta 48mm
----------	----------------------------

TYRES

32593123	YksionProSSCPowerLink 23
----------	--------------------------

ADAPTERS

35117301	FRONT OR REAR FORK REST KIT R-SYS 2013
----------	--

MAVIC Ksyrium SLR

付属品

BR601 Â¿Â¿Â¿Â¿Â¿Â¿Â¿Â¿Â¿Â¿Â¿Â¿	
BR601 Â¿Â¿Â¿Â¿Â¿Â¿Â¿Â¿Â¿Â¿Â¿Â¿	
Â¿Â¿Â¿Â¿Â¿Â¿	
Â¿Â¿Â¿Â¿Â¿Â¿	
Â¿Â¿Â¿Â¿Â¿Â¿Â¿Â¿Â¿Â¿Â¿Â¿	
Â¿Â¿Â¿Â¿Â¿Â¿Â¿Â¿Â¿Â¿Â¿Â¿	
Â¿Â¿Â¿Â¿Â¿Â¿Â¿Â¿Â¿Â¿Â¿Â¿ ¿Â¿Â¿Â¿Â¿Â¿Â¿Â¿Â¿	
Â¿Â¿Â¿Â¿Â¿Â¿Â¿Â¿Â¿Â¿Â¿Â¿ ¿Â¿Â¿Â¿Â¿Â¿Â¿Â¿Â¿	
Â¿Â¿Â¿Â¿Â¿Â¿	
Â¿Â¿Â¿Â¿Â¿Â¿	
Â¿Â¿Â¿Â¿Â¿Â¿Â¿Â¿Â¿Â¿	
Â¿Â¿Â¿Â¿Â¿Â¿Â¿Â¿Â¿Â¿	
Â¿Â¿Â¿Â¿Â¿Â¿	
Â¿Â¿Â¿Â¿Â¿Â¿	

Specifications

リム
 Â¿Â¿Â¿ MaxtalÂ¿Â¿Â¿Â¿Â¿Â¿
 Â¿Â¿Â¿ MaxtalÂ¿Â¿Â¿Â¿Â¿Â¿
 Â¿Â¿Â¿Â¿Â¿Â¿ 22 mmÂ¿Â¿Â¿ 25 mm
 Â¿Â¿Â¿Â¿Â¿Â¿
 Â¿Â¿Â¿Â¿Â¿Â¿Â¿Â¿
 Â¿Â¿Â¿Â¿Â¿Â¿Â¿ SUP
 Â¿Â¿Â¿Â¿Â¿Â¿ 22 mmÂ¿Â¿Â¿ 25 mm
 Â¿Â¿Â¿Â¿Â¿Â¿
 Â¿Â¿Â¿Â¿Â¿Â¿Â¿Â¿Â¿ FORE
 Â¿Â¿Â¿Â¿Â¿Â¿
 Â¿Â¿Â¿Â¿Â¿Â¿Â¿ SUP
 Â¿Â¿Â¿Â¿Â¿Â¿Â¿Â¿Â¿ FORE
 Â¿Â¿Â¿Â¿Â¿Â¿
 Â¿Â¿Â¿Â¿Â¿Â¿Â¿ Â¿Â¿Â¿Â¿Â¿Â¿Â¿2
 Â¿Â¿Â¿Â¿Â¿Â¿ ISM
 Â¿Â¿Â¿Â¿Â¿Â¿Â¿Â¿Â¿Â¿Â¿Â¿2
 Â¿Â¿Â¿Â¿Â¿Â¿Â¿ 6.5 mm

ホイールハブ
 Â¿Â¿Â¿Â¿/Â¿Â¿Â¿Â¿Â¿Â¿Â¿Â¿
 Â¿Â¿Â¿Â¿/Â¿Â¿Â¿Â¿Â¿Â¿Â¿Â¿
 Â¿Â¿Â¿Â¿/Â¿Â¿Â¿Â¿Â¿Â¿Â¿Â¿
 Â¿Â¿Â¿
 Â¿Â¿Â¿Â¿ Â¿Â¿Â¿Â¿/Â¿Â¿Â¿Â¿Â¿Â¿
 ¿Â¿Â¿Â¿Â¿Â¿Â¿Â¿Â¿Â¿Â¿
 ¿Â¿Â¿/Â¿Â¿Â¿
 QRM+
 Â¿Â¿Â¿Â¿/Â¿Â¿Â¿Â¿Â¿Â¿Â¿Â¿
 Â¿Â¿
 FTS-LÂ¿Â¿Â¿Â¿
 QRM+
 FTS-LÂ¿Â¿Â¿Â¿
ホイールの重み
 ホイール重量 (クイックリリー
 フォトマウントチャーム)