

## REFERENCES WHEELS

326548 KSYRIUM SLR 013 ED11 WTS

326547 KSYRIUM SLR 013 M11 WTS

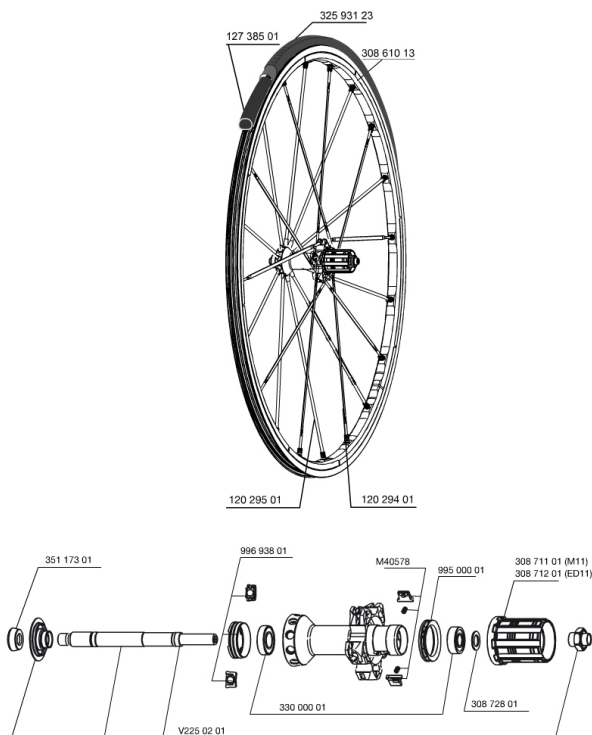

## RIMS



&NBSP;:

30861013 KIT REAR KSYRIUM SLR CLINCHER RIM

## SPOKES

12029401 KIT 10 DS R-SYS SL/SLR CLINC BLK SPK 294,5mm

99693801 2 SILVER TRACOMP RINGS + CLIPS

12029501 KIT 10 NDS R-SYS SLR CLINC BLACK SPOKE 284mm

## HUB SHELLS

30872801 SET OF 3 INTERNAL SILVER SPACERS 9mm FTS-L

M40578 FTSL PAWLS KIT (ROAD WHEELS)

30871201 FTS-L ROAD FREEWHEEL BODY ED11 8/9 compatible

V2250201 KIT REAR AXLE KSYRIUM SLR/K125/R-SYS/ELITE 16

33000001 REAR HUB B9+6901 BEARINGS 2013

30871101 FTS-L ROAD FREEWHEEL BODY HG11 8/9 compatible

99500001 FTSL/FTSX FREEHUB BODY SEAL

## MAINTENANCE

12738501 Road Innertube Presta 48mm

## TYRES

32593123 YksionProSSCPowerLink 23

## ADAPTERS

35117301 FT/RR FORK REST R-SYS/CC ULTIMATE > 2013/KSY PRO CARB T

# MAVIC Ksyrium SLR

## DELIVERED WITH

BR601 quick releases	
BR601 quick releases	
Wheelbags	
Wheelbags	
Exalith brake pads	
Exalith brake pads	
Computer magnet (front wheel)	
Computer magnet (front wheel)	
Multifonction adjustment wrench	
Multifonction adjustment wrench	
Tracomp ring tool	
Tracomp ring tool	
User guide	
User guide	

## Specifications

### RIMS

- **Material** : Mactal
- **Material** : Mactal
- **Height** : front 22 mm, rear 25 mm asymmetrical
- **Color** : Exalith
- **Joint** : SUP
- **Height** : front 22 mm, rear 25 mm asymmetrical
- **Joint** : SUP
- **Drilling** : Fore
- **Brake track** : Exalith 2
- **Drilling** : Fore
- **Weight reduction** : ISM
- **Brake track** : Exalith 2
- **Valve hole diameter** : 6,5 mm
- **Tyre** : clincher
- **Weight reduction** : ISM

### WHEEL HUB

- **Front and rear bodies** : aluminum
- **Front and rear bodies** : aluminum
- **Color** : front carbon center tube with black flanges, rear black
- **Front and rear axle material** : aluminum QRM+
- **Front and rear axle material** : aluminum FTS-L steel QRM+
- **Front and rear axle material** : aluminum FTS-L steel QRM+

### WHEEL WEIGHTS

Wheel weight 780