

## REFERENCES WHEELS

327910 CROSSMAX ST 29 D6IREAR12/9mm

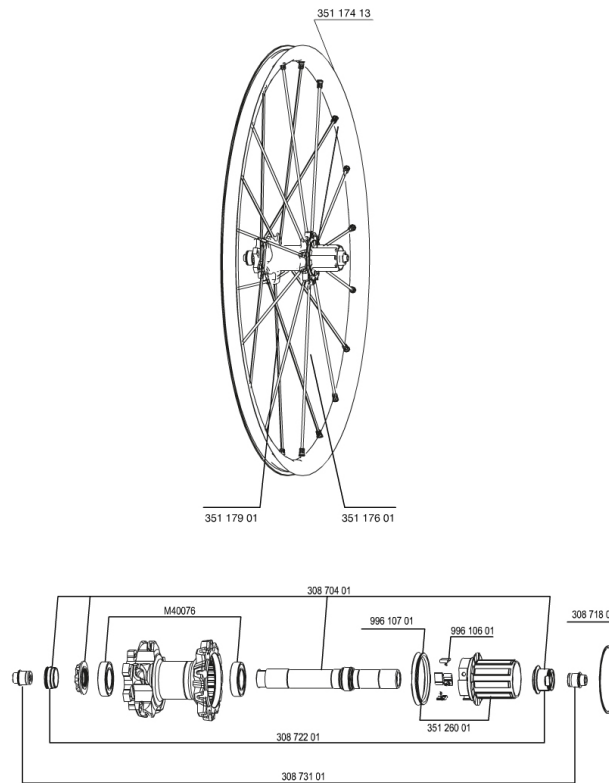

## RIMS



&NBSP;:

35117413	"KIT REAR CROSSMAX ST 29"" RIM"
----------	---------------------------------

## SPOKES

35117901	"KIT 10 NDS M7/7 CROSSMAX ST 29"" SPK 300,5mm"
35117601	"KIT 10 DS M7/7 CROSSMAX ST 29"" SPK 270,5mm"

## HUB SHELLS

99610701	ITS-4 FREEWHEEL SEAL
35126001	ITS-4 FREEWHEEL BODY + SEAL 2013 (NO PAWLS)
30871801	ELASTIC RING 56mm diam. ITS-4 20 SPOKES
99610601	PAWLS KIT FOR ITS-4 (OR TS-2)
30870401	REAR QRM + AXLE KIT ITS4 135mm from 2012
M40076	HUB BEARINGS 17x30x7 6903 x 2

## ADAPTERS

30872201	FRAME SUPPORT ITS-4 135mm REAR AXLE > 2012
30873101	2 REAR REDUCERS 12/9,5mm 2012 ITS4 HUB

**MAVIC** *Crossmax ST 29***DELIVERED WITH**

BX601 rear quick release	
UST valve and accessories	
Front 15 mm adapters	
Rear QR adapters	
Rear 12x142mm adapters	
Specific disc bolts	
Computer magnet (front wheel)	
Multifunction adjustment wrench	
User guide	

**Specifications****RIMS**

- **Material** : Mactal
  - **Color** : black anodized
  - **Joint** : SUP
  - **Drilling** : Fore
- Disc brake specific profile
- **Weight reduction** : ISM
  - **Valve hole diameter** : 6.5 mm
  - **Tyre** : UST Tubeless and tubetype
  - **Internal width** : 19 mm
  - **Internal width** : 19 mm, asymmetrical
  - **ETRTO size** : 622x19C
  - **Recommended tyre sizes** : 1.5 to 2.3

**SPOKES**

- **Material** : Zicral
- **Shape** : straight pull, round
- **Color** : black + 1 half black / half white
- **Nipples** : integrated M7 aluminum with brake rings
- **Count** : 24 front and 20 rear
- **Lacing** : front crossed 2, rear Isopulse

**WHEEL HUB**

- **Front and rear bodies** : oversize aluminum
- **Color** : white
- **Front and rear axle material** : aluminum QRM+ ITS-4 alloy

**WHEEL WEIGHTS**

Wheel weight 885