

REFERENCES WHEELS

327910 CROSSMAX ST 29 D6IREAR12/9mm

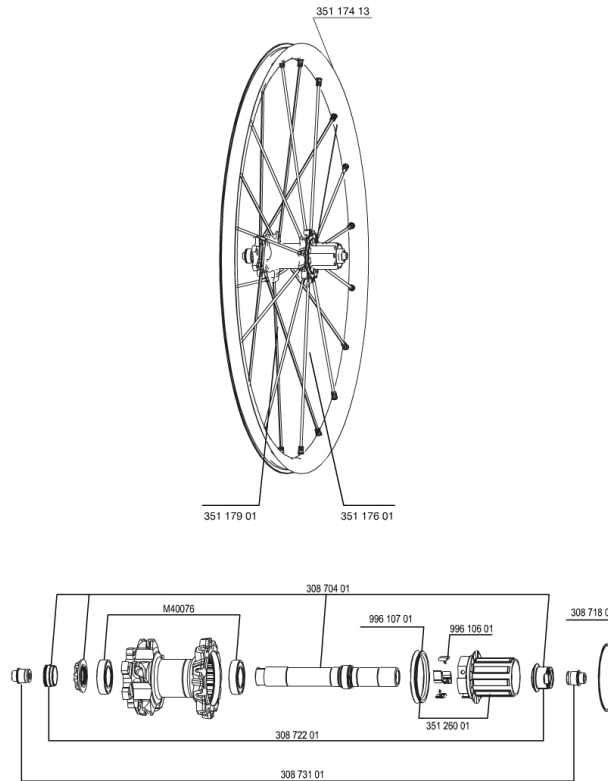

RIMS



&NBSP;:

35117413	"KIT REAR CROSSMAX ST 29"" RIM"
----------	---------------------------------

SPOKES

35117901	"KIT 10 NDS M7/7 CROSSMAX ST 29"" SPK 300,5mm"
35117601	"KIT 10 DS M7/7 CROSSMAX ST 29"" SPK 270,5mm"

HUB SHELLS

99610701	ITS-4 FREEWHEEL SEAL
35126001	ITS-4 FREEWHEEL BODY + SEAL 2013 (NO PAWLS)
30871801	ELASTIC RING 56mm diam. ITS-4 20 SPOKES
99610601	PAWLS KIT FOR ITS-4 (OR TS-2)
30870401	REAR QRM + AXLE KIT ITS4 135mm from 2012
M40076	HUB BEARINGS 17x30x7 6903 x 2

ADAPTERS

30872201	FRAME SUPPORT ITS-4 135mm REAR AXLE > 2012
30873101	2 REAR REDUCERS 12/9,5mm 2012 ITS4 HUB

MAVIC *Crossmax ST 29***DELIVERED WITH**

BX601 rear quick release	
UST valve and accessories	
Front 15 mm adapters	
Rear QR adapters	
Rear 12x142mm adapters	
Specific disc bolts	
Computer magnet (front wheel)	
Multifunction adjustment wrench	
User guide	

Specifications**RIMS**

- **Material** : Mactal
 - **Color** : black anodized
 - **Joint** : SUP
 - **Drilling** : Fore
- Disc brake specific profile
- **Weight reduction** : ISM
 - **Valve hole diameter** : 6.5 mm
 - **Tyre** : UST Tubeless and tubetype
 - **Internal width** : 19 mm
 - **Internal width** : 19 mm, asymmetrical
 - **ETRTO size** : 622x19C
 - **Recommended tyre sizes** : 1.5 to 2.3

SPOKES

- **Material** : Zicral
- **Shape** : straight pull, round
- **Color** : black + 1 half black / half white
- **Nipples** : integrated M7 aluminum with brake rings
- **Count** : 24 front and 20 rear
- **Lacing** : front crossed 2, rear Isopulse

WHEEL HUB

- **Front and rear bodies** : oversize aluminum
 - **Color** : white
 - **Front and rear axle material** : aluminum QRM+
- ITS-4 alloy

WHEEL WEIGHTS

Wheel weight 885