

REFERENCES WHEELS

F14501 Ksyrium Pro Disc Ft CL

F01701 Ksyrium Pro Disc Ft INT

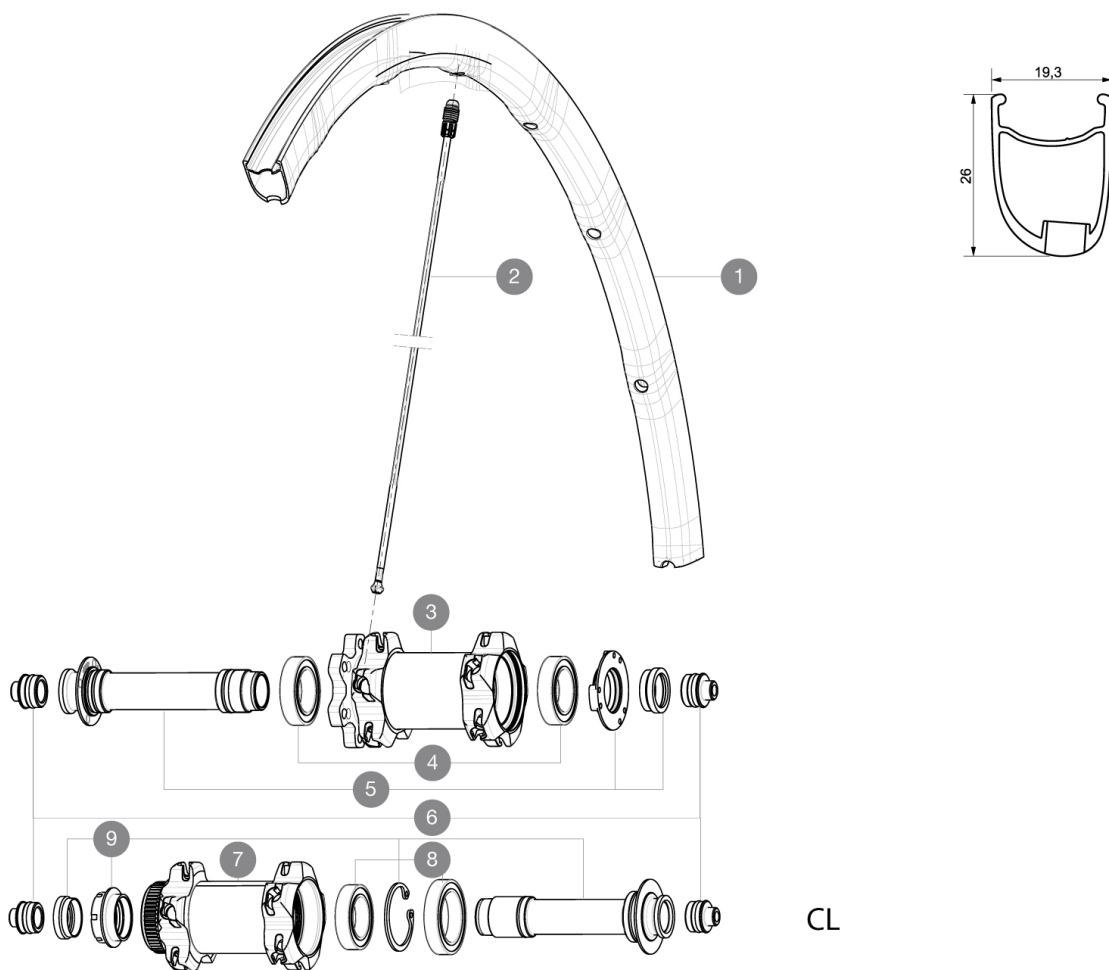

RIMS



VALVE HOLE \bar{A} (MM): 6.5 :

1 V2290510 KIT FRONT RIM KSYRIUM PRO DISC

SPOKES

2 12029401 KIT 10 DS R-SYS SL/SLR CLINC BLK SPK 294,5mm

HUB SHELLS

3	N/A	HUB BODY
4	99688501	BEARING KIT 9/12/15 D6T HUB 20x32x7 6804
5	99688201	9/15 6B FRT AXLE CROSSMAX/KSY PRO CARBON SL C
7	N/A	HUB BODY
8	99688601	BEARING KIT 9/15 DCL HUB 20x32x7 6804 + 25x37x7 6805
9	99688301	9/15 CL FRT AXLE CROSSMAX/KSY PRO CARBON SL C

ADAPTERS

6 99694101 ADAPTER Ft 15 to 9mm QR

MAVIC Ksyrium Pro Disc

DELIVERED WITH

BX601 quick releases	
Front QR adapters	
Specific disc bolts	
Computer magnet (front wheel)	
Multifonction adjustment wrench	
User guide	

Specifications

RIMS

- **Material** : Mxtral
 - **Height** : 26mm, asymmetrical
 - **Joint** : SUP
 - **Drilling** : Fore
- Disc brake specific profile
- **Weight reduction** : ISM4D
 - **Valve hole diameter** : 6.5 mm
 - **Tyre** : clincher
 - **ETRTO size** : 622x15C
 - **Recommended tyre sizes** : 19 to 32 mm

SPOKES

- **Material** : Zicral
- **Shape** : straight pull, bladed
- **Nipples** : Fore integrated aluminum
- **Count** : 20 front and rear
- **Lacing** : front crossed 2, rear Isopulse

WHEEL HUB

- **Front body** : carbon with aluminum flanges
 - **Rear body** : aluminum
 - **Axle material** : aluminum
- Adjustable sealed cartridge bearings
- **Freewheel** : FTS-L steel

WHEEL WEIGHTS

Wheel weight 680