

## REFERENCES WHEELS

F14501 Ksyrium Pro Disc Ft CL

F01701 Ksyrium Pro Disc Ft INT

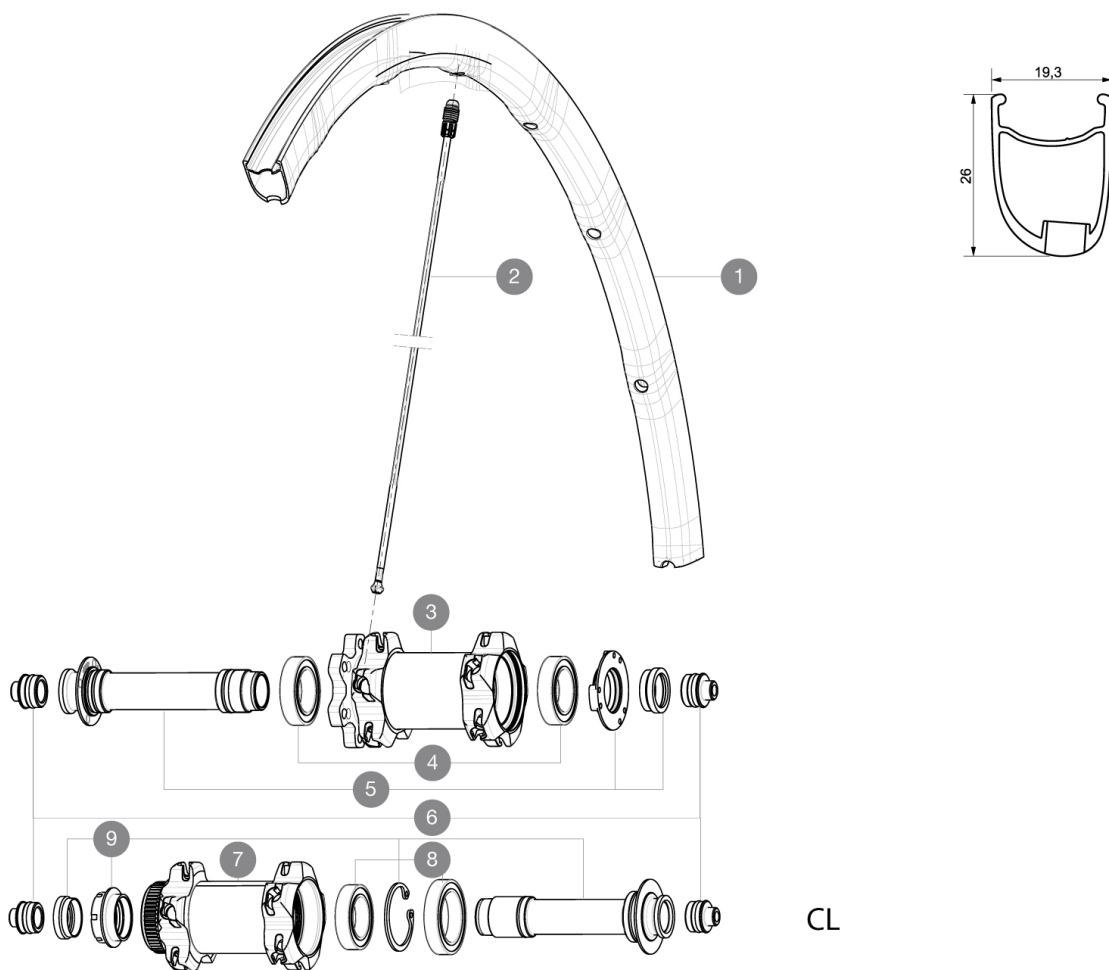

## RIMS



VALVE HOLE  $\bar{A}$  (MM): 6.5 :

1 V2290510 KIT FRONT RIM KSYRIUM PRO DISC

## SPOKES

2 12029401 KIT 10 DS R-SYS SL/SLR CLINC BLK SPK 294,5mm

## HUB SHELLS

3	N/A	HUB BODY
4	99688501	BEARING KIT 9/12/15 D6T HUB 20x32x7 6804
5	99688201	9/15 6B FRT AXLE CROSSMAX/KSY PRO CARBON SL C
7	N/A	HUB BODY
8	99688601	BEARING KIT 9/15 DCL HUB 20x32x7 6804 + 25x37x7 6805
9	99688301	9/15 CL FRT AXLE CROSSMAX/KSY PRO CARBON SL C

## ADAPTERS

6 99694101 ADAPTER Ft 15 to 9mm QR

# MAVIC Ksyrium Pro Disc

## DELIVERED WITH

BX601 quick releases	
Front QR adapters	
Specific disc bolts	
Computer magnet (front wheel)	
Multifonction adjustment wrench	
User guide	

## Specifications

### RIMS

- **Material** : Mxxtal
  - **Height** : 26mm, asymmetrical
  - **Joint** : SUP
  - **Drilling** : Fore
- Disc brake specific profile
- **Weight reduction** : ISM4D
  - **Valve hole diameter** : 6.5 mm
  - **Tyre** : clincher
  - **ETRTO size** : 622x15C
  - **Recommended tyre sizes** : 19 to 32 mm

### SPOKES

- **Material** : Zicral
- **Shape** : straight pull, bladed
- **Nipples** : Fore integrated aluminum
- **Count** : 20 front and rear
- **Lacing** : front crossed 2, rear Isopulse

### WHEEL HUB

- **Front body** : carbon with aluminum flanges
  - **Rear body** : aluminum
  - **Axle material** : aluminum
- Adjustable sealed cartridge bearings
- **Freewheel** : FTS-L steel

### WHEEL WEIGHTS

Wheel weight 680