

REFERENCES WHEELS

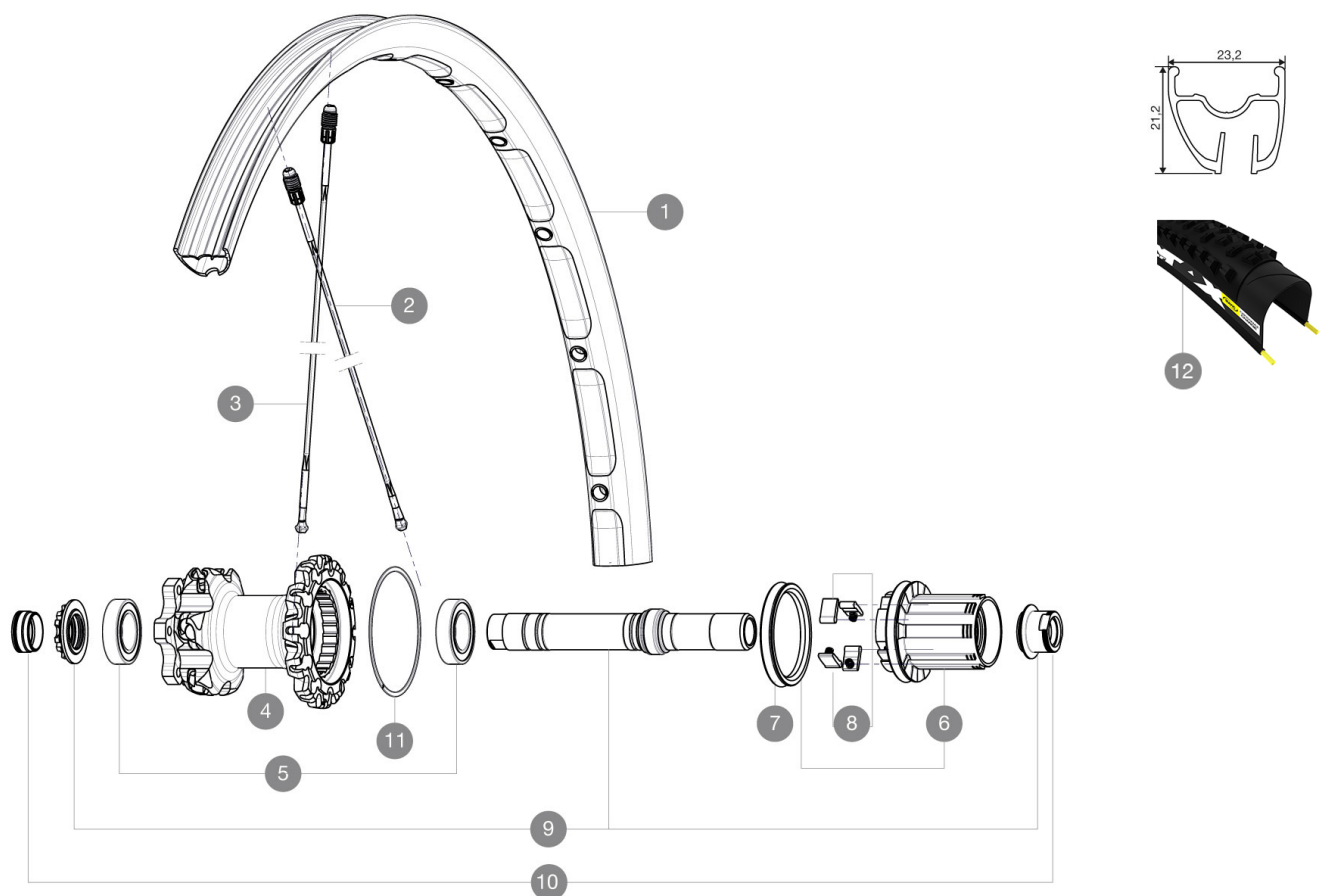

RIMS



&NBSP;:

1	36646713	"KIT REAR CROSSMAX ENDURO 26"" RIM"
---	----------	-------------------------------------

SPOKES

2	36647201	KIT 10 DS CROSSMAX ENDURO ALU SPK 239mm
3	36647101	KIT 10 NDS CROSSMAX ENDURO ALU SPK 269mm

HUB SHELLS

4	N/A	HUB BODY
5	M40076	HUB BEARINGS 17x30x7 6903 x 2
6	35126001	ITS-4 FREEWHEEL BODY + SEAL 2013 (NO PAWLS)
7	99610701	ITS-4 FREEWHEEL SEAL
8	99610601	PAWLS KIT FOR ITS-4 (OR TS-2)
9	30870401	REAR QRM + AXLE KIT ITS4 135mm from 2012
11	30871801	ELASTIC RING 56mm diam. ITS-4 20 SPOKES

TYRES

12	35629723	Crossmax Roam XL 26
----	----------	---------------------

ADAPTERS

10	30872201	FRAME SUPPORT ITS-4 135mm REAR AXLE > 2012
----	----------	--

MAVIC Crossmax Enduro WTS

DELIVERED WITH

BX601 rear quick release	
UST valve and accessories	
Front 15 mm adapters	
Front 20 mm adapters	
Rear QR adapters	
Rear 12x142mm adapters	
Specific disc bolts	
Multifunction adjustment wrench	
User guide	

Specifications

RIMS

- **Material** : Mactal
 - **Joint** : SUP
 - **Drilling** : Fore
- Disc brake specific profile
- **Weight reduction** : ISM
 - **Valve hole diameter** : 6.5 mm
 - **Tyre** : UST Tubeless and tubetype
 - **Internal width** : 21 mm front and 19mm rear
 - **ETRTO size 26"** : 559x21C front & 559x19C rear
 - **ETRTO size 650b/27.5"** : 584x21C front & 584x19C rear
 - **Recommended tyre sizes** : 2.0 to 2.5

SPOKES

- **Material** : Zicral
- **Shape** : straight pull, bladed
- **Nipples** : Fore integrated aluminum
- **Count** : 24 front and 20 rear
- **Lacing** : front crossed 2, rear Isopulse

WHEEL HUB

- **Front and rear bodies** : aluminum
 - **Axle material** : aluminum
- Adjustable sealed cartridge bearings
- **Freewheel** : ITS-4 alloy
- Shimano 11 speeds compatible
XD Compatible (XX1-X01) with optional kit

WHEEL WEIGHTS

Weight Rear 26": 835
Weight Rear 27.5": 860