

REFERENCES WHEELS

F02801 Crossmax XL 26Ft WTS

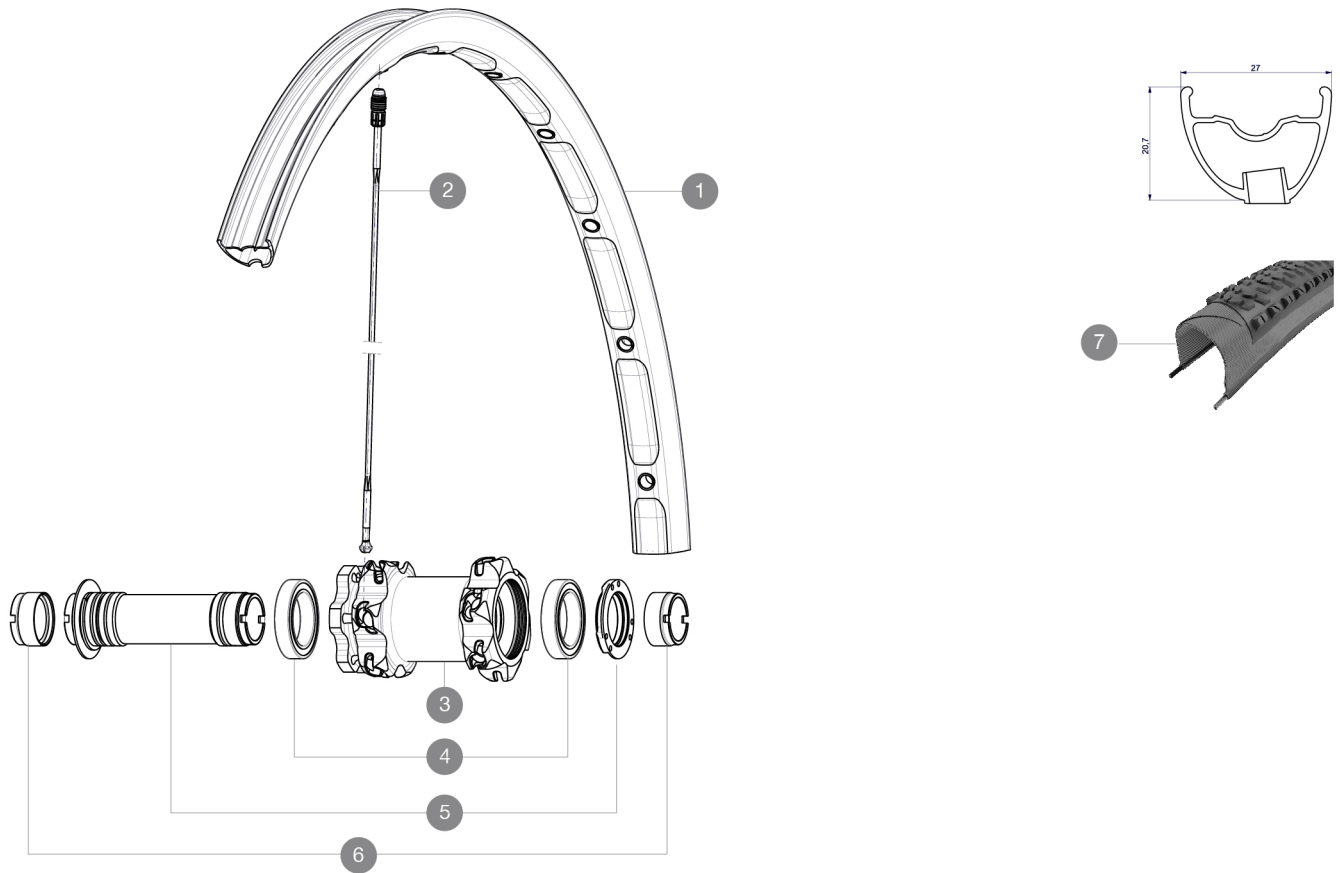

RIMS



VALVE HOLE \varnothing (MM): 6.5 :

1	V2310710	KIT FRONT RIM CROSSMAX XL 2015 26"
---	----------	------------------------------------

SPOKES

2	36646801	KIT 12 FT CROSSMAX ENDURO ALU SPK 261,5mm
---	----------	---

HUB SHELLS

3	N/A	HUB BODY
4	M40179	FRONT BEARING 25x37x7 20mm AXLE
5	30870501	FRONT AXLE 20mm CROSSMAX + DEEMAX ULTI 2012

ADAPTERS

6	12982901	ADAPTER Ft 20x110mm
---	----------	---------------------

MAVIC *Crossmax XL WTS***DELIVERED WITH**

BX601 rear quick release	
UST valve and accessories	
Front 15 mm adapters	
Rear QR adapters	
Rear 12x142mm adapters	
Specific disc bolts	
Computer magnet (front wheel)	
Multifunction adjustment wrench	
User guide	

Specifications**RIMS**

- **Material** : Mxstal
- **Drilling** : Fore
- **Weight reduction** : ISM
- **Tyre** : UST Tubeless and tubetype
- **Internal width** : 23 mm
- **ETRTO size 26"** : 559x23C
- **ETRTO size 27.5"** : 584x23C
- **ETRTO size 29"** : 622x23C

SPOKES

- **Material** : Zicral
- **Shape** : straight pull, round
- **Nipples** : Fore integrated aluminum
- **Count** : 24 front and rear
- **Lacing** : front crossed 2, rear Isopulse

WHEEL HUB

- **Front and rear bodies** : aluminum
 - **Axle material** : aluminum
- Adjustable sealed cartridge bearings
- **Freewheel** : ITS-4 alloy
- Shimano 11 speeds compatible
XD Compatible (XX1-X01) with optional kit

WHEEL WEIGHTS

Wheel weight
Weight Front 26": 790
Weight Front 27.5": 815
Weight Front 29": 850