

REFERENCES WHEELS

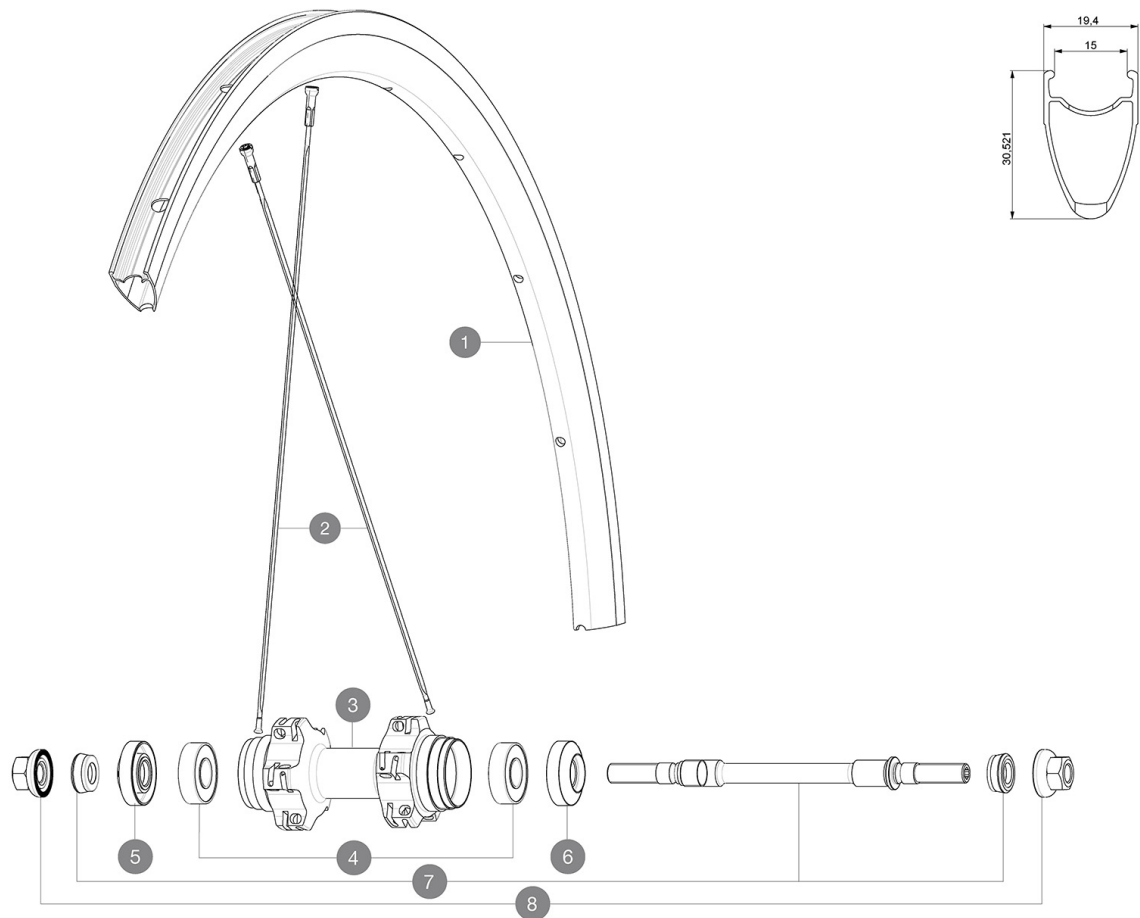

RIMS



&NBSP;:

1 12033415 KIT FRONT/REAR ELLIPSE 11 RIM

SPOKES

2 12033801 KIT 10 REAR ELLIPSE 11 BLACK SPOKE 296mm

HUB SHELLS

3	N/A	HUB BODY
4	M40318	KIT 2 HUB BEARINGS 6001
5	M40447	ADJUSTING CAP BLACK FOR ELLIPSE
6	M40448	BLACK REAR HUB CAP ELLIPSE
7	32386201	ELLIPSE REAR AXLE + FORK SUPPORTS
8	32388601	2 AXLE BOLTS RR COMETE TRACK/ELLIPSE FT-RR M9

MAVIC *Ellipse***DELIVERED WITH**

Fixing nuts	
Rim tape	
Valve extender	
Cog lock nut	
Multifonction adjustment wrench	
User guide	

Specifications**RIMS**

- **Material** : S6000 Aluminum
- **Height** : 30 mm
- **Joint** : SUP
- **Drilling** : traditional
- **Valve hole diameter** : 6.5 mm
- **Tyre** : clincher
- **ETRTO size** : 622x15C
- **Recommended tyre sizes** : 19 to 28 mm

SPOKES

- **Material** : steel
- **Shape** : straight pull, bladed
- **Nipples** : brass, ABS
- **Count** : 20 front and rear
- **Lacing** : front radial, rear crossed 2

WHEEL HUB

- **Front and rear bodies** : aluminum
- **Axle material** : steel
- Adjustable sealed cartridge bearings
- Fixed cog

WHEEL WEIGHTS

990