

参照ホイール

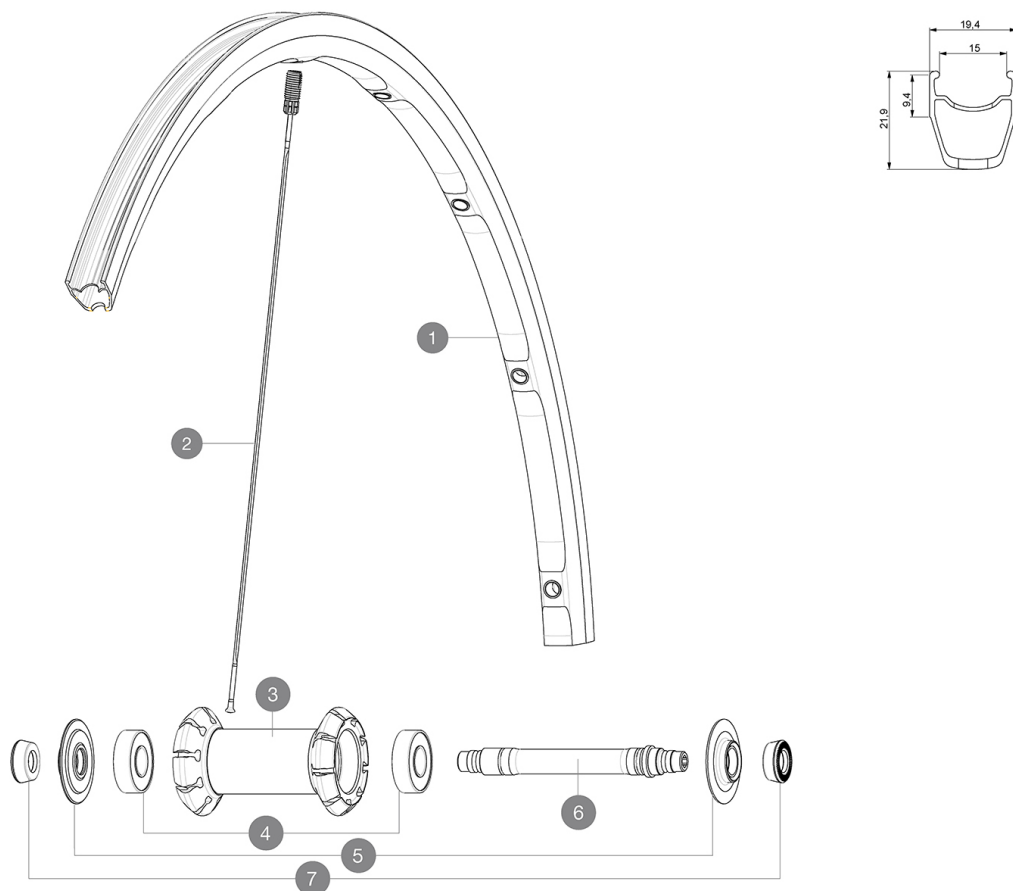

## RIMS



&NBSP;:

1	V2400410	FRONT KSYRIUM ELITE RED S BLACK RIM
1	33002310	FRONT KSYRIUM ELITE S BLACK RIM

## SPOKES

2	V2270701	9 FRONT SPOKES KSYRIUM ELITE S RED 284mm
2	33002701	9 BLK FRT SPOKES KSYRIUM ELITE S 285,5mm

## HUB SHELLS

3	N/A	HUB BODY
3	N/A	HUB BODY
4	M40318	HUB BEARING KIT 6001
5	12038201	KSYRIUM ELITE 11 HUB CAP AND ADJUST.NUT
6	99686101	KSYRIUM ELITE 09 FRONT AXLE
7	M40063	2 FRONT AXLE FORK SUPPORT



# Ksyrium Elite S

## 付属品

BR301 quick releases	
Multifonction adjustment wrench	
User guide	

## Specifications

### リム

- Material : Maxtal
- Height : front 22 mm, rear 25 mm asymmetrical
- Joint : SUP
- Drilling : Fore
- Brake track : UB Control
- Weight reduction : ISM
- Valve hole diameter : 6.5 mm
- Tyre : clincher
- ETRTO size : 622x15C
- Recommended tyre sizes : 19 to 32 mm

### スポーク

- Material : steel
- Shape : straight pull, bladed, front double butted
- Nipples : Fore integrated aluminum
- Count : front 18, rear 20
- Lacing : front radial, rear Isopulse

### ホイールハブ

- Front and rear bodies : aluminum
- Axle material : aluminum
- Adjustable sealed cartridge bearings
- Freewheel : FTS-L steel

### ホイールの重み

ホイール重量(クイックリリースおよびクリンチャー/チューブラーを除く)(g) : 680