

参照ホイール

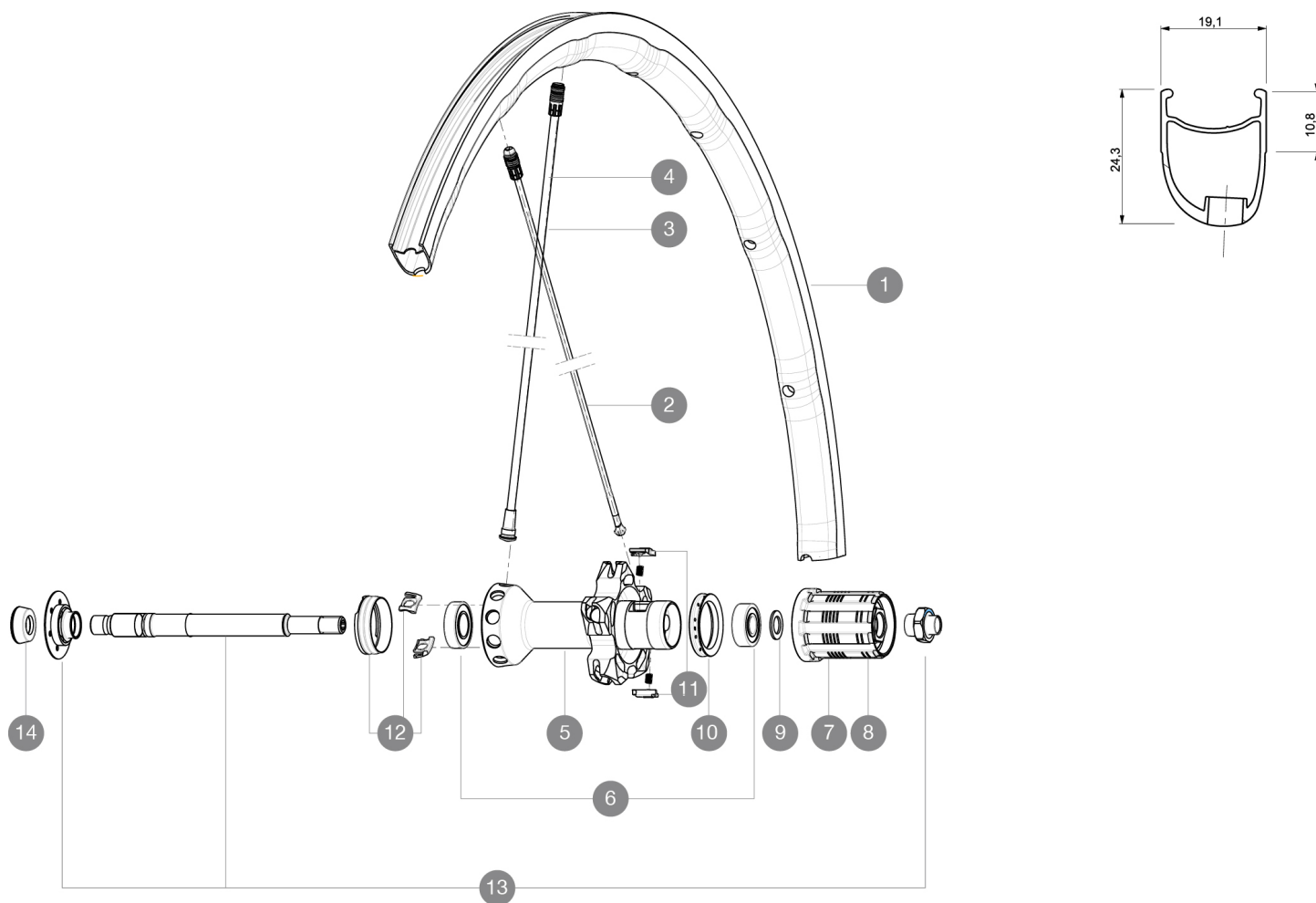

## RIMS



ÄÖÅÄ«ÄÖÅÇ©'Á%ÖÏ¼ÖMMí¼ÖÏ¼Ö6.5 :

1	A7199613	KIT REAR RIM K125
---	----------	-------------------

## SPOKES

2	V2270401	SPOKES KIT DRIVE SIDE R-SYS SLR / KSYRIUM SLR 2015 293,5MM
3	V2270101	KIT 2 YELLOW SPOKES K125 282mm/293,5mm
4	V2270301	KIT 10 NDS R-SYS/KSY SLR CARB SPK 282,7mm -while stock last
4	V4161301	Kit 10 front/rear Rsys spokes 282,7mm from 2020
12	99693801	2 SILVER TRACOMP RINGS + CLIPS

## HUB SHELLS

5	N/A	HUB BODY
6	33000001	REAR HUB B9+6901 BEARINGS 2013
7	30871101	FTS-L FREEWHEEL BODY HG11 2013 (8 or 9mm axle compatible)
8	30871201	FTS-L FREEWHEEL BODY ED11 2013 (8 or 9mm axle compatible)
9	30872801	SET OF 3 INTERNAL SILVER SPACERS 9mm FTS-L 2013
10	99500001	FTSL/FTSX FREEHUB BODY SEAL
11	M40578	FTSL PAWLS KIT (ROAD WHEELS)
13	V2250201	Axle Kit Rsys

## ADAPTERS

14	35117301	FRONT OR REAR FORK REST KIT R-SYS 2013
----	----------	--

# MAVIC Ksyrium 125

## 付属品

BR601 quick releases	
Wheelbags	
Exalith brake pads	
Computer magnet (front wheel)	
Multifonction adjustment wrench	
User guide	

## Specifications

### リム

- Material : Mxtral
- Height : front 24mm, rear 26 asymmetrical
- Joint : SUP
- Drilling : Fore
- Brake track : Exalith 2
- Weight reduction : ISM4D
- Valve hole diameter : 6.5 mm
- Tyre : clincher
- ETRTO size : 622x15C
- Recommended tyre sizes : 19 to 32 mm

### スポーク

- Material : front and rear drive side Zicral, Rear non drive side carbon fiber
- Shape : front and rear drive side straight pull bladed double butted, rear non drive side Tracomp
- Nipples : Fore integrated aluminum
- Count : front 18, rear 20
- Lacing : radial front and rear non-drive side, crossed 2 rear drive side

### ホイールハブ

- Front body : carbon with aluminum flanges
- Rear body : aluminum
- Axle material : aluminum
- Adjustable sealed cartridge bearings
- Freewheel : FTS-L steel

### ホイールの重み

ホイール重量 ( クイックリリースおよびクリンチャー/チューブラーを除く ) ( g ) : 765