

REFERENCES WHEELS

R42101 Ksyrium SLR 15 Rr

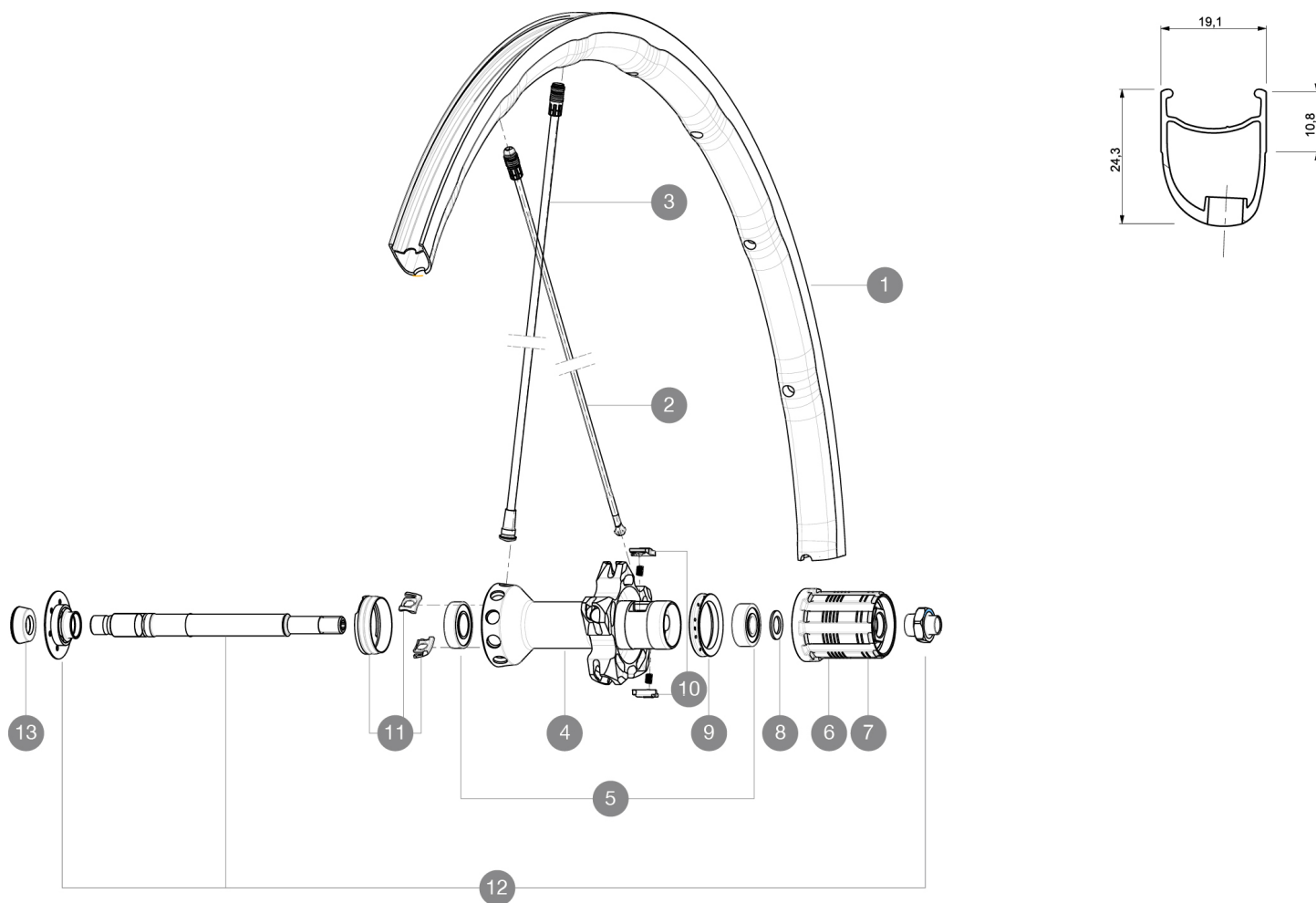

RIMS



VALVE HOLE \bar{A} (MM): 6.5 :

| | | |
|---|----------|--|
| 1 | V2290213 | KIT REAR RIM KSYRIUM PRO SL EXALITH (SLR 15) |
|---|----------|--|

SPOKES

| | | |
|----|----------|--|
| 2 | V2270401 | KIT 10 DS R-SYS SLR/KSY SLR ALU SPK 293,5mm |
| 3 | V4161301 | Kit 10 front/rear Rsys spokes 282,7mm from 2020 |
| 3 | V2270301 | KIT 10 NDS R-SYS/KSY SLR CARB SPK 282,7mm - while stock last |
| 11 | 99693801 | 2 SILVER TRACOMP RINGS + CLIPS |

HUB SHELLS

| | | |
|----|----------|---|
| 4 | N/A | HUB BODY |
| 5 | 33000001 | REAR HUB B9+6901 BEARINGS 2013 |
| 6 | 30871101 | FTS-L ROAD FREEWHEEL BODY HG11 8/9 compatible |
| 7 | 30871201 | FTS-L ROAD FREEWHEEL BODY ED11 8/9 compatible |
| 8 | 30872801 | SET OF 3 INTERNAL SILVER SPACERS 9mm FTS-L |
| 9 | 99500001 | FTSL/FTSX FREEHUB BODY SEAL |
| 10 | M40578 | FTSL PAWLS KIT (ROAD WHEELS) |
| 12 | V2250201 | KIT REAR AXLE KSYRIUM SLR/K125/R-SYS/ELITE 16 |

ADAPTERS

| | | |
|----|----------|---|
| 13 | 35117301 | FT/RR FORK REST R-SYS/CC ULTIMATE > 2013/KSY PRO CARB T |
|----|----------|---|

MAVIC *Ksyrium SLR***DELIVERED WITH**

| | |
|---------------------------------|--|
| BR601 quick releases | |
| Wheelbags | |
| Exalith brake pads | |
| Computer magnet (front wheel) | |
| Multifonction adjustment wrench | |
| User guide | |

Specifications**RIMS**

- **Material** : Maxtal
- **Height** : front 24mm, rear 26 asymmetrical
- **Joint** : SUP
- **Drilling** : Fore
- **Brake track** : Exalith 2
- **Weight reduction** : ISM4D
- **Valve hole diameter** : 6.5 mm
- **Tyre** : clincher
- **ETRTO size** : 622x15C
- **Recommended tyre sizes** : 19 to 32 mm

SPOKES

- **Material** : front and rear drive side Zicral, Rear non drive side carbon fiber
- **Shape** : front and rear drive side straight pull bladed double butted, rear non drive side Tracomp
- **Nipples** : Fore integrated aluminum
- **Count** : front 18, rear 20
- **Lacing** : radial front and rear non-drive side, crossed 2 rear drive side

WHEEL HUB

- **Front body** : carbon with aluminum flanges
 - **Rear body** : aluminum
 - **Axle material** : aluminum
- Adjustable sealed cartridge bearings
- **Freewheel** : FTS-L steel

WHEEL WEIGHTS

Wheel weight 750