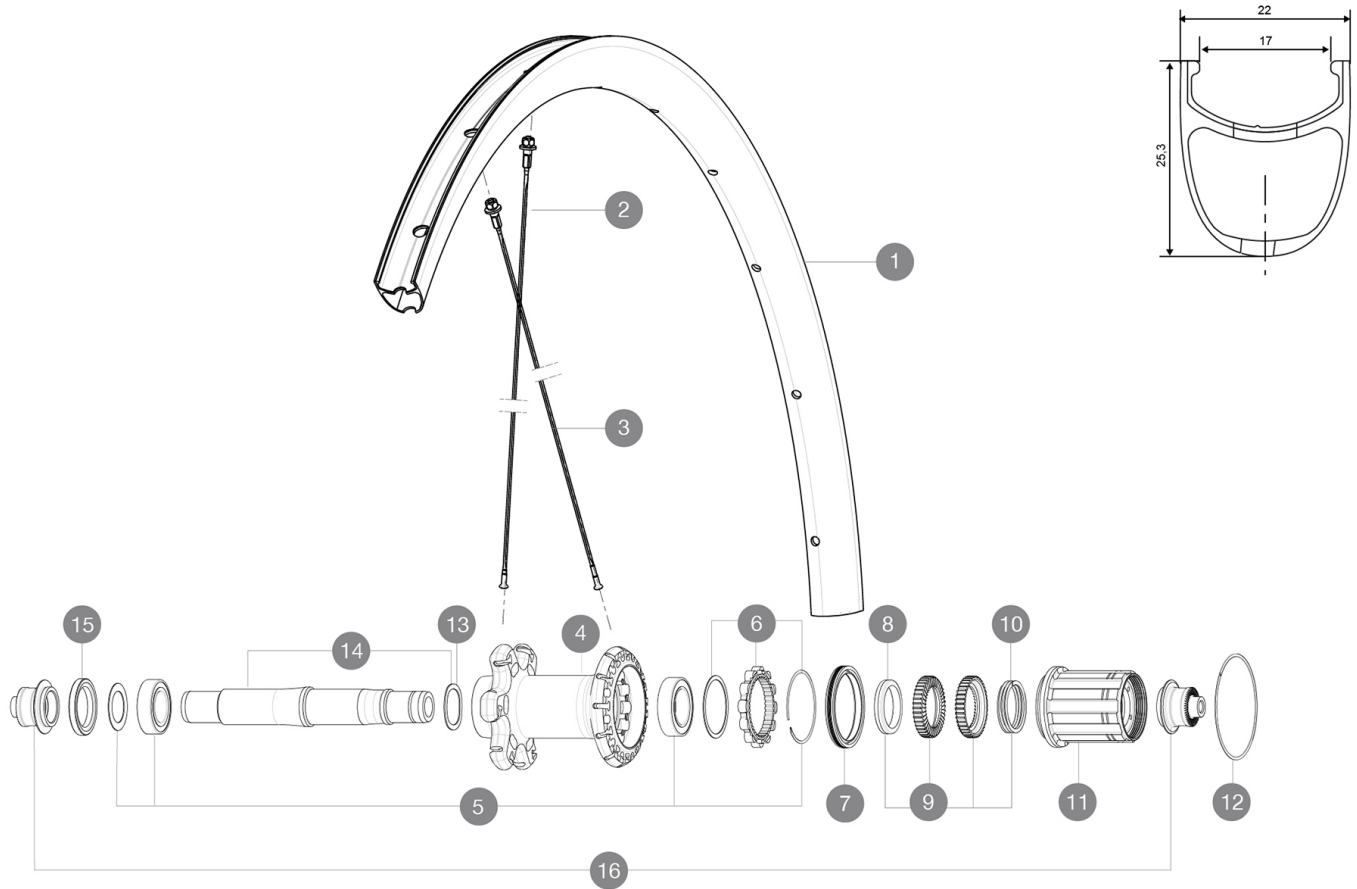

**MAVIC** *Ksyrium Pro Carbon SL C*

ASTM CATEGORY 1 : road only  
 Recommended weight limit : 120kg  
 Recommended tyre sizes: 25 to 52 mm  
 Max. Pressure: 25mm 7.7 bars - 110 PSI

**REFERENCES WHEELS**

R51301 KProCarbSL C Rr

**RIMS**VALVE HOLE  $\bar{A}$  (MM): 6,5 :

|   |          |  |
|---|----------|--|
| 1 | V2737513 | KIT REAR RIM KSYRIUM PRO CARBON SL UST                       |
| 1 | V2401513 | KIT RR RIM KSYRIUM PRO CARBON SL Clincher - while stock last |
|   | V3720101 | 25mm UST Tape for 19 to 22mm Road Rims                       |
|   | V2690101 | KIT CARBON RIM TAPE 21x622mm - FOR CARBON RIM                |

**SPOKES**

|   |          |  |
|---|----------|--|
| 2 | V3663301 | KIT 12 FRT KSYR PRO CARB SL UST Disc + NDS KSYR PRO CARB SL  |
| 2 | V2271501 | KIT 12 FT KSY PRO CARB SL D/NDS KSY PRO CARB SL SPK 291mm -  |
| 3 | V3663201 | KIT 12 DS KSY PRO CARB SL UST/UST Disc/C Disc/T Disc BUTTED  |
| 3 | V2271401 | KIT 12 DS KSYRIUM PRO CARB SL T SPOKE 273mm - while stock la |

**HUB SHELLS**

|    |          |   |
|----|----------|---|
| 4  | N/A      | HUB BODY                                |
| 5  | V2560101 | KIT ID360 BEARINGS 15/26/7 + 17/28/7    |
| 6  | V2252701 | KIT ID360 INSERT SHAPED EAR LOBE > 2017 |
| 7  | V2251601 | KIT ID360 SEAL + GREASE                 |
| 8  | V2500501 | KIT ID360 3 PADS NOISE REDUCING         |
| 9  | V2251701 | KIT ID360 2 RATCHETS + SPRING + GREASE  |
| 10 | V2251801 | KIT 3 ID360 ROAD SPRINGS                |
| 11 | V3430101 | HG11 Freewheel Body ID360               |
| 12 | V2252201 | KIT 2 REAR HUB RETENTION RINGS 48mm     |
| 13 | V2251501 | KIT 3 ID360 WAVE WASHERS                |
| 14 | V2251201 | KIT ID360 AXLE UB                       |

15 V2250901 KIT ID360 HUB THREADED CAP for UB model (small)

**TYRES**

17 37805425 YksionProPowerLinkSSC

**ADAPTERS**

16 B4989401 ADAPTER Rr 9mm QR ID360 (6bolt)

# MAVIC Ksyrium Pro Carbon SL C

## DELIVERED WITH

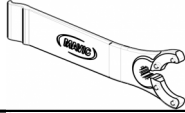
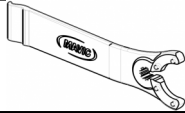
|  |   |
|--|---|
| BR601 quick releases                                 |   |
| Rim tape   |   |
| Carbon brake pads                                    |   |
| Carbon brake pads                                    |   |
| Carbon brake pads                                    |   |
| User guide   |   |
| Rim tape   |   |
| Rim tape   |   |
| Multifunction adjustment wrench<br>(325 423 01)<br>1 |  |
| Multifunction adjustment wrench<br>(325 423 01)<br>1 |  |
| User guide   |   |
| User guide   |   |

## COMPATIBILITY

|   |  |
|---|--|
| Freewheel: Shimano/Sram or Campagnolo,<br>convertible to XD-R with optional driver body |  |
| Front axle: Quick Release only  |  |
| Front axle: Quick Release only  |  |
| Rear axle: Quick Release only   |  |
| Rear axle: Quick Release only   |  |

## Specifications

### RIMS

- **Material** : 3K carbon fibers
- **Height** : 25mm
- **Drilling** : traditional
- **Material** : 3K carbon fibers
- **Material** : 3K carbon fibers
- **Brake track** : carbon with TgMAX technology
- **Valve hole diameter** : 6.5 mm
- **Tyre** : clincher
- **ETRTO size** : 622x17C
- **Height** : 25mm
- **Height** : 25mm
- **Recommended tyre sizes** : 25 to 52 mm
- **Drilling** : traditional
- **Drilling** : traditional
- **Brake track** : carbon with TgMAX technology
- **Brake track** : carbon with TgMAX technology
- **Brake track** : carbon
- **Brake track** : carbon
- **Valve hole diameter** : 6.5 mm
- **Valve hole diameter** : 6.5 mm
- **Tyre** : clincher
- **Tyre** : clincher

### WHEEL HUB

- **Front and rear bodies** : aluminum
- **Axle material** : aluminum
- Sealed cartridge bearings
- **Freewheel** : Instant Drive 360
- **Front and rear bodies** : aluminum
- **Front and rear bodies** : aluminum
- **Axle material** : aluminum
- **Axle material** : aluminum
- Sealed cartridge bearings
- Sealed cartridge bearings
- **Freewheel** : Instant Drive 360
- **Freewheel** : Instant Drive 360

### VERSIONS

- **Color** : Black only
- **Color** : Black only

### WHEEL WEIGHTS

Wheel weight 775