

ASTM CATEGORY 2 : road and offroad with jumps less than 15cm  
Recommended weight limit : 120kg  
Recommended tyre sizes: 25 to 52 mm  
Max. Pressure: 25mm 7.7 bars - 110 PSI

## REFERENCES WHEELS

|        |                |        |                        |
|--------|----------------|--------|------------------------|
| F41301 | Ksyrium Pro Ft | F70911 | Ksyrium Pro Ft Limited |
|--------|----------------|--------|------------------------|

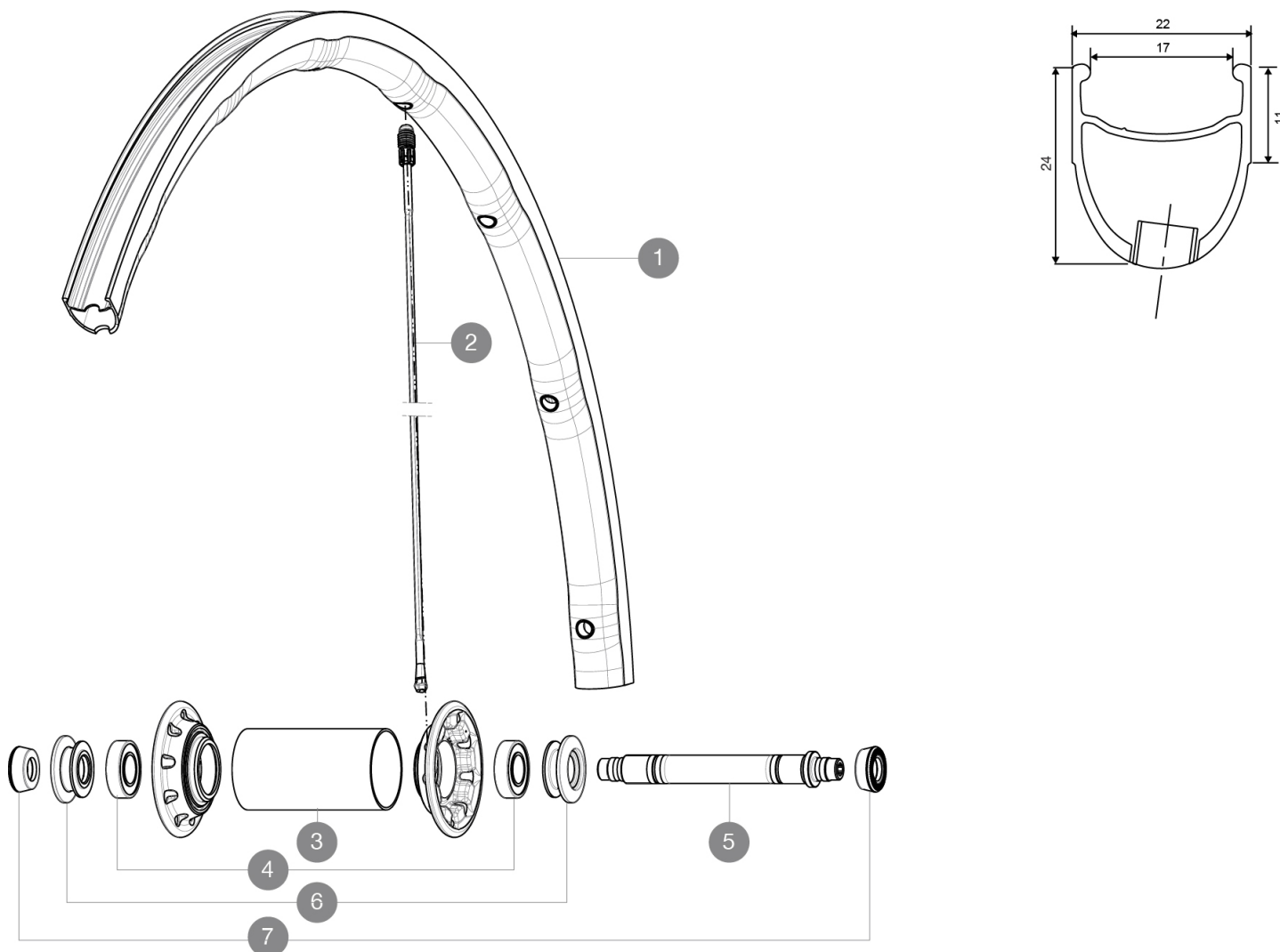

## RIMS



VALVE HOLE  $\varnothing$  (MM): 6,5 :

|   |          |                               |
|---|----------|-------------------------------|
| 1 | V2404910 | KIT FRONT RIM KSYRIUM PRO LTD |
| 1 | V2402010 | KIT FRONT RIM KSYRIUM PRO     |

## SPOKES

|   |          |   |
|---|----------|---|
| 2 | V2272801 | KIT 1 FT 282.5/1 RR 273.5 KSYRIUM PRO LTD SPK |
| 2 | V2270601 | KIT 9 FT KSY SLR/K125/PRO EXA SPK 282,5mm     |

## HUB SHELLS

|   |          |  |
|---|----------|--|
| 3 | N/A      | HUB BODY                                 |
| 3 | N/A      | HUB BODY                                 |
| 4 | M40078   | FRONT HUB BEARINGS 6901 x 2              |
| 5 | 32999801 | FRONT AXLE KIT R-SYS/KSYRIUM SL/SLS 2013 |
| 6 | M40759   | ADJUSTING BEARING NUT + FRONT CAP        |

## ADAPTERS

|   |          |   |
|---|----------|---|
| 7 | 35117301 | FT/RR FORK REST R-SYS/CC ULTIMATE > 2013/KSY PRO CARB T |
|---|----------|---|

# MAVIC Ksyrium Pro

## DELIVERED WITH

|                                 |  |
|---------------------------------|--|
| BR601 quick releases            |  |
| BR601 quick releases            |  |
| Multifunction adjustment wrench |  |
| User guide                      |  |
| Multifunction adjustment wrench |  |
| User guide                      |  |

## COMPATIBILITY

|  |  |
|--|--|
| Freewheel: Shimano/Sram, convertible to Campagnolo with optional driver body |  |
| Front axle: Quick Release only   |  |
| Rear axle: Quick Release only  |  |

## Specifications

### RIMS

- **Material** : Mxstal
- **Height** : front 24mm, rear 26 asymmetrical
- **Joint** : SUP
- **Drilling** : Fore
- **Brake track** : UB Control
- **Weight reduction** : ISM 4D
- **Valve hole diameter** : 6.5 mm
- **Material** : Mxstal
- **Tyre** : clincher
- **Height** : front 24mm, rear 26 asymmetrical
- **ETRTO size** : 622x17C
- **Recommended tyre sizes** : 25 to 52 mm
- **Joint** : SUP
- **Drilling** : Fore
- **Brake track** : UB Control
- **Weight reduction** : ISM 4D
- **Valve hole diameter** : 6.5 mm
- **Tyre** : clincher
- **Internal width** : 17 mm
- **ETRTO size** : 622x17C

### SPOKES

- **Material** : Zicral
- **Shape** : straight pull, bladed, front double butted
- **Nipples** : Fore integrated aluminum
- **Material** : Zicral
- **Count** : front 18, rear 20
- **Lacing** : front radial, rear Isopulse
- **Shape** : straight pull, bladed, front double butted
- **Nipples** : Fore integrated aluminum
- **Count** : front 18, rear 20
- **Lacing** : front radial, rear Isopulse

### WHEEL HUB

- **Front body** : carbon with aluminum flanges
  - **Rear body** : aluminum
  - **Rear body** : aluminum
  - **Axle material** : aluminum
- Adjustable sealed cartridge bearings
- **Front body** : carbon with aluminum flanges
  - **Freewheel** : FTS-L steel
  - **Axle material** : aluminum
- Adjustable sealed cartridge bearings
- **Freewheel** : FTS-L steel

### VERSIONS

- **Color** : Black only

### WHEEL WEIGHTS

Wheel weight 630