

ASTM CATEGORY 2 : road and offroad with jumps less than 15cm
Recommended weight limit : 120kg

REFERENCES WHEELS

R57501 CosmicCarb40TRr

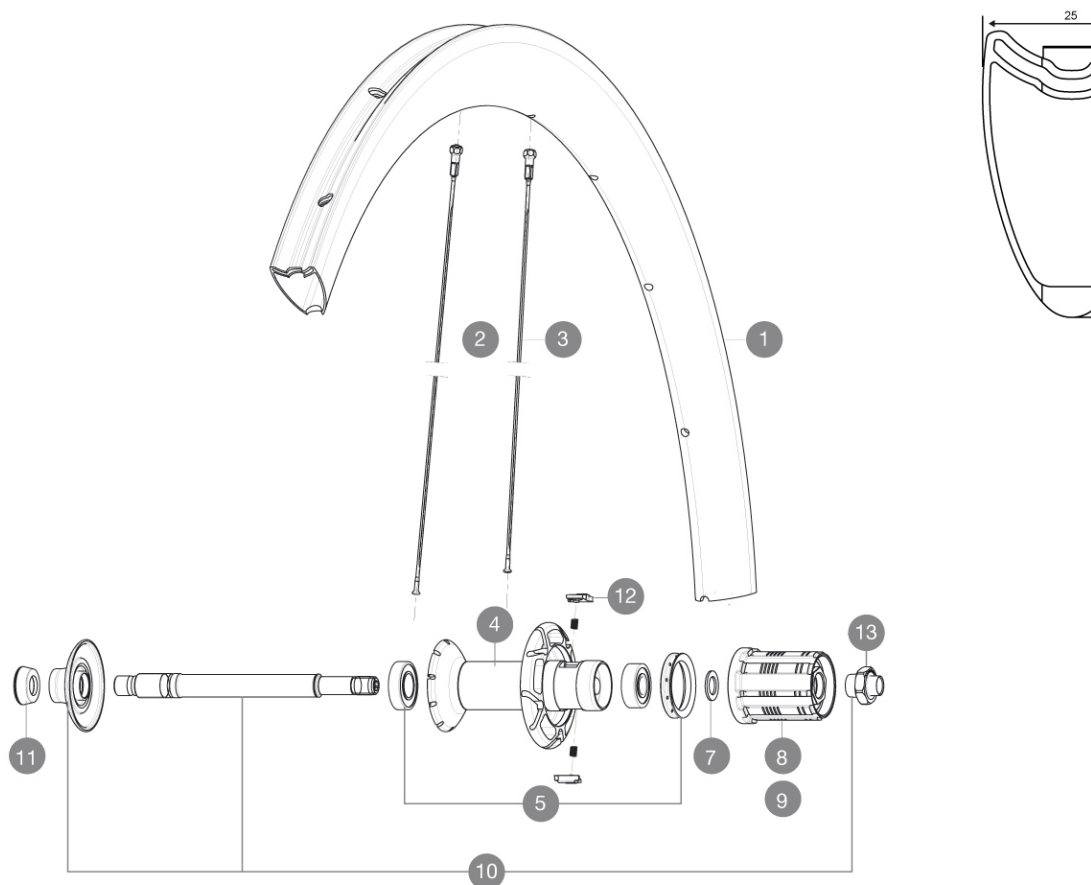

RIMS



VALVE HOLE \bar{A} (MM): 6,5 :

| | | |
|---|----------|----------------------------|
| 1 | 36645613 | KIT REAR RIM CC 40 TUBULAR |
|---|----------|----------------------------|

SPOKES

| | | |
|---|----------|----------------------------------------------|
| 2 | 36645001 | KIT 10 AERO DS CC 40 T BLACK SPOKE 270mm |
| 3 | 36645101 | KIT 10 AERO FT/NDS CC 40 T BLACK SPOKE 272mm |

HUB SHELLS

| | | |
|----|----------|--------------------------------------------------------------|
| 4 | N/A | HUB BODY |
| 5 | 33000001 | REAR HUB B9+6901 BEARINGS 2013 |
| 6 | 99500001 | FTSL/FTSX FREEHUB BODY SEAL |
| 7 | 30871101 | FTS-L ROAD FREEWHEEL BODY HG11 8/9 compatible |
| 8 | 30871201 | FTS-L ROAD FREEWHEEL BODY ED11 8/9 compatible |
| 9 | 30872801 | SET OF 3 INTERNAL SILVER SPACERS 9mm FTS-L |
| 10 | V2250301 | KIT REAR AXLE AERO HUB CXR/CC40/CC SLS/CC SLE/COSMIC PRO CAR |
| 12 | M40578 | FTSL PAWLS KIT (ROAD WHEELS) |
| 13 | V2373101 | KIT NUT FOR ROAD ALLOY THROUGH AXLE 9mm |

ADAPTERS

| | | |
|----|----------|---------------------------------------------------------|
| 11 | 35117301 | FT/RR FORK REST R-SYS/CC ULTIMATE > 2013/KSY PRO CARB T |
|----|----------|---------------------------------------------------------|

MAVIC Cosmic Carbone 40 T

DELIVERED WITH

| | |
|---------------------------------|--|
| BR601 quick releases | |
| Carbon brake pads | |
| Multifonction adjustment wrench | |
| User guide | |

Specifications

RIMS

- **Material** : 100% Unidirectional carbon fiber
- **Height** : 40 mm
- **Drilling** : traditional
- **Brake track** : carbon
- **Valve hole diameter** : 6.5 mm
- **Tyre** : tubular
- **ETRTO size** : 28" tubular
- **Recommended tyre sizes** : 23 to 32 mm

SPOKES

- **Material** : steel
- **Shape** : straight pull, bladed, double butted
- **Nipples** : brass, ABS
- **Count** : front 16, rear 20
- **Lacing** : radial front and rear non-drive side, crossed 2 rear drive side

WHEEL HUB

- **Front and rear bodies** : carbon center tube and aluminum flanges
 - **Axle material** : aluminum
- Adjustable sealed cartridge bearings
- **Freewheel** : FTS-L steel

WHEEL WEIGHTS

Wheel weight 800