

MAVIC Ksyrium

ASTM CATEGORY 1 : road only

For a longer longevity of the wheel, Mavic recommends that the total weight supported by the wheels doesn't exceed 120kg, bike included

参照ホイール

R59401 Ksyrium Rr Black

R59402 Ksyrium Rr Red

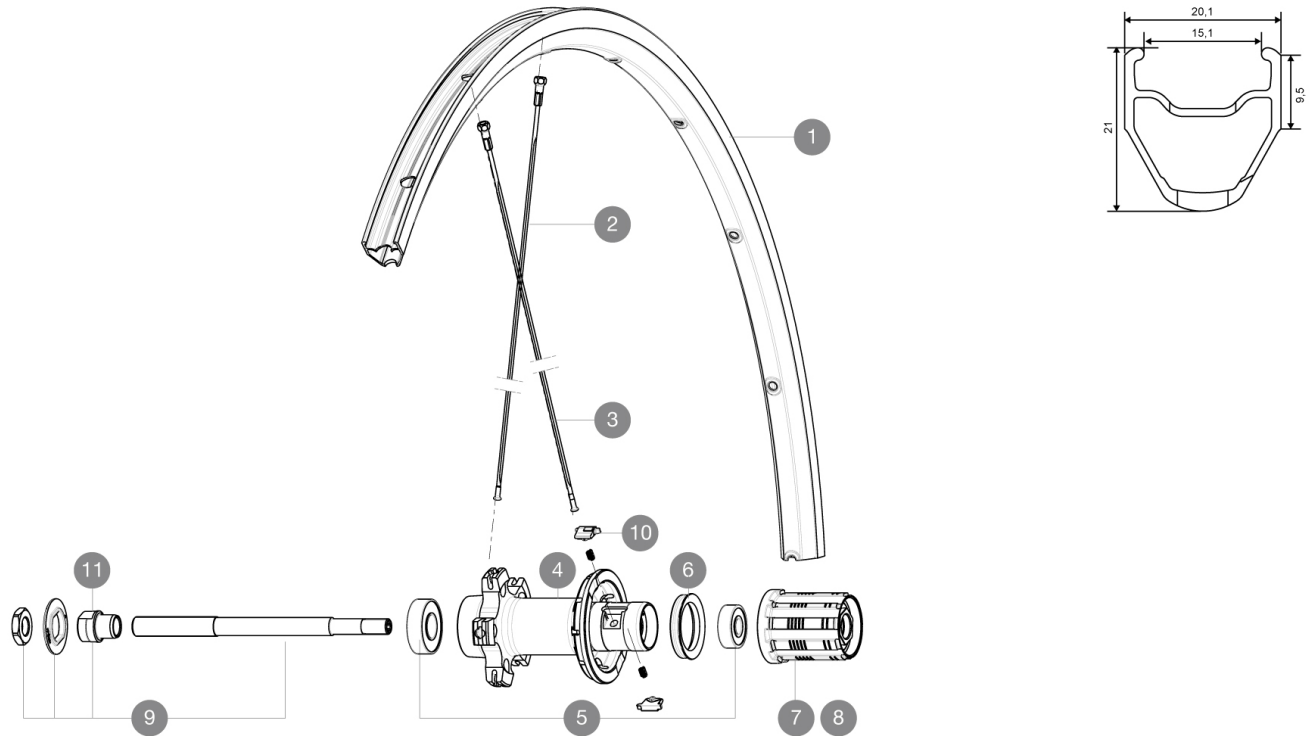

RIMS



バルブ穴径 (MM) : 6,5 :

1	V2402815	RIM KSYRIUM RED
1	12021415	FRONT/REAR BLACK KSYRIUM EQUIPE 11 RIM

SPOKES

2	12031401	10 BLK OPP.DRIVE SIDE SPK KSYRIUM EQUIPE 11 301mm
3	12031301	10 BLK DRIVE SIDE SPOKES KSYRIUM EQUIPE 11 278mm

HUB SHELLS

5	M40660	REAR HUB 608+6001 BEARINGS
6	99500001	FTSL/FTSX FREEHUB BODY SEAL
7	30871101	FTS-L FREEWHEEL BODY HG11 2013 (8 or 9mm axle compatible)
8	30871201	FTS-L FREEWHEEL BODY ED11 2013 (8 or 9mm axle compatible)
9	99603901	REAR AXLE KSYRIUM EQUIPE 08
10	M40578	FTSL PAWLS KIT (ROAD WHEELS)
11	99603801	SHORT EXPENSIBLE BEARING SUPPORTS > 2008



Ksyrium

付属品

BR101 quick releases	
Rim tape	
User guide	

Specifications

リム

- Material : S6000 Aluminum
- Height : 25mm
- Joint : SUP
- Drilling : traditional with H2 reinforcement
- Brake track : UB Control
- Valve hole diameter : 6.5 mm
- Tyre : clincher
- ETRTO size : 622x15C
- Recommended tyre sizes : 21 to 32 mm

スポーク

- Material : steel
- Shape : straight pull, bladed
- Nipples : brass, ABS
- Count : 20 front and rear
- Lacing : front radial, rear Isopulse

ホイールハブ

- Front and rear bodies : aluminum
- Axle material : steel
- Sealed cartridge bearings
- Freewheel : FTS-L steel

ホイールの重み

ホイール重量 (クイックリリースおよびクリンチャー/チューブラーを除く) (g) : 920