

ASTM CATEGORY 3 : offroad with jumps less than 61cm
Recommended weight limit : 120kg

REFERENCES WHEELS

| | | | |
|--------|------------------------------|--------|----------------------------|
| R68801 | XmaxSLPro27.5OffsetRrWTSBk | R78402 | XmaxSLProLtd27.5RxD WTS YE |
| R68802 | XmaxSLProLtd27.5OffsetWTSYel | R51702 | XmaxSLProLtd27.5RrWTSYel |
| R75201 | XmSLProLtd27.5OffsetNT135 | R51701 | XmaxSLPro27.5RrWTS Black |
| R78401 | XmaxSLPro27.5RrXD WTS BK | R82601 | XmaxSLPro27.5RrNT Bk |

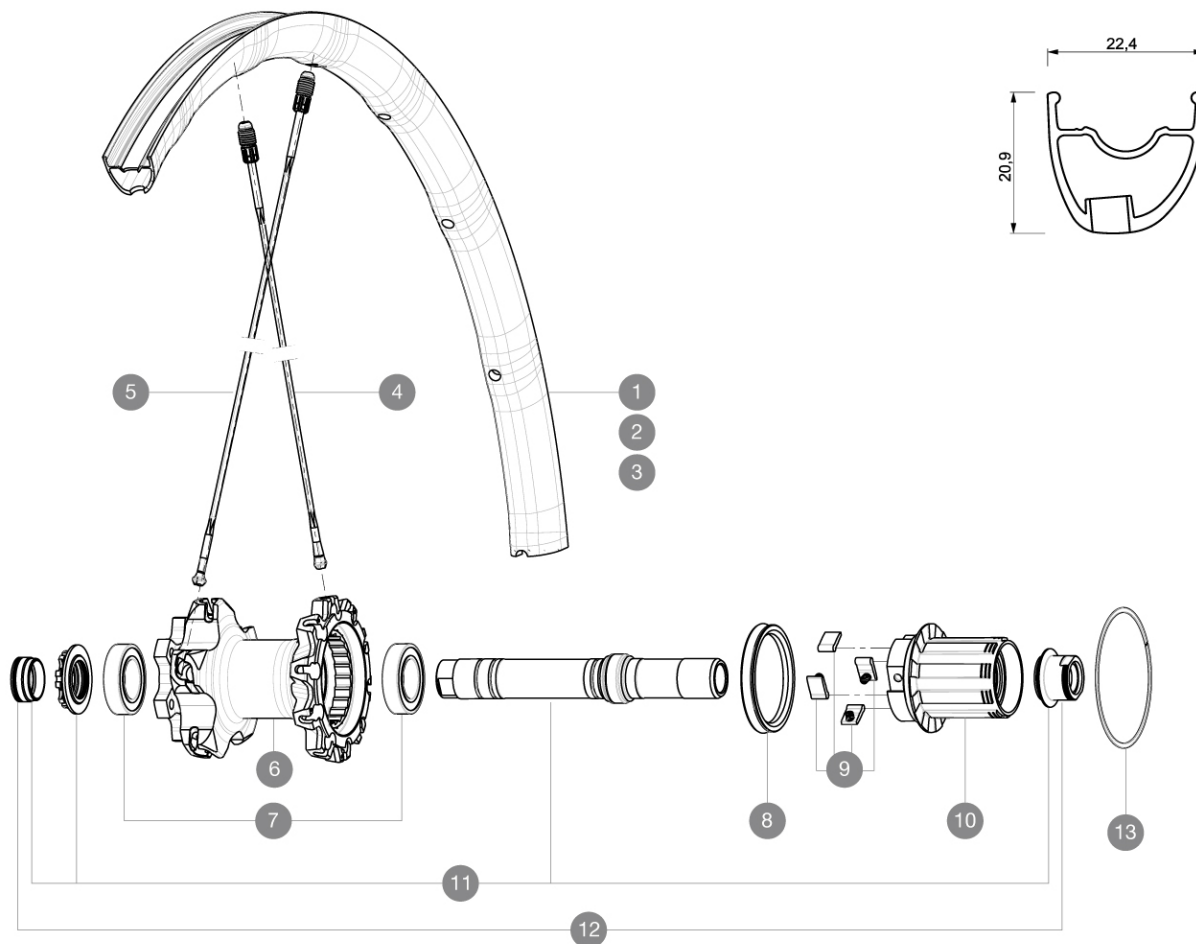

RIMS



VALVE HOLE (MM): 6,5 :

| | | |
|---|----------|---|
| 1 | V2313213 | "KIT RR RIM CROSSMAX SL PRO LTD OFFS YEL 27,5"" |
| 2 | V2313113 | "KIT REAR RIM CROSSMAX SL PRO LTD YELL 27,5"" |
| 3 | V2310513 | KIT REAR RIM CROSSMAX SL/SL PRO BLACK 27.5" |

SPOKES

| | | |
|---|----------|--|
| 4 | 36675101 | "KIT 10 DS XMAX SLR/END/PRO/DEEMAX PRO 27,5"" SPK 251,5mm" |
| 5 | 36675001 | "KIT 10 NDS XMAX SLR/ENDURO 27,5"" ALU SPK 281,5mm" |

HUB SHELLS

| | | |
|----|----------|---|
| 6 | N/A | HUB BODY |
| 7 | M40076 | HUB BEARINGS 17x30x7 6903 x 2 |
| 8 | 99610701 | ITS-4 FREEWHEEL SEAL |
| 9 | 99610601 | PAWLS KIT FOR ITS-4 (OR TS-2) |
| 10 | 35126001 | ITS-4 FREEWHEEL BODY + SEAL 2013 (NO PAWLS) |
| 11 | 30870401 | REAR QRM + AXLE KIT ITS4 135mm from 2012 |
| 13 | 30871801 | ELASTIC RING 56mm diam. ITS-4 20 SPOKES |

ADAPTERS

| | | |
|----|----------|--|
| 12 | 30872201 | FRAME SUPPORT ITS-4 135mm REAR AXLE > 2012 |
|----|----------|--|

MAVIC **Crossmax SL Pro WTS 27.5****DELIVERED WITH**

| | |
|---------------------------------|--|
| 1 bottle of Mavic Sealant | |
| BX601 quick releases | |
| UST valve and accessories | |
| Front QR adapters | |
| Rear QR adapters | |
| Rear 12x142mm adapters | |
| Multifonction adjustment wrench | |

Specifications**RIMS**

- **Material** : Maxtal
 - **Joint** : SUP
 - **Drilling** : Fore
- Disc brake specific profile
- **Weight reduction** : ISM 4D
 - **Valve hole diameter** : 6.5 mm
 - **Tyre** : UST Tubeless and tubetype
 - **Internal width** : 19 mm
 - **ETRTO size 26"** : 559x19C
 - **ETRTO size 650b/27.5"** : 584x19C
 - **ETRTO size 29"** : 622x19C
 - **ETRTO recommended tyre sizes** : 28mm to 62mm (1.1" to 2.5")

SPOKES

- **Material** : Zicral
- **Shape** : straight pull, bladed
- **Nipples** : Fore integrated aluminum
- **Count** : 20 front and rear
- **Lacing** : front crossed 2, rear Isopulse

WHEEL HUB

- **Front body** : carbon with aluminum flanges
- Adjustable sealed cartridge bearings
- **Freewheel** : ITS-4 alloy
- Shimano 11 speeds compatible
Sram XD Compatible (XX1-X01) with optional kit

WHEEL WEIGHTS

Wheel weight
Weight Rear 26" : 760
Weight Rear 27.5" : 805
Weight Rear 29" : 830