

参照ホイール

For a longer longevity of the wheel, Mavic recommends that the total weight supported by the wheels doesn't exceed 120kg, bike included

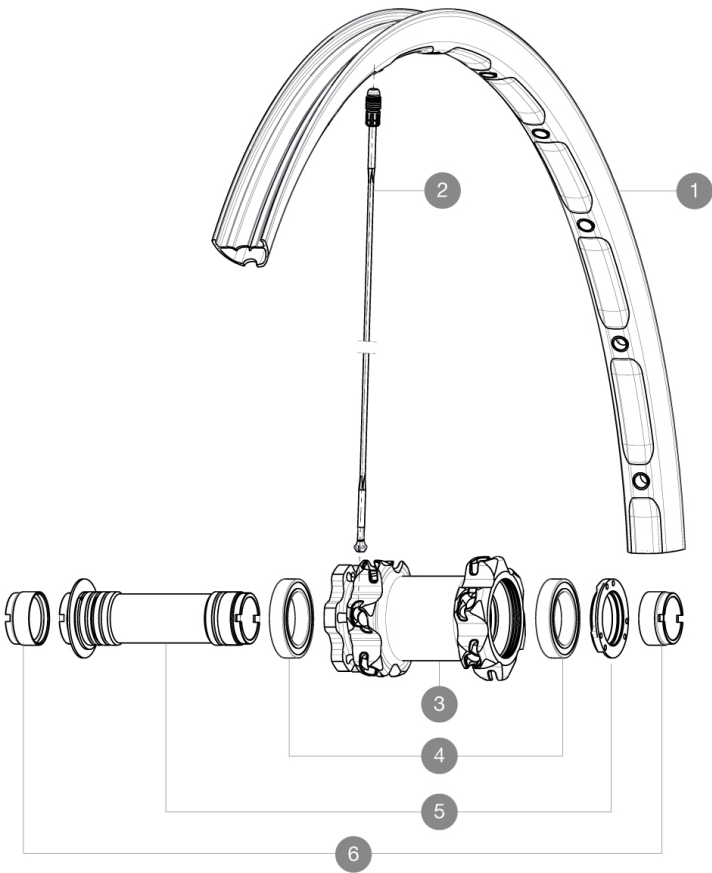

RIMS



バルブ穴径 (MM) : 6,5 :

| | | |
|---|----------|---|
| 1 | V2313910 | KIT FRONT RIM CROSSMAX XL PRO LIMITED 27.5" |
|---|----------|---|

SPOKES

| | | |
|---|----------|---|
| 2 | 36674901 | "12 SPOKES FRONT CROSSMAX SLR/ENDURO 650b/27,5"" 274mm" |
|---|----------|---|

HUB SHELLS

| | | |
|---|----------|---|
| 3 | N/A | HUB BODY |
| 3 | N/A | HUB BODY |
| 4 | M40179 | FRONT BEARING 25x37x7 20mm AXLE |
| 5 | 30870501 | FRONT AXLE 20mm CROSSMAX ST/SX + DEEMAX ULTI 2012 |

ADAPTERS

| | | |
|---|----------|---|
| 6 | 12982901 | 20mm adapter for Crossmax ST/SX (front wheel) |
|---|----------|---|



Crossmax XL pro Ltd 27.5 WTS

Specifications

スポーク

•Shape : straight pull, bladed

ホイールの重み

ホイール重量 (クイックリリー
スおよびクリンチャー/チューブ
ラーを除く) (g) :