

ASTM CATEGORY 4 : offroad with jumps less than 122cm

For a longer longevity of the wheel, Mavic recommends that the total weight supported by the wheels doesn't exceed 120kg, bike included

参照ホイール

F69561 XmXLPro27.5FtSpXWTS

F35701

XmaxXLPro27.5FtWTS

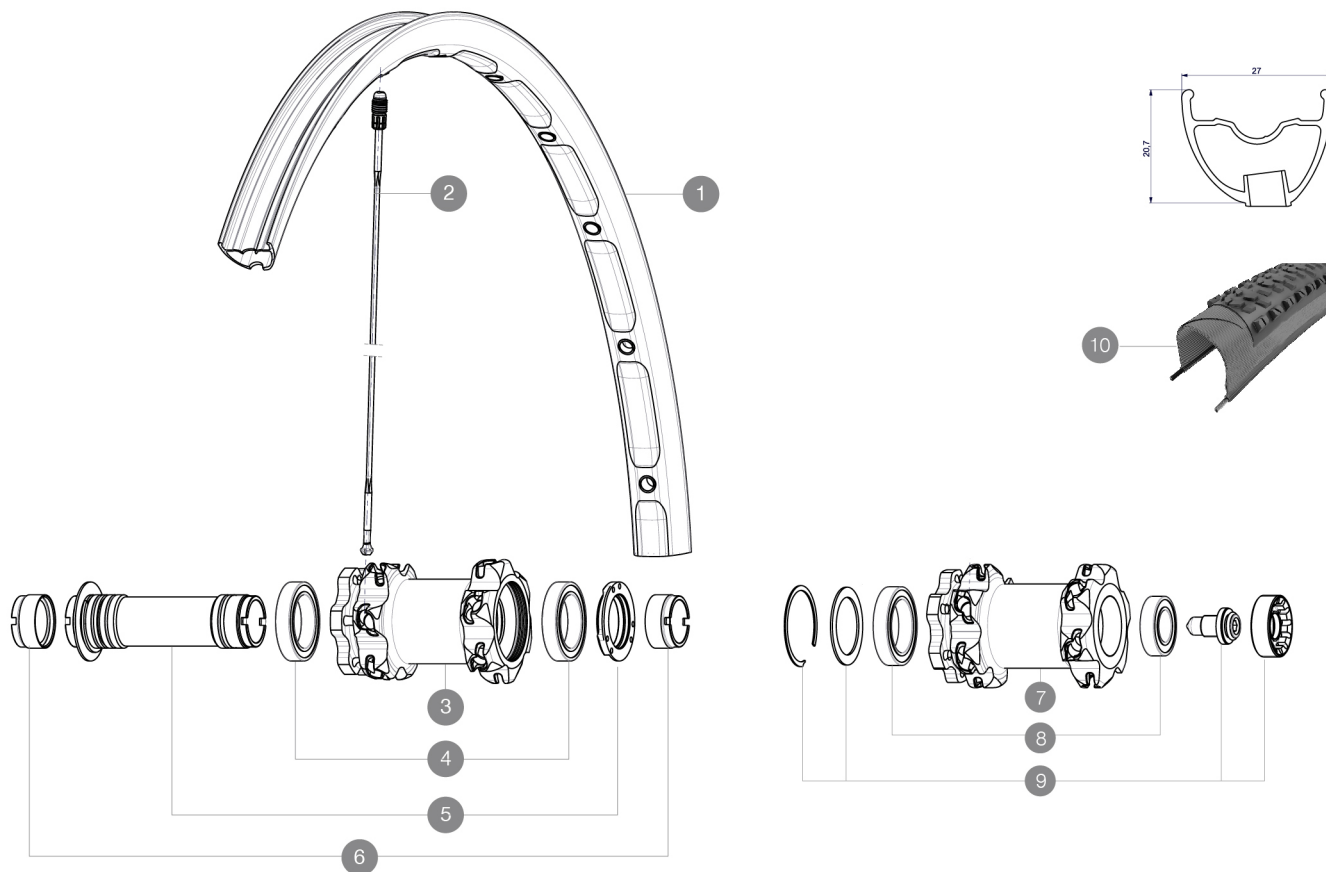

RIMS



バルブ穴径 (MM) : 6,5 :

| | | |
|---|----------|--------------------------------------|
| 1 | V2310810 | KIT FRONT RIM CROSSMAX XL 2015 27,5" |
|---|----------|--------------------------------------|

SPOKES

| | | |
|---|----------|--|
| 2 | 36674901 | "12 SPOKES FRONT CROSSMAX SLR/ENDURO 650b/27,5" 274mm" |
|---|----------|--|

HUB SHELLS

| | | |
|---|----------|---|
| 3 | N/A | HUB BODY |
| 4 | M40179 | FRT HUB BEARING KIT 20mm AXLE |
| 5 | 30870501 | FRONT AXLE 20mm CROSSMAX ST/SX + DEEMAX ULTI 2012 |
| 8 | M40771 | BEARING KIT FOR LEFTY HUB |
| 9 | 36709301 | ASSEMBLY KIT CROSSROC SUPERMAX |

ADAPTERS

| | | |
|---|----------|---|
| 6 | 12982901 | 20mm adapter for Crossmax ST/SX (front wheel) |
|---|----------|---|

MAVIC

Crossmax XL Pro WTS 27.5

付属品

| | |
|---------------------------------|--|
| BX601 rear quick release | |
| 1 bottle of Mavic Sealant | |
| UST valve and accessories | |
| Front 15 mm adapters | |
| Rear QR adapters | |
| Rear 12x142mm adapters | |
| Multifunction adjustment wrench | |
| User guide | |

Specifications

リム

- Material : Maxtal
- Drilling : Fore
- Weight reduction : ISM
- Tyre : UST Tubeless and tubetype
- Internal width : 23 mm
- ETRTO size 26" : 559x23C
- ETRTO size 27.5" : 584x23C
- ETRTO size 29" : 622x23C
- ETRTO recommended tyre sizes : 37mm to 76mm (1.5" to 3.0")

スポーク

- Material : Zicral
- Shape : straight pull, bladed
- Nipples : Fore integrated aluminum
- Count : 24 front and rear
- Lacing : front crossed 2, rear Isopulse

ホイールハブ

- Front and rear bodies : aluminum
- Axle material : aluminum
- Adjustable sealed cartridge bearings
- Freewheel : ITS-4 alloy
- Shimano 11 speeds compatible
- Sram XD Compatible (XX1-X01) with optional kit

ホイールの重み

- ホイール重量 (クイックリリースおよびクリンチャー/チューブラーを除く) (g) :
- Weight Front 26" : 790
 - Weight Front 27.5" : 815
 - Weight Front 29" : 850