

ASTM CATEGORY 4 : offroad with jumps less than 122cm  
Recommended weight limit : 120kg

## REFERENCES WHEELS

R78901 XmxLPro27.5RrXD WTS

R59701 XmaxXLPro27.5RrWTS

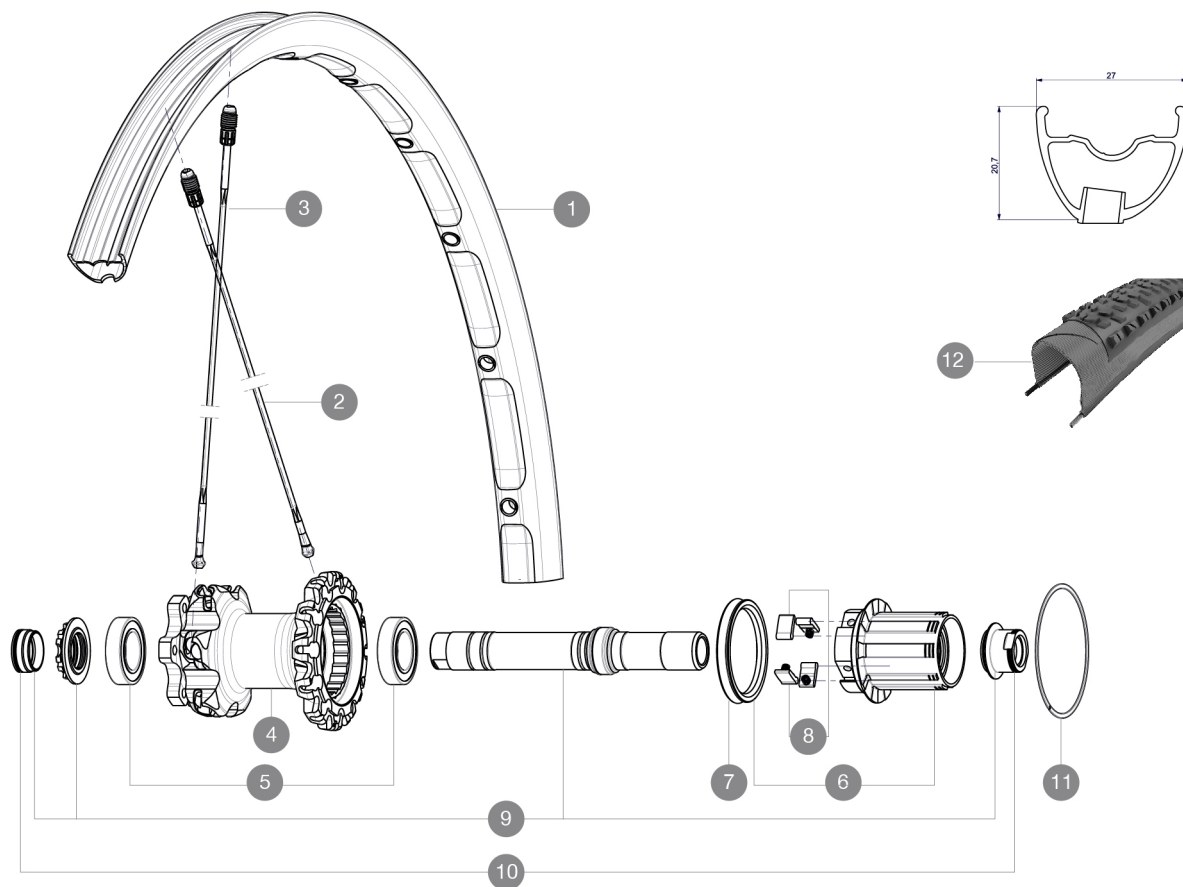

## RIMS



VALVE HOLE (MM): 6,5 :

1 V2311113 KIT REAR RIM CROSSMAX XL 2015 27,5"

## SPOKES

2 36675101 "KIT 10 DS XMAX SLR/END/PRO/DEEMAX PRO 27,5"" SPK 251,5mm"  
3 36674901 KIT 12 FT XMAX END/FT-NDS DEEMAX PRO 27,5" ALU SPK 275mm

## HUB SHELLS

4 N/A HUB BODY  
5 M40076 HUB BEARINGS 17x30x7 6903 x 2  
6 35126001 ITS-4 FREEWHEEL BODY + SEAL 2013 (NO PAWLS)  
7 99610701 ITS-4 FREEWHEEL SEAL  
8 99610601 PAWLS KIT FOR ITS-4 (OR TS-2)  
9 30870401 REAR QRM + AXLE KIT ITS4 135mm from 2012  
11 30871801 ELASTIC RING 56mm diam. ITS-4 20 SPOKES

## ADAPTERS

10 30872201 FRAME SUPPORT ITS-4 135mm REAR AXLE > 2012

**MAVIC** *Crossmax XL Pro WTS 27.5***DELIVERED WITH**

BX601 rear quick release	
1 bottle of Mavic Sealant	
UST valve and accessories	
Front 15 mm adapters	
Rear QR adapters	
Rear 12x142mm adapters	
Multifonction adjustment wrench	
User guide	

**Specifications****RIMS**

- **Material** : Mactal
- **Drilling** : Fore
- **Weight reduction** : ISM
- **Tyre** : UST Tubeless and tubetype
- **Internal width** : 23 mm
- **ETRTO size 26"** : 559x23C
- **ETRTO size 27.5"** : 584x23C
- **ETRTO size 29"** : 622x23C
- **ETRTO recommended tyre sizes** : 37mm to 76mm (1.5" to 3.0")

**SPOKES**

- **Material** : Zicral
- **Shape** : straight pull, bladed
- **Nipples** : Fore integrated aluminum
- **Count** : 24 front and rear
- **Lacing** : front crossed 2, rear Isopulse

**WHEEL HUB**

- **Front and rear bodies** : aluminum
  - **Axle material** : aluminum
- Adjustable sealed cartridge bearings
- **Freewheel** : ITS-4 alloy
- Shimano 11 speeds compatible  
Sram XD Compatible (XX1-X01) with optional kit

**WHEEL WEIGHTS**

Wheel weight  
 Weight Rear 26": 870  
 Weight Rear 27.5": 895  
 Weight Rear 29": 930