

MAVIC Deemax Ultimate 27.5

1
2016
REAR

ASTM CATEGORY 5 : extreme offroad
ETRTO recommended tyre sizes: 35mm to 69mm (1.4" to 2.7")

REFERENCES WHEELS

R67501 DmaxUlti16Rr27.5 12x150

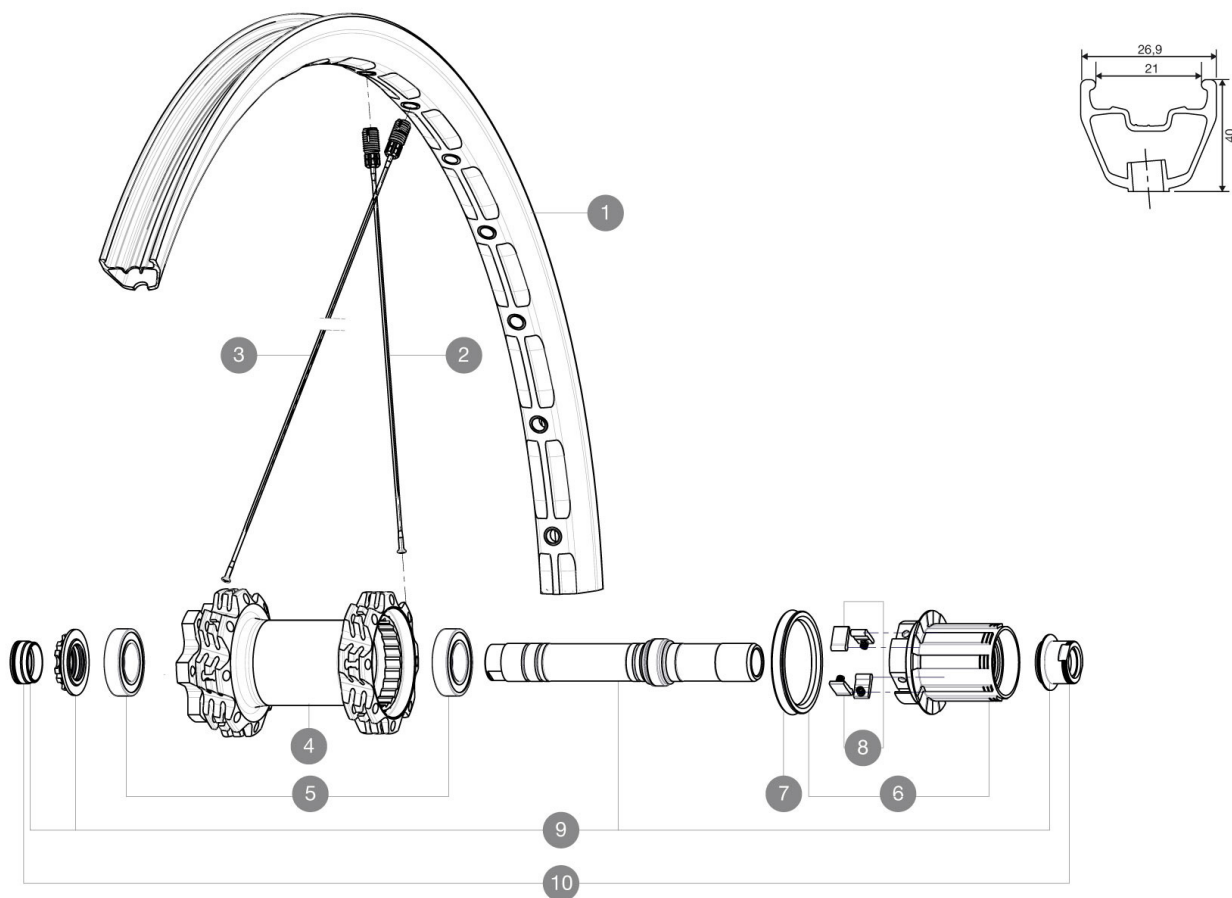

RIMS



VALVE HOLE \bar{A} (MM): 6.5 :

1	V2312313	"KIT REAR RIM DEEMAX ULTIMATE 27,5""
---	----------	--------------------------------------

SPOKES

2	V2380601	"KIT 16 DRIVE SIDE DEEMAX 27,5"" SPOKE 278,5mm"
3	V2380701	"KIT 16 NDS DEEMAX 27,5"" SPOKE 280,5mm"

HUB SHELLS

4	N/A	HUB BODY
5	M40076	HUB BEARINGS 17x30x7 6903 x 2
6	35126001	ITS-4 FREEWHEEL BODY + SEAL 2013 (NO PAWLS)
7	99610701	ITS-4 FREEWHEEL SEAL
8	99610601	PAWLS KIT FOR ITS-4 (OR TS-2)
9	30870201	REAR AXLE KIT ITS4 150mm 2012
9	30870401	REAR QRM + AXLE KIT ITS4 135mm from 2012

ADAPTERS

10	30872201	FRAME SUPPORT ITS-4 135mm REAR AXLE > 2012
----	----------	--

MAVIC Deemax Ultimate 27.5

DELIVERED WITH

UST valve and accessories	
Front 20 mm adapters	
Rear QR adapters	
Multifunction adjustment wrench	
User guide	
Front 20 mm adapters	
12x157mm adaptors (308 593 01 for ITS4)	
UST valve and accessories	
Multifunction adjustment wrench	
User guide	
12x157mm adaptors (308 593 01 for ITS4)	

COMPATIBILITY

Freewheel: Shimano/Sram, convertible to XD with optional driver body	
Front axle: 20mm or 15mm thru axle with optional adapters	

Specifications

RIMS

- **Material** : Mxstal
 - **Joint** : SUP
 - **Drilling** : Fore
- Disc brake specific profile
- **Weight reduction** : ISM with central spine
 - **Valve hole diameter** : 6.5 mm
 - **Material** : Mxstal
 - **Tyre** : UST Tubeless and tubetype
 - **Internal width** : 21 mm
 - **ETRTO size 26"** : 559x21C
 - **ETRTO size 27.5"** : 584x21C
 - **ETRTO recommended tyre sizes** : 35mm to 69mm (1.4" to 2.7")
 - **Joint** : SUP
 - **Drilling** : Fore
- Disc brake specific profile
- **Weight reduction** : ISM with central spine
 - **Valve hole diameter** : 6.5 mm
 - **Tyre** : UST Tubeless and tubetype
 - **Internal width** : 21 mm
 - **ETRTO size 26"** : 559x21C

SPOKES

- **Material** : steel
- **Shape** : straight pull, bladed
- **Nipples** : Fore integrated aluminum
- **Count** : front 28, rear 32

Down Lacing : front and rear crossed 3ite: 2022-03-01

- **Material** : steel
- **Shape** : straight pull, bladed

WHEEL HUB

- **Front and rear bodies** : aluminum
 - **Axle material** : aluminum
- Adjustable sealed cartridge bearings
- **Freewheel** : ITS-4 alloy
 - **Front and rear bodies** : aluminum
- Shimano 11 speeds compatible
- **Axle material** : aluminum
- Sram XD Compatible (XX1-X01) with optionnal kit
- Adjustable sealed cartridge bearings
- **Freewheel** : ITS-4 alloy

VERSIONS

- **Color** : Black only
- **Disc standard** : 6 Bolts only

WHEEL WEIGHTS

Wheel weight
Weight Rear 26": 1055
Weight Rear 27.5": 1085