

ASTM CATEGORY 3 : offroad with jumps less than 61cm

For a longer longevity of the wheel, Mavic recommends that the total weight supported by the wheels don't exceed 120kg, bike included

150

Maximum tyre pressure: 6.1bar/88PSI with a 25mm tyre - 3.5bar/51PSI with a 64mm tyre
Recommended tire sizes: 28 to 64 mm (1.1" to 2.5")

ETRTO recommended tyre sizes: 35mm to 69mm (1.4" to 2.7")

参照ホイール

F50501 XRIIDE FTS-X INT 26 QR

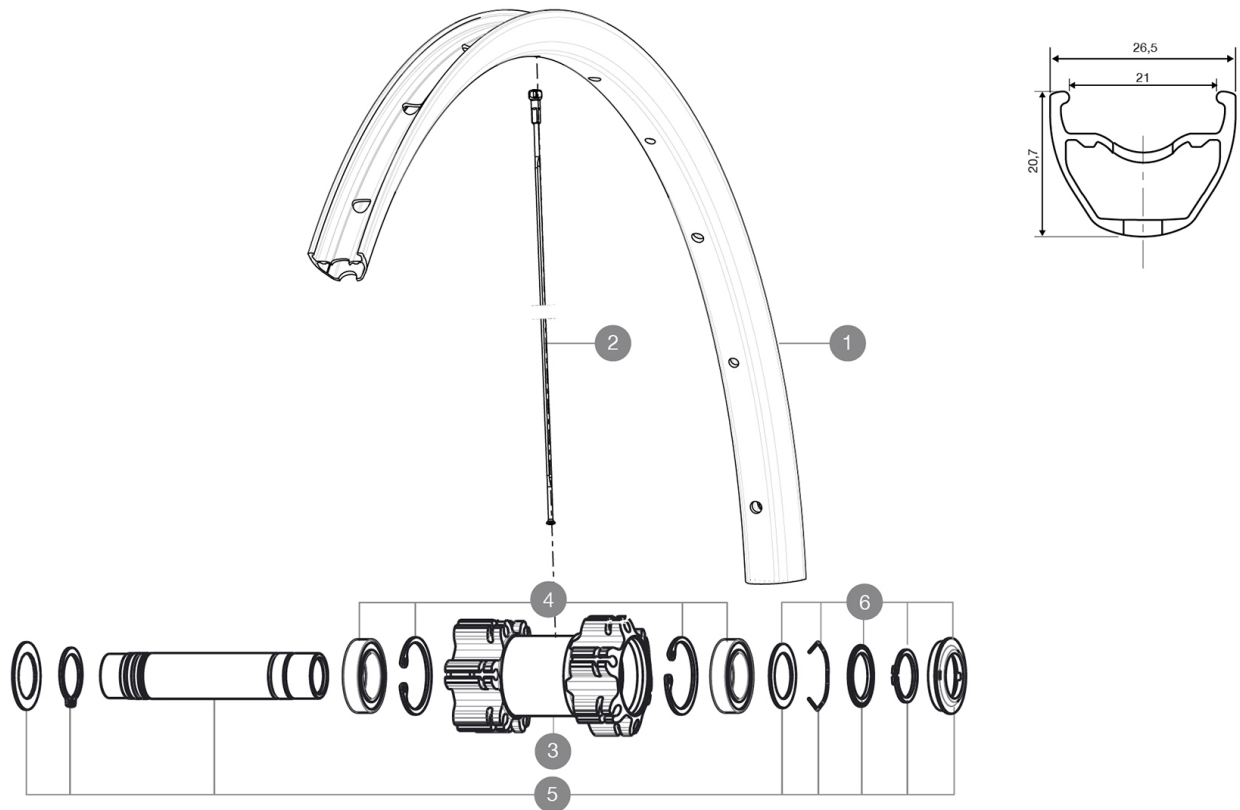

RIMS



&NBSP;:

1	V2314715	RIM CROSSRIDE + CROSSRIDE FTSX 26
---	----------	-----------------------------------

SPOKES

2	36689801	12 SPOKES FRONT/OPP DRIVE SIDE CROSSONE 264mm
---	----------	---

HUB SHELLS

3	N/A	HUB BODY
4	99688501	BEARING KIT 9/15 D6T HUB
5	V2370101	KIT FRONT AXLE 15MM CROSSONE/-RIDE/-ROC - while stock last
6	V2370301	FRONT AUTO ADJUST.PLAY KIT 15MM AXLE

COMPATIBILITY

Freewheel: Shimano/Sram	
Freewheel: Shimano/Sram	
Freewheel: Shimano/Sram	
Freewheel: Shimano/Sram	
Front axle: convertible from 15mm thru axle to Quick Release with included adapters	
Front axle: convertible from 15mm thru axle to Quick Release with included adapters	
Front axle: convertible from 15mm thru axle to Quick Release with included adapters	
Front axle: convertible from 15mm thru axle to Quick Release with included adapters	
Front axle: convertible from 15mm thru axle to Quick Release with included adapters	
Front axle: convertible from 15mm thru axle to Quick Release with included adapters	
Front axle: convertible from 15mm thru axle to Quick Release with included adapters	
ID360 ā□·ā□□ā□□ ā□'ā□□ā□%ā□« ā□□ā□ā□%ā□□ ā□≡ā□%ā□«ā□□ā□□ā□£ī'%□[V379 0101]ī'%□	
ā□°ā□¢ā□¢ā□`ā□'ā□«ī'%□12x148m m ā□□ā□%ā□'ā□□ ā□'ā□«ā□%ā□¢ā□`ā□'ā□«	
ID360 N3W ā□□ā□°ā□%ā□□ā□≡ā□ %ā□«ā□□ā□□ā□£ī'%□[V4270101]ī'% □	
ā□°ā□¢ā□¢ā□`ā□'ā□«ī'%□12mmā□' ā□«ā□%ā□¢ā□`ā□'ā□«ā□□ā□¢ā□ □ā□□ā□¿ā□%ā□□ā□%¿ā□□ā□`ā□ ≡ā□□ā□`ā□°ā□°ā□%ā□'ā□,çµ□ā□ ¿æ□¿ā□□ā□□ā□`è□½	