

ASTM CATEGORY 3 : offroad with jumps less than 61cm

Recommended weight limit : 120kg

For a longer longevity of the wheel, Mavic recommends that the total weight supported by the wheels doesn't exceed 150kg, bike included

Maximum tyre pressure: 2.95bar/43PSI with a 52mm tyre - 1.55bar/22PSI with a 125mm tyre

Maximum tyre pressure: 3.2bar/46PSI with a 47mm tyre - 2.85bar/41PSI with a 64mm tyre

ETRTO recommended tyre sizes: 25mm to 52mm (1" to 2.05")

REFERENCES WHEELS

R83701 CROSSRIDE RB 26 QR M10

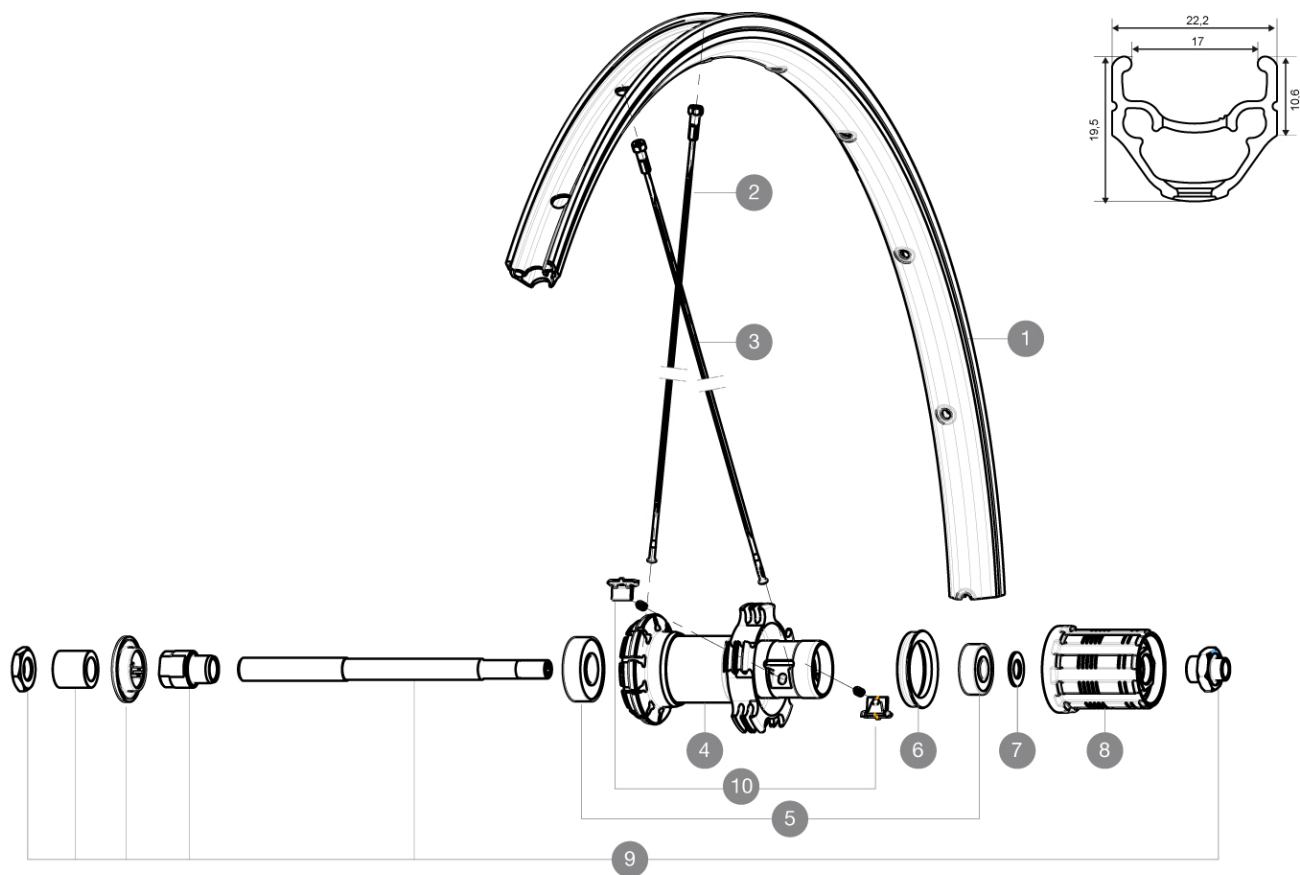

RIMS



VALVE HOLE (MM): 8,5 WITH POP OFF REDUCER :

1 12021815 KIT FRONT/REAR CROSSRIDE UB 2011 RIM

SPOKES

2 99606901 KIT 10 FT/NDS CROSSRIDE UB 08 BLACK SPOKE
3 99607001 KIT 10 DS CROSSRIDE UB 08 BLACK SPOKE 276mm

HUB SHELLS

4 N/A HUB BODY
5 M40660 REAR HUB 608+6001 BEARINGS
6 99500001 FTSL/FTSX FREEHUB BODY SEAL
7 M40067 INTERNAL FREEWHEEL SPACER FTSL/FTSX
8 30871101 FTS-L ROAD FREEWHEEL BODY HG11 8/9 compatible
9 32348301 REAR AXLE QRM MTB UB
10 32430301 FTSX PAWLS KIT (MTB WHEELS)



CROSSRIDE UB 26

DELIVERED WITH

BR101 quick releases	
Rim tape	
BR101 quick releases	
BR101 quick releases	
BR101 quick releases	
BR101 quick releases	
BR101 quick releases	
BR101 quick releases	
BR101 quick releases	
BR101 quick releases	
User guide	
Valve reducer	
Rear QR adapters (non-boost wheel)	
Rim tape	
Rim tape	
Rim tape	
Rim tape	
Rim tape	
Rim tape	

COMPATIBILITY

Freewheel: Shimano/Sram	
Freewheel: Shimano/Sram	
Freewheel: Shimano/Sram	
Freewheel: Shimano/Sram	
Front axle: Quick Release only	
Front axle: Quick Release only	
Front axle: Quick Release only	
Front axle: Quick Release only	
Front axle: Quick Release only	
Front axle: Quick Release only	
Front axle: Quick Release only	
Rear axle: Quick Release only	
Rear axle: Quick Release only	
Rear axle: Quick Release only	
Rear axle: Quick Release only	
Rear axle: 12mm thru axle, convertible to Quick Release with adapters (delivered with non-boost wheel)	