

ASTM CATEGORY 1 : road only

For a longer longevity of the wheel, Mavic recommends that the total weight supported by the wheels doesn't exceed 120kg, bike included

Recommended tyre sizes: 21 to 28 mm

Max. Pressure: 23mm 8.7 bars - 125 psi

## 参照ホイール

F71841 CosCarb40Elite16Frt Black

F71843

CosCarb40Elite16Frt CHROME

F71842 CosCarb40Elite16Frt White

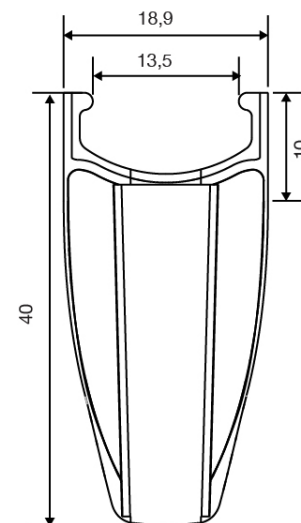
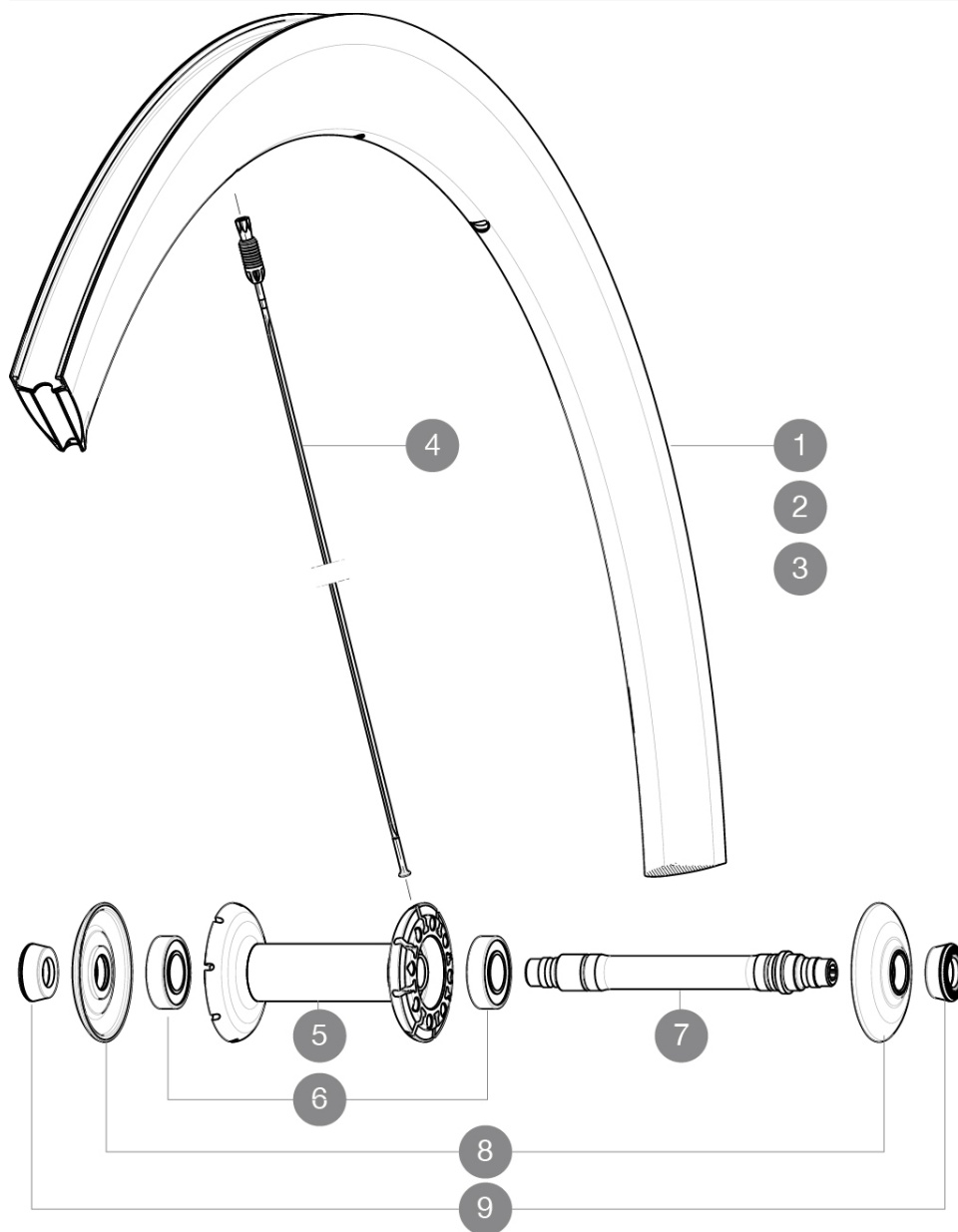

## RIMS



バルブ穴径 ( MM ) : 6,5 :

1	V2400610	FRONT RIM CC 40 ELITE WHITE
2	V2400810	FRONT RIM CC 40 ELITE BLACK
3	V2404310	FRONT RIM CC40 ELITE CHROME

## SPOKES

4	V3664201	KIT 12 FRT/NDStAINLESS SPOKE CC40 C 277mm
4	32979001	KIT 10 AERO FT/NDStAINLESS SPOKE CC 40 C BLACK SPOKE 277mm - while stock !

## HUB SHELLS

5	N/A	HUB BODY
6	M40078	FRONT HUB 6901 BEARINGS
7	30870001	FRONT AXLE ROAD RIM BRAKING QRM +

8 32985701 HUB CAP & ADJUST.NUT CXR 80

## ADAPTERS

9 35117301 FRONT OR REAR FORK REST KIT R-SYS 2013



# Cosmic Carbone 40 Elite

## 付属品

BR301 quick releases	
Carbon brake pads	
BR301 quick releases	
Carbon brake pads	
Multifunction adjustment wrench	
User guide	
Multifunction adjustment wrench	
User guide	

## Specifications

### リム

- Material : 3K carbon fibers with aluminum cooling system
- Height : 40 mm
- Drilling : co-molded Fore drilled inserts
- Brake track : carbon
- Material : 3K carbon fibers with aluminum cooling system
- Brake track : carbon with TgMAX technology
- Valve hole diameter : 6.5 mm
- Tyre : clincher
- ETRTO size : 622x13C
- Recommended tyre sizes : 21 to 28 mm
- Height : 40 mm
- Drilling : co-molded Fore drilled inserts
- Brake track : carbon with TgMAX technology
- Brake track : carbon
- Valve hole diameter : 6.5 mm
- Tyre : clincher
- ETRTO size : 622x13C

### スポーク

- Material : steel
- Shape : straight pull, bladed, double butted
- Nipples : Fore integrated aluminum
- Count : front 16, rear 20
- Lacing : radial front and rear non-drive side, crossed 2 rear drive side
- Material : steel
- Shape : straight pull, bladed, double butted
- Nipples : Fore integrated aluminum
- Count : front 16, rear 20
- Lacing : radial front and rear non-drive side, crossed 2 rear drive side

### ホイールハブ

- Front and rear bodies : aluminum
- Axle material : aluminum
- Adjustable sealed cartridge bearings
- Freewheel : FTS-L steel
- Front and rear bodies : aluminum
- Axle material : aluminum
- Adjustable sealed cartridge bearings
- Freewheel : FTS-L steel

### ホイールの重み

ホイール重量 ( クイックリリースおよびクリンチャー/チューブラーを除く ) ( g ) : 670