



Ksyrium Pro Carbon SL T Disc

参照ホイール

R78201 KsyProCarbSLTDiscCLRr

ASTM CATEGORY 2 : road and offroad with jumps less than 15cm
 For a longer longevity of the wheel, Mavic recommends that the total weight supported by the wheels doesn't exceed 120kg, bike included
 23mm
 Recommended tyre sizes: 25 to 52 mm
 23mm 8.7 bars - 125 psi, 25mm 7.7 bars - 110 psi
 Max. Pressure: 25mm 7.7 bars - 110 PSI

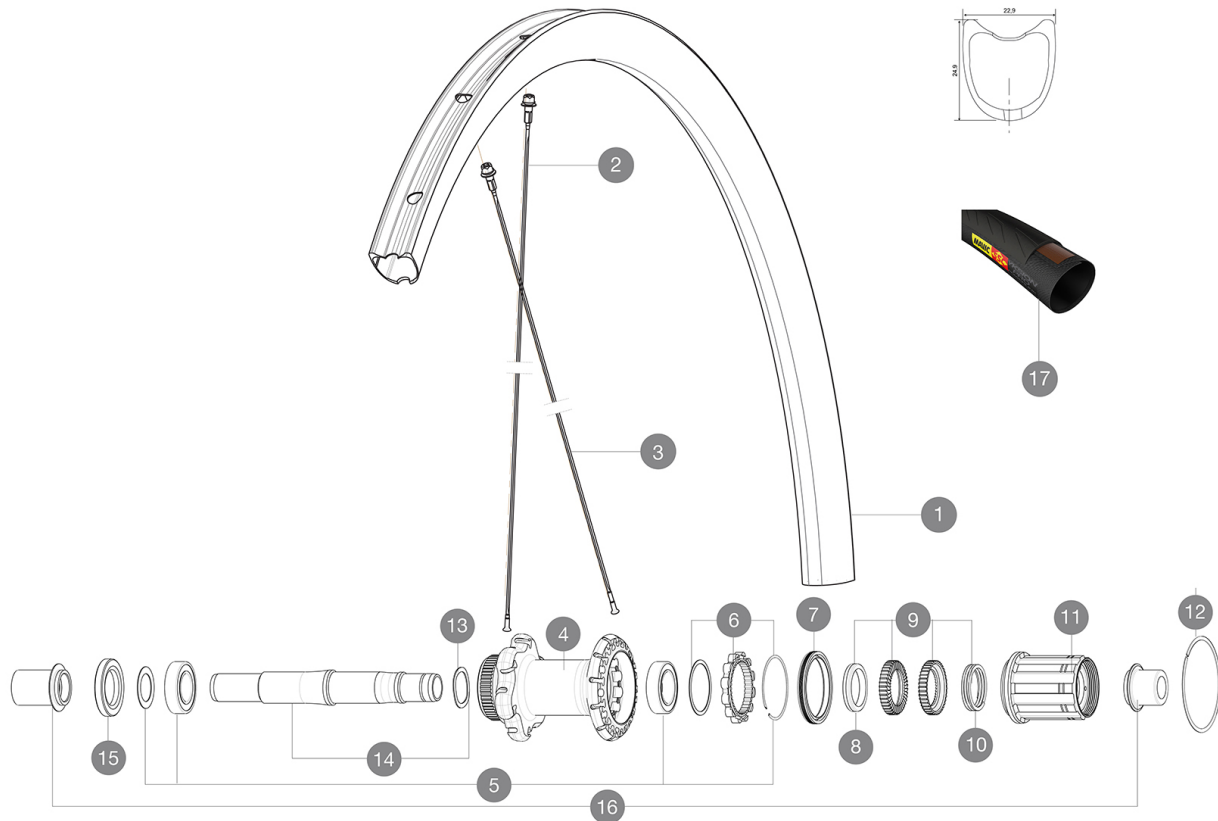

RIMS



バルブ穴径 (MM) : 6.5 :

1	V2404113	REAR RIM KSYRIUM PRO CARB SL DISC Tub
---	----------	---------------------------------------

SPOKES

2	V2271401	KIT 12 DS KSYRIUM PRO CARB SL T SPOKE 273mm - while stock la
2	V3663201	KIT 12 DS KSY PRO CARB SL UST/UST Disc/C Disc/T Disc BUTTED
3	V3663301	KIT 12 FRT KSYR PRO CARB SL UST Disc + NDS KSYR PRO CARB
3	V2271501	12 FT KSY PRO CARB SL D/NDS KSY PRO CARB SL SPK 291mm

HUB SHELLS

4	N/A	HUB BODY
5	V2560201	KIT ID360 BEARINGS 15/28/7 + 17/28/7
6	V2252701	KIT ID360 INSERT SHAPED EAR LOBE > 2017
7	V2251601	ID360 SEAL + GREASE
8	V2500501	Kit 3 ID360 pad for noise reduction
9	V2251701	ID360 2 RATCHETS + SPRING + GREASE
10	V2251801	KIT 3 ID360 ROAD SPRINGS
11	V3430101	HG11 Freewheel Body ID360
12	V2252201	KIT 2 REAR HUB RETENTION RINGS 48mm
13	V2251501	3 ID360 WAVE WASHERS
14	V2251401	ID360 AXLE DISC CL
15	V2251101	KIT ID360 HUB THREADED CAP DISC CENTER LOCK

TYRES

17	37804625	Yksion Pro PowerLink Tubular SSC 25
----	----------	-------------------------------------

ADAPTERS

16	B4989801	Rear axle adapters 9mm/135 QR (centerlock)
----	----------	--



Ksyrium Pro Carbon SL T Disc

付属品

BR601 quick releases	
Front 12 mm adapters	
Specific disc bolts	
User guide	
Front 12 mm adapters (B4104201) 1	
Rear 12x142mm adapters for Instant Drive 360 (B49 896 01 for ID360 6T, B49 899 01 for ID360 CL) 1	
Specific disc bolts	
Multifunction adjustment wrench (325 423 01) 1	
Multifunction adjustment wrench (325 423 01) 1	
User guide	
User guide	

COMPATIBILITY

<p>Freewheel: Shimano/Sram or Campagnolo, convertible to XD-R with optional driver body</p>	
<p>Front axle: convertible from 12mm thru axle to quick release or 15mm thru axle with optional adapters</p>	
<p>Front axle: convertible from 12mm thru axle to quick release or 15mm thru axle with optional adapters</p>	
<p>Rear axle: 12mm thru axle, convertible to Quick Release with optional adapters</p>	
<p>Rear axle: 12mm thru axle, convertible to Quick Release with optional adapters</p>	

Specifications

リム

- Material : 3K carbon fibers
- Height : 25mm
- Drilling : traditional
- Material : 3K carbon fibers
- Material : 3K carbon fibers
- Disc brake specific profile
- Valve hole diameter : 6.5 mm
- Tyre : tubular
- ETRTO size : 28" tubular
- Height : 25mm
- Height : 25mm
- Recommended tyre sizes : 25 to 52 mm
- Drilling : traditional
- Drilling : traditional
- Disc brake specific profile
- Disc brake specific profile
- Valve hole diameter : 6.5 mm
- Valve hole diameter : 6.5 mm
- Tyre : tubular
- Tyre : tubular
- ETRTO size : 28" tubular
- ETRTO size : 28" tubular

スポーク

- Material : steel
- Shape : straight pull, bladed, double butted
- Nipples : aluminum, ABS
- Count : 24 front and rear
- Material : steel
- Material : steel
- Lacing : front crossed 2, rear Isopulse
- Shape : straight pull, bladed, double butted
- Shape : straight pull, bladed, double butted
- Nipples : aluminum, ABS

ホイールハブ

- Front and rear bodies : aluminum
- Axle material : aluminum
- Sealed cartridge bearings
- Freewheel : Instant Drive 360
- Front and rear bodies : aluminum
- Front and rear bodies : aluminum
- Front : Quick release, 12 thru and 15 thru compatible
- Axle material : aluminum
- Axle material : aluminum
- Rear : 12x142 (convertible to quick release with optional adapters)
- Sealed cartridge bearings
- Freewheel : Instant Drive 360
- Freewheel : Instant Drive 360
- Front : Quick release, 12 thru and 15 thru compatible
- Rear : 12x142 (convertible to quick release with optional adapters)

VERSIONS

- Color : Black only
- Color : Black only
- Disc standard : Center Lock(R) only
- Disc standard : Center Lock(R) only

ホイールの重み

ホイール重量 (クイックリリー
スおよびクリンチャー/チュー
ブラーを除く) (g) : 695