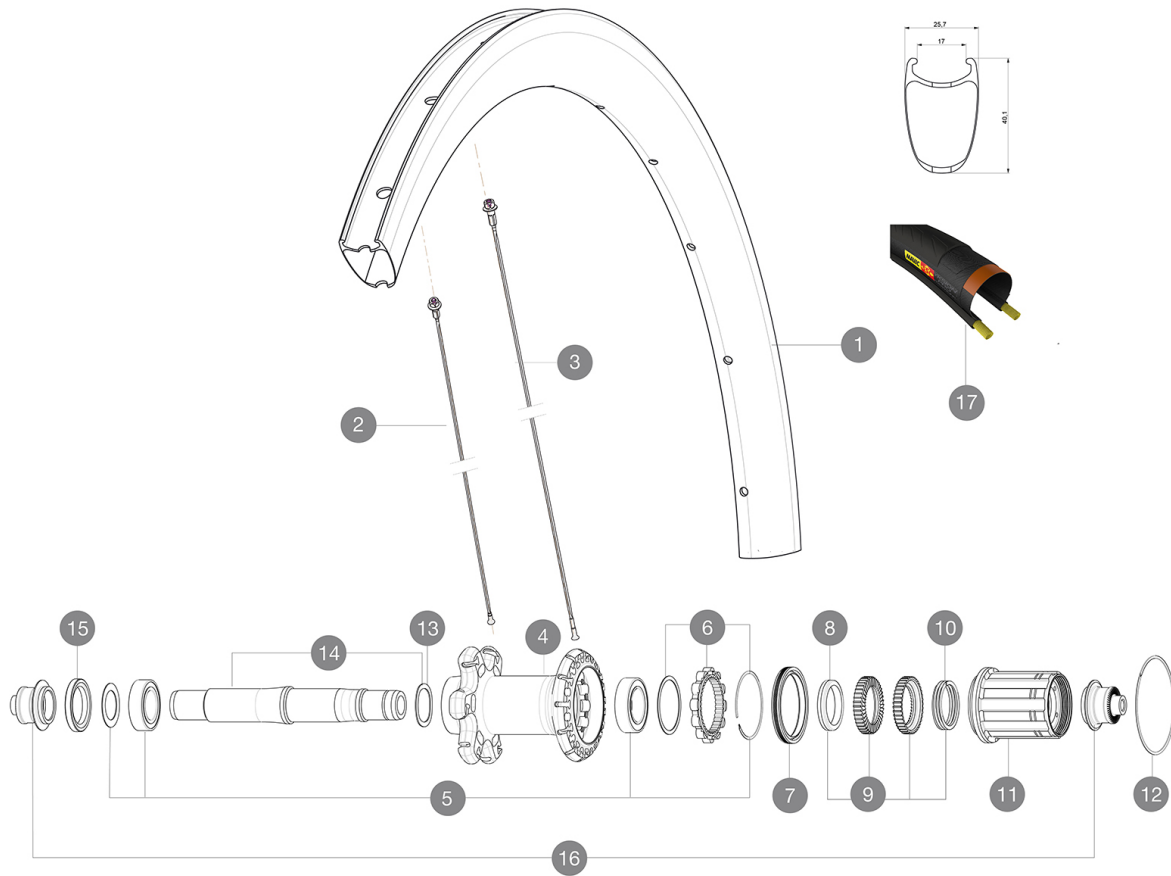

**MAVIC** *Cosmic Pro Carbon SL C*

ASTM CATEGORY 1 : road only  
 Recommended weight limit : 120kg  
 Recommended tyre sizes: 25 to 52 mm  
 Max. Pressure: 25mm 7.7 bars - 110 PSI

**REFERENCES WHEELS**

|        |                         |        |                    |
|--------|-------------------------|--------|--------------------|
| R88801 | CosProCarbSLCRr+CD      | R72001 | CosmicProCarbSLCRr |
| R98301 | CosmicProCarbSL C Rr+CD |        |                    |

**RIMS**

VALVE HOLE  $\bar{A}$  (MM): 6,5 :

|   |          |   |
|---|----------|---|
| 1 | V4092713 | Kit Rear rim Cosmic SL 40 RB                                |
| 1 | V2736413 | KIT REAR RIM COSMIC PRO CARBON SL UST 19 - while stock last |
| 1 | V2401113 | KIT RR RIM COSMIC PRO CARBON SL Clincher - While stock last |
|   | V2690101 | KIT CARBON RIM TAPE 21x622mm - FOR CARBON RIM               |
|   | V3720101 | 25mm UST Tape for 19 to 22mm Road Rims                      |

**SPOKES**

|   |          |  |
|---|----------|--|
| 2 | V2271201 | KIT 12 NDS COS PRO CARB SL/FT SL D/FT & NDS UST & UST D SPK  |
| 2 | V3663001 | KIT 12 FR1/NDS COSMIC PRO CARB SL UST/UST Disc C/C Disc/T Di |
| 3 | V3662801 | KIT 12 DS COSMIC PRO CARB SL T/UST/UST Disc/C/C Disc BUTTED  |
| 3 | V2271101 | KIT 12 DS COS PRO CARB SL/SL UST 1 UST D LTD AERO SPK 260mm/ |

**HUB SHELLS**

|    |          |   |
|----|----------|---|
| 4  | N/A      | HUB BODY                                |
| 5  | V2560101 | KIT ID360 BEARINGS 15/26/7 + 17/28/7    |
| 6  | V2252701 | KIT ID360 INSERT SHAPED EAR LOBE > 2017 |
| 7  | V2251601 | KIT ID360 SEAL + GREASE                 |
| 8  | V2500501 | KIT ID360 3 PADS NOISE REDUCING         |
| 9  | V2251701 | KIT ID360 2 RATCHETS + SPRING + GREASE  |
| 10 | V2251801 | KIT 3 ID360 ROAD SPRINGS                |
| 11 | V3430101 | HG11 Freewheel Body ID360               |
| 12 | V2252201 | KIT 2 REAR HUB RETENTION RINGS 48mm     |
| 13 | V2251501 | KIT 3 ID360 WAVE WASHERS                |

|    |          |   |
|----|----------|---|
| 14 | V2251201 | KIT ID360 AXLE UB                               |
| 15 | V2250901 | KIT ID360 HUB THREADED CAP for UB model (small) |

**TYRES**

|    |          |                      |
|----|----------|----------------------|
| 17 | 37805525 | YksionProPowerLinkWH |
|----|----------|----------------------|

**ADAPTERS**

|    |          |                                 |
|----|----------|---------------------------------|
| 16 | B4989401 | ADAPTER Rr 9mm QR ID360 (6bolt) |
|----|----------|---------------------------------|

**DELIVERED WITH**

|                                 |  |
|---------------------------------|--|
| BR601 quick releases            |  |
| Rim tape                        |  |
| BR601 quick releases            |  |
| Carbon brake pads               |  |
| Carbon brake pads               |  |
| Multifunction adjustment wrench |  |
| User guide                      |  |
| Rim tape                        |  |
| Multifunction adjustment wrench |  |
| User guide                      |  |

**COMPATIBILITY**

|  |  |
|--|--|
| Freewheel: Shimano/Sram or Campagnolo, convertible to XD-R with optional driver body |  |
| Front axle: Quick Release only   |  |
| Rear axle: Quick Release only  |  |

**Specifications****RIMS**

- **Material** : 3K carbon fibers
- **Height** : 40 mm
- **Material** : 3K carbon fibers
- **Drilling** : traditional
- **Brake track** : carbon with TgMAX technology
- **Valve hole diameter** : 6.5 mm
- **Tyre** : clincher
- **Internal width** : 17 mm
- **ETRTO size** : 622x17C
- **Recommended tyre sizes** : 25 to 52 mm
- **Height** : 40 mm
- **Drilling** : traditional
- **Brake track** : carbon with TgMAX technology
- **Valve hole diameter** : 6.5 mm
- **Tyre** : clincher
- **Internal width** : 17 mm
- **ETRTO size** : 622x17C

**SPOKES**

- **Material** : steel
- **Shape** : straight pull, bladed, double butted
- **Nipples** : aluminum, ABS
- **Count** : front 18, rear 24
- **Lacing** : front radial, rear Isopulse
- **Material** : steel
- **Shape** : straight pull, bladed, double butted
- **Nipples** : aluminum, ABS
- **Count** : front 18, rear 24
- **Lacing** : front radial, rear Isopulse

**WHEEL HUB**

- **Front and rear bodies** : aluminum
- **Axle material** : aluminum
- Sealed cartridge bearings
- **Freewheel** : Instant Drive 360
- **Front and rear bodies** : aluminum
- **Axle material** : aluminum
- Sealed cartridge bearings
- **Freewheel** : Instant Drive 360

**VERSIONS**

- **Color** : Black only

**WHEEL WEIGHTS**

Wheel weight 825