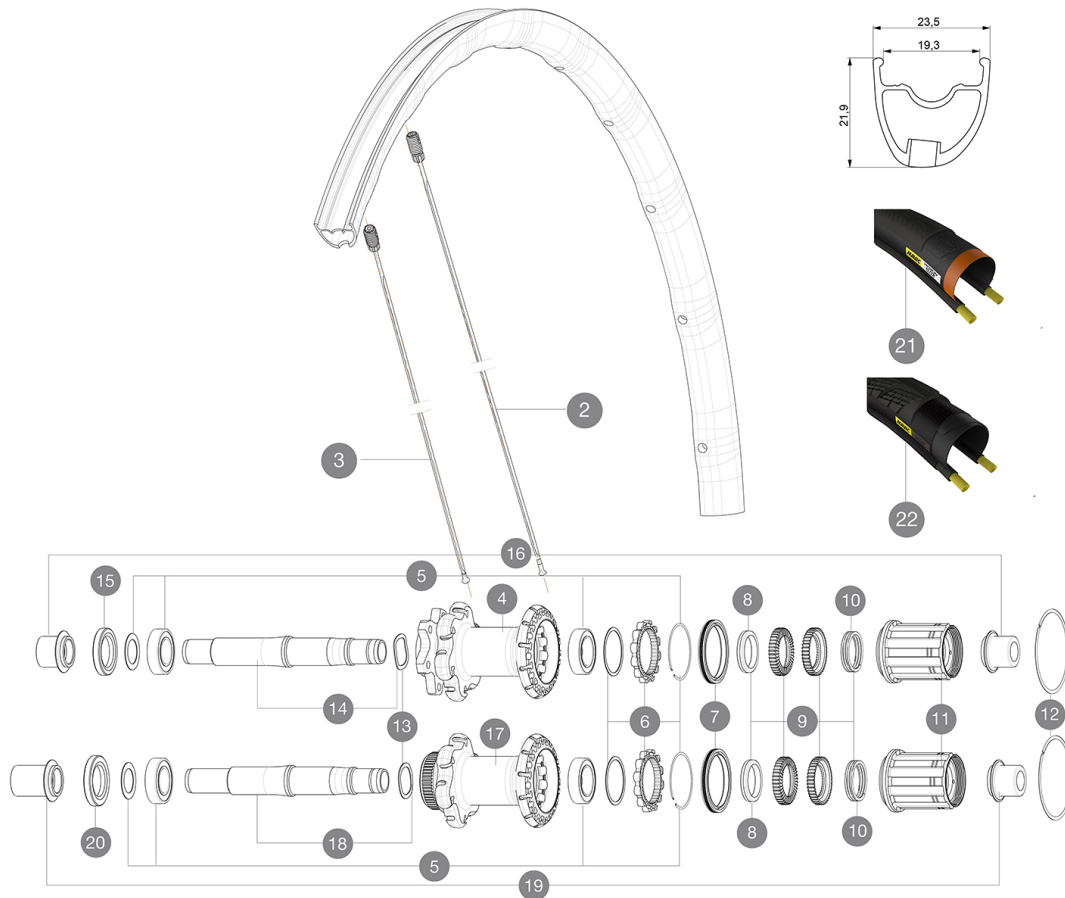

MAVIC *Ksyrium Elite Allroad Disc UST*

ASTM CATEGORY 2 : road and offroad with jumps less than 15cm
 Recommended weight limit : 120kg
 Recommended tire sizes: 28 to 42 mm
 Max. Pressure: 28mm 7.7 bars - 110 PSI / 30mm 5.8 bars - 85 PSI

REFERENCES WHEELS

| | | | |
|--------|----------------------|--------|----------------------|
| R83001 | KsyElAIRD6BRr 12x142 | R86701 | KsyElAIRDCLRr 12x142 |
|--------|----------------------|--------|----------------------|

**RIMS**

&NBSP;:

| | | |
|---|----------|------------------------------------|
| 1 | V2405813 | KIT REAR RIM KSYRIUM ELITE ALLROAD |
|---|----------|------------------------------------|

SPOKES

| | | |
|---|----------|--|
| 2 | V2273201 | KIT 12 FRT/NON DRIVE SIDE BUTTED SPOKE 297mm |
| 3 | V2273301 | KIT 12 DRIVE SIDE BUTTED SPOKE 280mm |

HUB SHELLS

| | | |
|----|----------|--|
| 4 | N/A | HUB BODY |
| 5 | V2560201 | KIT ID360 BEARINGS 15/28/7 + 17/28/7 |
| 6 | V2252701 | KIT ID360 INSERT SHAPED EAR LOBE > 2017 |
| 7 | V2251601 | KIT ID360 SEAL + GREASE |
| 8 | V2500501 | KIT ID360 3 PADS NOISE REDUCING |
| 9 | V2251701 | KIT ID360 2 RATCHETS + SPRING + GREASE |
| 10 | V2251801 | KIT 3 ID360 ROAD SPRINGS |
| 11 | V3430101 | HG11 Freewheel Body ID360 |
| 12 | V2252201 | KIT 2 REAR HUB RETENTION RINGS 48mm |
| 13 | V2251501 | KIT 3 ID360 WAVE WASHERS |
| 14 | V2251301 | KIT ID360 AXLE DISC 6 BOLTS |
| 15 | V2251001 | KIT ID360 HUB THREADED CAP UB+DISC 6 BOLTS (large) - while s |
| 17 | N/A | HUB BODY |
| 18 | V2251401 | KIT ID360 AXLE DISC CENTER LOCK |
| 20 | V2251101 | KIT ID360 HUB THREADED CAP DISC CENTER LOCK |

TYRES

| | | |
|----|----------|-------------------------|
| 21 | 37805628 | Yksion EliteGuard White |
| 22 | 38012230 | Yksion Elite Allroad |





ADAPTERS

| | | |
|----|----------|-----------------------------------|
| 16 | B4989601 | ADAPTER Rr 12x142mm ID360 (6bolt) |
| 19 | B4989901 | ADAPTER Rr 12x142mm ID360 (Lock) |

MAVIC Ksyrium Elite Allroad Disc UST

2017
REAR

DELIVERED WITH

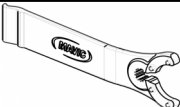
| | |
|---|---|
| 1 bottle of Mavic Sealant (355 466 01) 1 |  |
| Front 12 mm adapters (B4104201) 1 |  |
| Rear 12x142mm adapters for Instant Drive 360 (B49 896 01 for ID360 6T, B49 899 01 for ID360 CL) 1 |  |
| UST valve and accessories (129 838 01) |  |
| Specific disc bolts (308 719 01) Pack of 6 |  |
| Multifunction adjustment wrench (325 423 01) 1 |  |
| User guide | |

COMPATIBILITY

| | |
|---|--|
| Freewheel: Shimano/Sram, convertible to Campagnolo and XD-R with optional driver bodies | |
| Front axle: convertible from 12mm thru axle to quick release or 15mm thru axle with optional adapters | |
| Rear axle: 12mm thru axle, convertible to Quick Release with optional adapters | |

Specifications

RIMS

- **Material** : Maxtal
- **Height** : 26mm, asymmetrical
- **Joint** : SUP
- **Drilling** : Fore

Disc brake specific profile

- **Weight reduction** : ISM 4D
- **Valve hole diameter** : 6.5 mm
- **Tire** : UST Tubeless and tubetype
- **Internal width** : 19 mm
- **ETRTO size** : 622x19C

SPOKES

- **Material** : steel
- **Shape** : straight pull, bladed
- **Nipples** : Fore integrated aluminum
- **Count** : 24 front and rear
- **Lacing** : front crossed 2, rear Isopulse

WHEEL HUB

- **Front and rear bodies** : aluminum
 - **Axle material** : aluminum
- Sealed cartridge bearings
- **Freewheel** : Instant Drive 360
 - **Front** : Quick release, 12 thru and 15 thru compatible
 - **Rear** : 12x142 (convertible to quick release with optional adapters)

VERSIONS

- **Color** : Black only
- **Disc standard** : 6 Bolts or Center Lock(R)

WHEEL WEIGHTS

Wheel weight 910