

# MAVIC Ksyrium Pro Exalith

ASTM CATEGORY 2 : road and offroad with jumps less than 15cm

Recommended weight limit : 120kg

Recommended tire sizes: 25 to 32 mm

Max. Pressure: see indication on wheel and tyre. If they differ, use the lower of the 2

Max. Pressure: 23mm 8.7 bars - 125 psi, 25/28mm 7.7 bars - 110 psi

Max. Pressure: 25mm 7.7 bars - 110 PSI

## REFERENCES WHEELS

R89101 KsyriumProExalith17 Rr

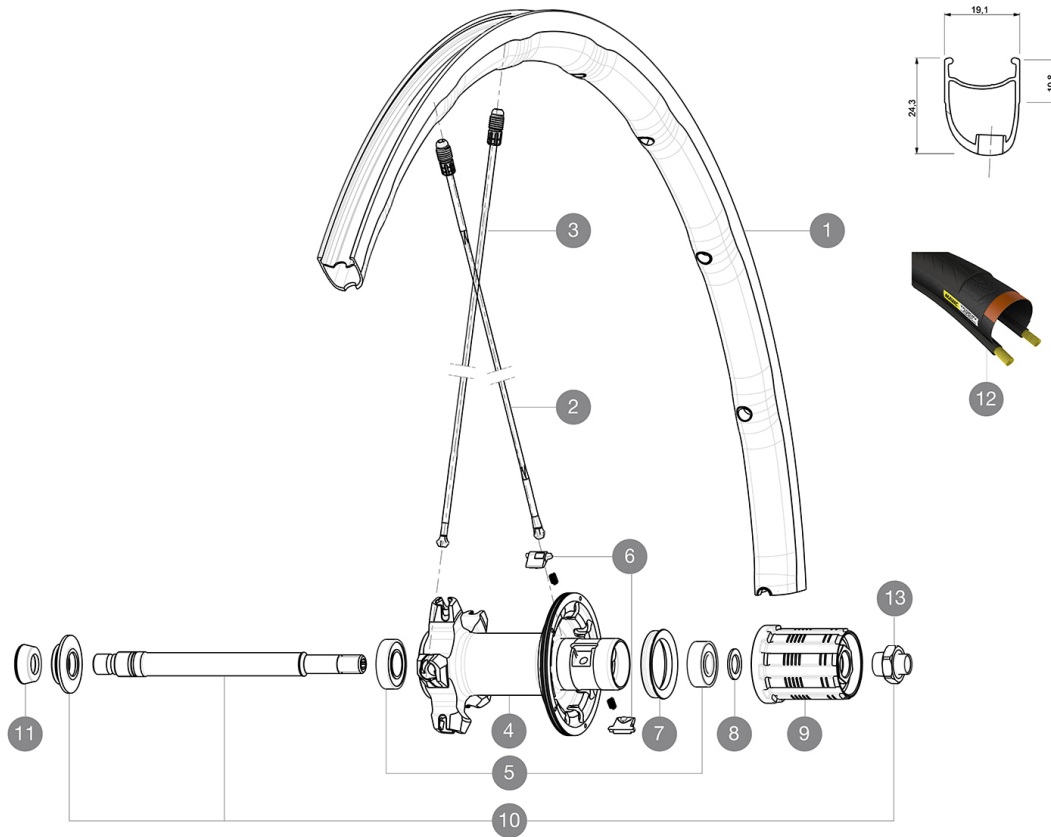

## RIMS



&NBSP;:

1 V2405613 KIT REAR RIM KSYRIUM PRO EXALITH

## SPOKES

2 V2270501 KIT 12 DS KSY PRO/PRO DISC/SL C/PRO EXA SPK 273,5mm  
3 10844701 KIT 10 DS R-SYS SL/SLR TUB ALU LTD SPK 297,5mm

## HUB SHELLS

4 N/A HUB BODY  
5 33000001 REAR HUB B9+6901 BEARINGS 2013  
6 M40578 FTSL PAWLS KIT (ROAD WHEELS)  
7 99500001 FTSL/FTSX FREEHUB BODY SEAL  
8 30872801 SET OF 3 INTERNAL SILVER SPACERS 9mm FTS-L  
9 30871101 FTS-L ROAD FREEWHEEL BODY HG11 8/9 compatible  
9 30871201 FTS-L ROAD FREEWHEEL BODY ED11 8/9 compatible  
10 V2250501 KIT REAR AXLE KSYRIUM SLE/SLS/ELITE/PRO EXALITH/ALLROAD ELIT  
13 V2373101 KIT NUT FOR ROAD ALLOY THROUGH AXLE 9mm

## TYRES

12 37805525 YksionProPowerLinkWH

## ADAPTERS

11 35117301 FT/RR FORK REST R-SYS/CC ULTIMATE > 2013/KSY PRO CARB T

# MAVIC Ksyrium Pro Exalith

## DELIVERED WITH

BR601 quick releases (V24 501 01 frt, V24 502 01 rear) 1	
BR601 quick releases (V24 501 01 frt, V24 502 01 rear) 1	
BR601 quick releases (V24 501 01 frt, V24 502 01 rear) 1	
BR601 quick releases (V24 501 01 frt, V24 502 01 rear) 1	
Exalith brake pads (V24 703 01 Shimano/Sram, V24 704 01 Campagnolo) 1	
Exalith brake pads (V24 703 01 Shimano/Sram, V24 704 01 Campagnolo) 1	
Exalith brake pads (V24 703 01 Shimano/Sram, V24 704 01 Campagnolo) 1	
Exalith brake pads (V24 703 01 Shimano/Sram, V24 704 01 Campagnolo) 1	
Multifonction adjustment wrench (325 423 01) 1	
Multifonction adjustment wrench (325 423 01) 1	
Multifonction adjustment wrench (325 423 01) 1	
Multifonction adjustment wrench (325 423 01) 1	
User guide	
User guide	
User guide	
User guide	

## COMPATIBILITY

Freewheel: Shimano/Sram, convertible to Campagnolo with optional driver body	
Freewheel: Shimano/Sram, convertible to Campagnolo with optional driver body	
Freewheel: Shimano/Sram, convertible to Campagnolo with optional driver body	
Freewheel: Shimano/Sram, convertible to Campagnolo with optional driver body	
Front axle: Quick Release only	
Front axle: Quick Release only	
Front axle: Quick Release only	
Front axle: Quick Release only	
Rear axle: Quick Release only	
Rear axle: Quick Release only	
Rear axle: Quick Release only	
Rear axle: Quick Release only	

## Specifications

### RIMS

- Material : Mactal
- Material : Mactal
- Material : Mactal
- Material : Mactal
- Height : front 24mm, rear 26 asymmetrical

### WHEEL HUB

- Rear body : aluminum
- Rear body : aluminum
- Rear body : aluminum
- Rear body : aluminum
- Front body : carbon with aluminum flanges

### WHEEL WEIGHTS

Wheel weight 845