

MAVIC Crossmax Elite 29

1
2017
REAR

ASTM CATEGORY 3 : offroad with jumps less than 61cm
Recommended weight limit : 120kg
Recommended tire sizes: 28 mm to 62 mm (1.1" to 2.5")

REFERENCES WHEELS

| REAR WHEEL | N° | PARTS | REFERENCE | REFERENCE BOOST |
|----------------|--------------|-------------------|-----------|-----------------|
| CROSSMAX ELITE | 4BIS / 15BIS | HUB BODY | N/A | N/A |
| | 6 BIS | AXLE | V2372101 | V2372201 |
| | 10 BIS | RATCHET | V2375201 | |
| | 13 BIS | ADAPTORS | V2510701 | |
| | 11 BIS | SHIMANO FREEWHEEL | V3780101 | |
| | 12 BIS | SRAM XD FREEWHEEL | V3740101 | |

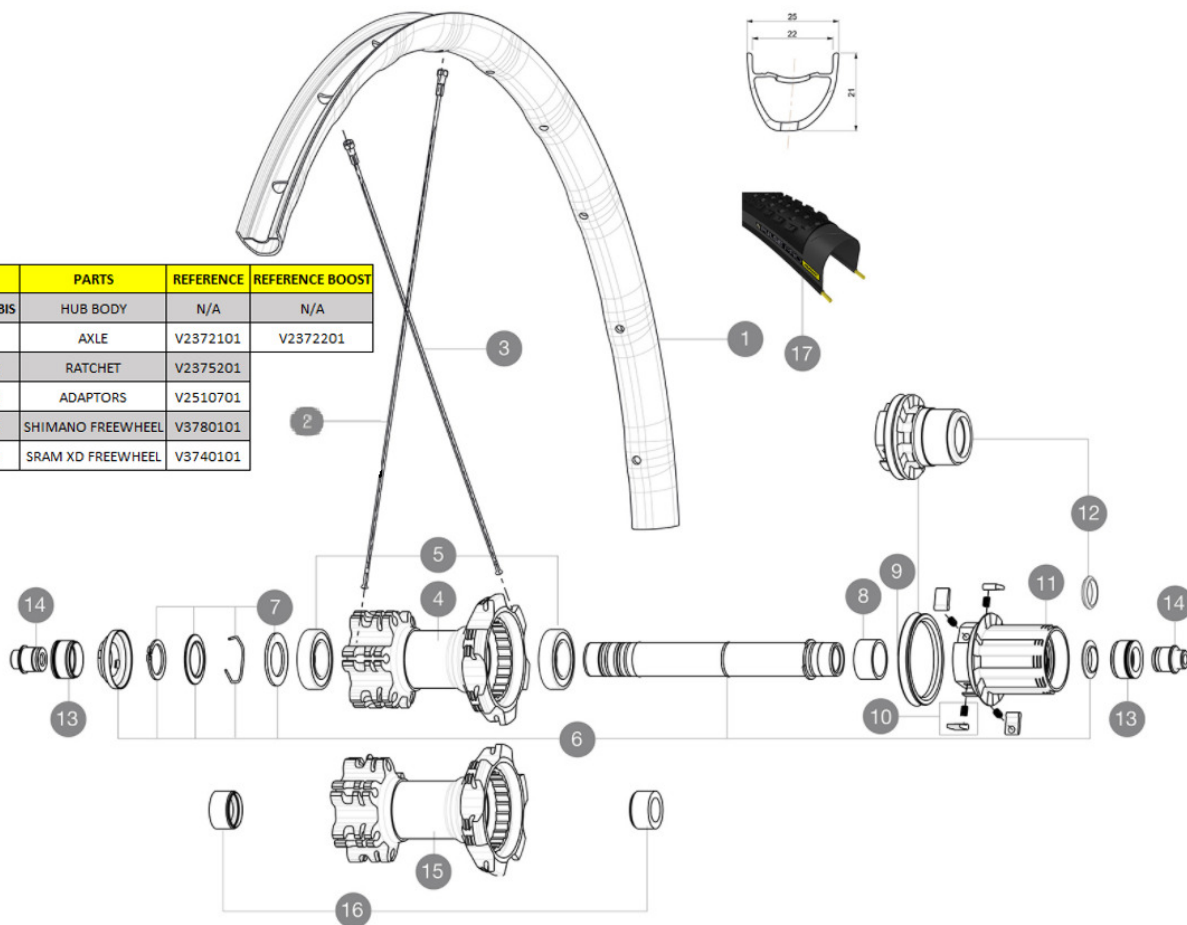

RIMS



VALVE HOLE (MM): 6,5 :

| | | |
|---|----------|------------------------------------------------------------|
| 1 | V2950115 | KIT FT/RR RIM CROSSMAX EL 29" 22mm BLK TSS - while stock I |
| 1 | V2970115 | KIT FT/RR RIM CROSSMAX EL 29" 22mm RED TSS - while stock I |
| | V2620101 | UST RIM TAPE 25mm (for 21-24mm wide rim) |

SPOKES

| | | |
|---|----------|---------------------------------------------------------------|
| 2 | V2382301 | KIT 12 DS XRIIDE + FTSX/NDX XMAX EL/XA EL 29" SPK 297mm |
| 3 | 36689601 | "KIT 12 DS CROSSROC/XRIIDE UST/XMAX ELITE/XA ELITE 29"" SPK 2 |

HUB SHELLS

| | | |
|----|----------|------------------------------------------------------------|
| 4 | N/A | HUB BODY |
| 4 | N/A | HUB BODY |
| | N/A | HUB BODY |
| 5 | M40076 | HUB BEARINGS 17x30x7 6903 x 2 |
| 6 | V2371201 | KIT REAR QRM AXLE 135-142mm/BOOST 148mm |
| | V2372101 | KIT ID360 135/142 D6T AXLE WITH CLIP |
| | V2372201 | KIT ID360 148 D6T AXLE WITH CLIP |
| 7 | V2370401 | KIT REAR AUTO ADJUSTING PLAY 12mm AXLE |
| 8 | 35124501 | SET OF 3 REAR AXLE/FREEWHEEL BODY SPACERS MTB L1 |
| 9 | 99610701 | ITS-4 FREEWHEEL SEAL |
| 10 | 99610601 | PAWLS KIT FOR ITS-4 (OR TS-2) |
| | V2375201 | KIT ID360 24 TEETH 2 RATCHET + MTB SPRING + PAD (specific) |
| 11 | 35126001 | ITS-4 FREEWHEEL BODY + SEAL 2013 (NO PAWLS) |
| | V3780101 | HG9 Alloy MTB Freewheel Body ID360 |
| 12 | 35684101 | FREEHUB BODY XD TS2/ITS-4 |

V3740101 XD MTB Freewheel Body ID360

| | | |
|----|-----|----------|
| 15 | N/A | HUB BODY |
| 15 | N/A | HUB BODY |
| | N/A | HUB BODY |

TYRES







| | | |
|----|----------|--------------|
| 17 | 39243232 | Pulse Pro 29 |
| 17 | 39243221 | Pulse Pro 29 |

ADAPTORS

| | | |
|----|----------|----------------------------------------------|
| 13 | 30872201 | FRAME SUPPORT ITS-4 135mm REAR AXLE > 2012 |
| | V2510701 | ID360V2RrAxleAdapt12x142/148 |
| 14 | 30873101 | 2 REAR REDUCERS 12/9,5mm 2012 ITS4 HUB |
| 16 | V2371401 | YELL RR AXLE SUPPORT BOOST 148mm SELF ADJUST |

MAVIC Crossmax Elite 29

DELIVERED WITH

| | |
|-------------------------------------------------------------------------------------------|-----------------------------------------------------------------------------------|
| 1 bottle of Mavic Sealant (355 466 01) 1 |  |
| BR101 quick releases (M40350 firt, M40351 rear road, M40352 rear MTB) 1 |  |
| Front QR adapters (996 941 01 for MTB or B41 043 01 for road) 1 |  |
| Rear 12x142mm adapters for ITS4 and TS2 (308 593 01 for ITS4, 329 650 01 for TS2) 1 |  |
| UST valve and accessories (129 838 01) |  |
| UST valve and accessories (129 838 01) |  |
| Tubeless rim tape | |
| Tubeless rim tape | |

COMPATIBILITY

| | |
|-------------------------------------------------------------------------------------|--|
| Freewheel: Shimano/Sram or XD | |
| Freewheel: Shimano/Sram, convertible to XD with optional driver body | |
| Front axle: convertible from 15mm thru axle to Quick Release with included adapters | |
| Front axle: convertible from 15mm thru axle to Quick Release with included adapters | |
| Rear axle: 12mm thru axle, convertible to Quick Release with optional adapters | |

Specifications

RIMS

- **Material** : Mactal
 - **Material** : Mactal
 - **Joint** : SUP
 - **Joint** : SUP
 - **Drilling** : traditional
 - **Drilling** : traditional
 - **Weight reduction** : ISM 4D
 - **Weight reduction** : ISM 4D
 - **Valve hole diameter** : 6.5 mm
 - **Valve hole diameter** : 6.5 mm
 - **Tire** : UST Tubeless and tubetype
 - **Tire** : UST Tubeless and tubetype
 - **Internal width** : 22 mm
 - **Internal width** : 22 mm
 - **ETRTO size 27.5"** : 584x22ss
 - **ETRTO size 27.5"** : 584x22ss
 - **ETRTO size 29"** : 622x22ss
 - **ETRTO size 29"** : 622x22ss
- Hookless profile
Hookless profile
Use with Mavic Tubeless Tape
Use with Mavic Tubeless Tape

SPOKES

- **Material** : steel
- **Material** : steel
- **Shape** : straight pull, bladed, double butted
- **Shape** : straight pull, bladed, double butted
- **Count** : 24 front and rear
- **Count** : 24 front and rear
- **Lacing** : front and rear crossed 2
- **Lacing** : front and rear crossed 2

WHEEL HUB

- **Front and rear bodies** : aluminum
 - **Front and rear bodies** : aluminum
 - **Axle material** : aluminum
 - **Axle material** : aluminum
- Sealed cartridge bearings
Sealed cartridge bearings
- **Freewheel** : ITS-4 alloy
 - **Freewheel** : ITS-4 alloy

VERSIONS

- **Color** : Black or Black/Red
 - **Color** : Black or Black/Red
 - **Disc standard** : 6 Bolts only
 - **Disc standard** : 6 Bolts only
 - **Hub width** : Boost (front 110, rear 148) or Non-Boost (front 100, rear 135/142)
 - **Hub width** : Boost (front 110, rear 148) or Non-Boost (front 100, rear 135/142)
- Lefty Supermax
Lefty Supermax

WHEEL WEIGHTS

- Wheel weight
- Weight Rear 27.5": 885
- Weight Rear 29": 930