

ASTM CATEGORY 4 : ENDURO AND TRAIL RIDING

For a longer longevity of the wheel, Mavic recommends that the total weight supported by the wheels don't exceed 120kg, bike included

Recommended tyre sizes: 44 to 76 mm (1.75" to 3.0") rear and 50 to 76 mm (2.0" to 3.0") front

REFERENCES WHEELS

| | | | |
|--------|---------------------------|--------|-----------------------|
| F80411 | Deemax Pro 18 27,5 Ft Bst | F80401 | Deemax Pro 18 27,5 Ft |
|--------|---------------------------|--------|-----------------------|

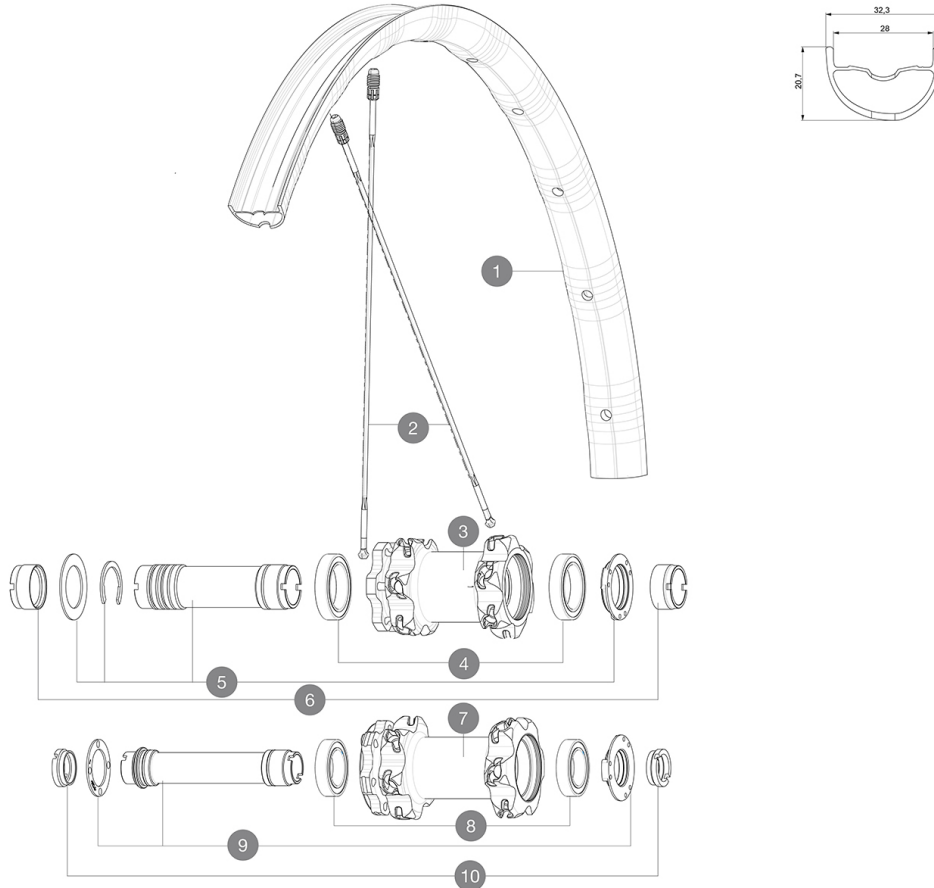

RIMS



&NBSP;

| | | |
|---|----------|---|
| 1 | V2319210 | KIT FRONT RIM E-DEEMAX/DEEMAX PRO 27,5" |
|---|----------|---|

SPOKES

| | | |
|---|----------|--|
| 2 | V2386101 | KIT 1 FRT/1 NDS STAMPED SPOKES 275mm DEEMAX PRO - while stoc |
| 2 | 36674901 | KIT 12 FT XMAX END/FT-NDS DEEMAX PRO 27,5" ALU SPK 275mm |

HUB SHELLS

| | | |
|---|----------|---|
| 3 | N/A | HUB BODY |
| 4 | M40179 | FRONT HUB BEARING KIT 20mm AXLE |
| 5 | 30870501 | FRONT AXLE 20mm CROSSMAX + DEEMAX ULTI 2012 |
| 7 | N/A | HUB BODY |
| 8 | 99688501 | BEARING KIT 9/12/15 D6T HUB 20x32x7 6804 |
| 9 | V2370701 | KIT FRONT QRM+ AXLE BOOST INTL 110mm |

OPTIONS

| | |
|----------|--|
| V2650201 | ADAPTER Front Torque Cap 15x31 MTB QRM + |
|----------|--|

ADAPTERS

| | | |
|----|----------|-------------------------------|
| 6 | 12982901 | ADAPTER Ft 20x110mm |
| 10 | B4104401 | ADAPTER Ft 15mm QRM+ |
| | B4104301 | ADAPTER Ft 9mm QR QRM+ |
| | 12982701 | ADAPTER Ft 20 to 9mm QR incl. |
| | 12982801 | ADAPTER Ft 20 to 15mm |

MAVIC *Deemax Pro***DELIVERED WITH**

| | |
|---|--|
| Front 15 mm adapters (129 828 01) | |
| UST valve and accessories (129 838 01) | |
| Multifonction adjustment wrench (325 423 01) | |
| User guide | |

COMPATIBILITY

| | |
|--|--|
| Freewheel: Shimano/Sram or XD | |
| Front axle: 20mm, convertible to 15mm thru axle with included adapters | |
| Rear axle: 12mm thru axle, convertible to Quick Release with optional adapters | |

Specifications**RIMS**

- **Material** : Mactal
 - **Drilling** : Fore
 - **Weight reduction** : ISM 4D
 - **Valve hole diameter** : 6.5 mm
 - **Tyre** : UST Tubeless and tubetype
 - **Internal width** : 28 mm front and 25mm rear
 - **ETRTO size 27.5"** : 584x28TSS front & 584x25TSS rear
- Hookless profile

SPOKES

- **Material** : Zicral
- **Shape** : straight pull, bladed
- **Nipples** : Fore integrated aluminum
- **Count** : 24 front and rear
- **Lacing** : front crossed 2, rear Isopulse

WHEEL HUB

- **Front and rear bodies** : aluminum
- Adjustable sealed cartridge bearings (QRM+)
- **Freewheel** : ITS-4 alloy

VERSIONS

- **Color** : Black only
- **Disc standard** : 6 Bolts only
- **Hub width** : Boost (front 110, rear 148) or Non-Boost (front 100, rear 135/142)

WHEEL WEIGHTS

810